



Aspen Close, Staines-upon-Thames, Surrey, TW18 4SW

SPACIOUS ONE BEDROOM FREEHOLD HOUSE SITUATED WITHIN MUCH SOUGHT AFTER PRIVATE CLOSE IDEALLY LOCATED WITHIN MOMENTS OF STAINES TOWN CENTRE & MAINLINE TRAIN STATION. The property benefits from a spacious lounge/diner, fitted kitchen, large double bedroom, modern white bathroom suite, garden to front and allocated parking. No Onward Chain. Viewings Highly Recommended!

ROOM DESCRIPTIONS

FLOORPLAN

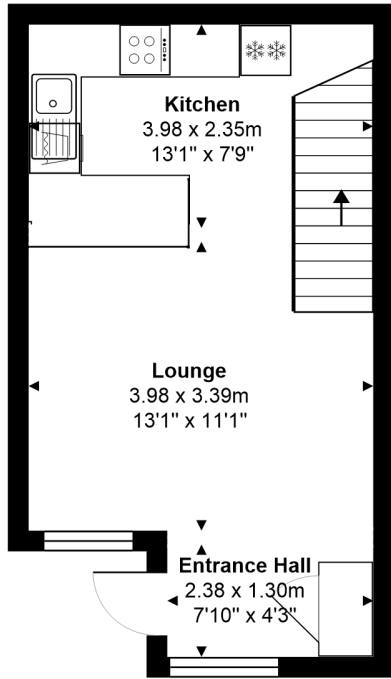

Ground Floor

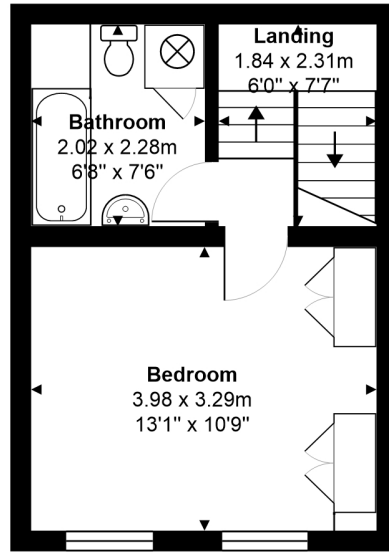

First Floor

Total Area: 50.0 m² ... 538 ft²

All measurements are approximate and for display purposes only.