

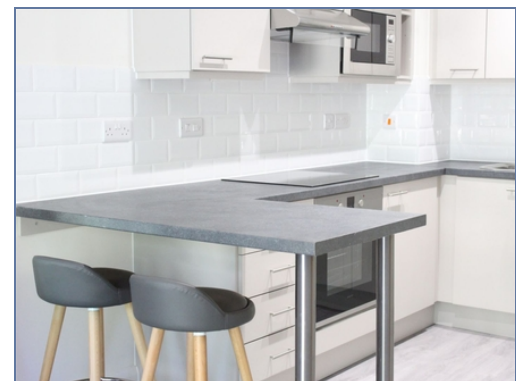

**81 Waterside House, Woodley Headland,
Peartree Bridge, MILTON KEYNES,
Buckinghamshire, MK6 3FE**

£885 pcm Freehold

- Furnished apartment
- Waterfront Location
- Allocated Parking
- Excellent Views
- SPACIOUS ROOMS
- Good Access to A5 and M1
- Call Now!
- One bedroom apartment
- EPC Rating B





Disclaimer

Whilst we have endeavoured to prepare our sales particulars accurately none of the services, appliances or equipment have been tested. A buyer should satisfy themselves on such matters prior to purchase. Any measurements or distances mentioned in these particulars are for guide reference only. If such particulars are fundamental to a purchase, buyers should rely on their own enquiries. All enquiries should be directed to Elevation Estate Agents in the first instance.

| Energy Efficiency Rating | | Environmental Impact (CO ₂) Rating | |
|--|-----------|--|-----------|
| Current | Potential | Current | Potential |
| | | | |
| | 82 | 86 | 86 |
| <small>Very energy efficient - lower running costs</small> <small>Not energy efficient - higher running costs</small> | | <small>Very environmentally friendly - lower CO₂ emissions</small> <small>Not environmentally friendly - higher CO₂ emissions</small> | |
| <small>EU Directive 2002/91/EC</small> | | <small>EU Directive 2002/91/EC</small> | |

elevation
lettings



Ground Floor

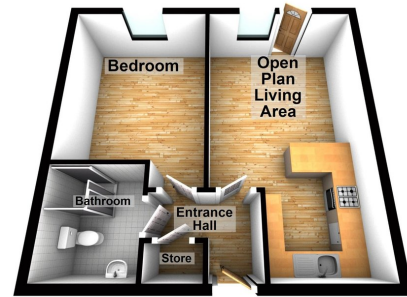

Floor plans are for layout purposes only
Plan produced using PlanUp.