

# Crane & Co



## Price Guide

£170,000 - £185,000

Flat 2 James Court, James Avenue, Herstmonceux, East Sussex BN27 4PA

 1 Bedroom  1 Bathroom  1 Reception

 01323 440678

 [sales@craneandco.co.uk](mailto:sales@craneandco.co.uk)

# Flat 2 James Court, James Avenue, Herstmonceux, East Sussex BN27 4PA

Price Guide  
£170,000 - £185,000  
Leasehold

 1 Bedroom  1 Bathroom  1 Reception

PRICE GUIDE £170,000 - £185,000

WATCH THE FILM AND 3D TOUR and view EXPERT PHOTOGRAPHY at [craneandco.co.uk](http://craneandco.co.uk) (ALL PROVIDED FREE FOR ALL OUR SELLERS)

Ground floor, a village location, in great condition, a residential road and private entrance... what's not to like with this lovely purpose built apartment? Want to live in a lovely Sussex Village at a VERY AFFORDABLE price? Then - GET YOUR SKATES ON! Properties like this just don't turn up very often. A village home, in lovely redecorated condition, bright and airy, genuinely spacious and a large double bedroom, modern kitchen and bathroom. There's private residents parking. Village shops, restaurants, village pub, countryside and beautiful walks are all close at hand. This ground floor apartment enjoys a very pleasant aspect and is located along a very desirable residential road of bungalows and houses.

\* Annual Service Charge £2000

\* 124 Years Remaining on Lease

\* Information Provided by Seller

## Main Features

- Ground Floor Apartment
- 1 Bedroom
- Private Entrance
- Modern Kitchen
- Modern Bathroom
- Residents Off Road Parking
- Village Location
- Spacious Accommodation

## Room Sizes

Private Entrance  
Entrance Hall  
Living/Dining Room - 23'1 x 9'4  
Kitchen - 9' 8" x 7' 7"  
Bedroom - 11' 9" x 9' 7"  
Bathroom  
Outside  
Residents Off Road Parking

Flat 2 James Court, James Avenue, Herstmonceux, East Sussex  
BN27 4PA

Crane & Co

 01323 440678  [sales@craneandco.co.uk](mailto:sales@craneandco.co.uk)  [craneandco.co.uk](http://craneandco.co.uk)

Flat 2 James Court, James Avenue, Herstmonceux, East  
Sussex BN27 4PA

Price Guide  
£170,000 - £185,000  
Leasehold

1 Bedroom 1 Bathroom 1 Reception

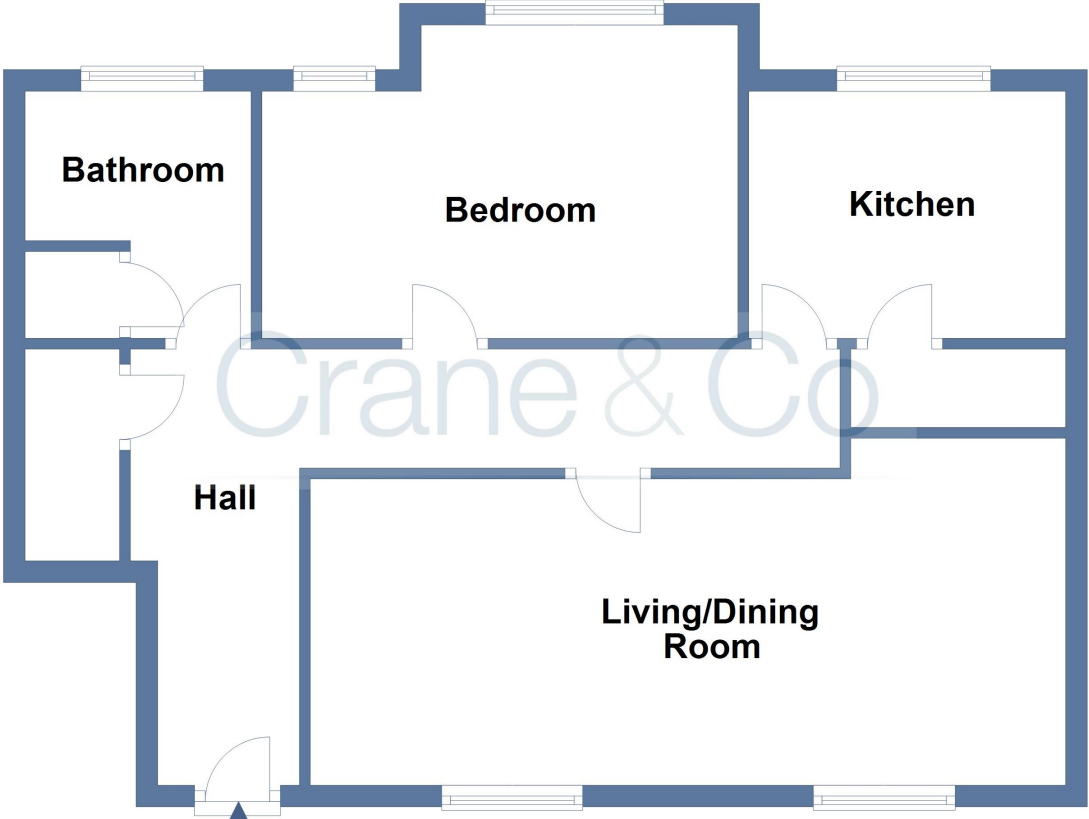

Flat 2 James Court, James Avenue, Herstmonceux, East Sussex  
BN27 4PA

Crane & Co

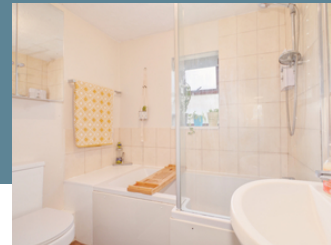

Flat 2 James Court, James Avenue, Herstmonceux, East Sussex

BN27 4PA

Crane & Co

☎ 01323 440678 ✉ sales@craneandco.co.uk 🌐 craneandco.co.uk



Flat 2 James Court, James Avenue, Herstmonceux, East Sussex

BN27 4PA

Crane & Co

📞 01323 440678 ✉ sales@craneandco.co.uk 🌐 craneandco.co.uk

# Flat 2 James Court, James Avenue, Herstmonceux, East Sussex BN27 4PA

 1 Bedroom
  1 Bathroom
  1 Reception

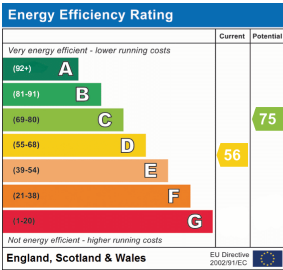
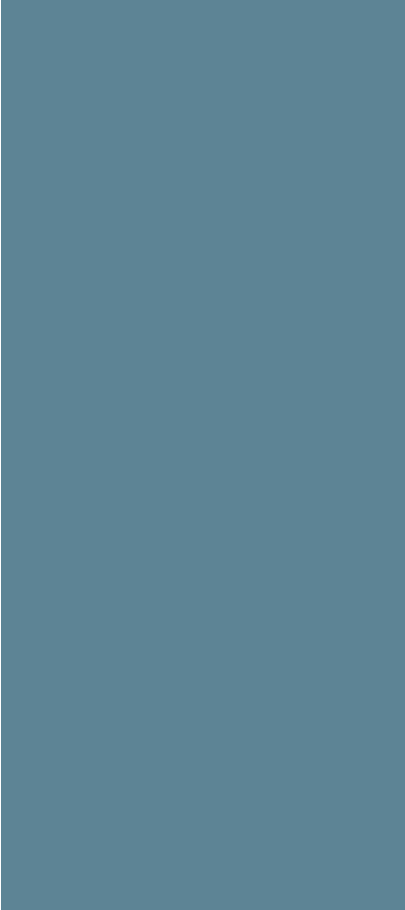
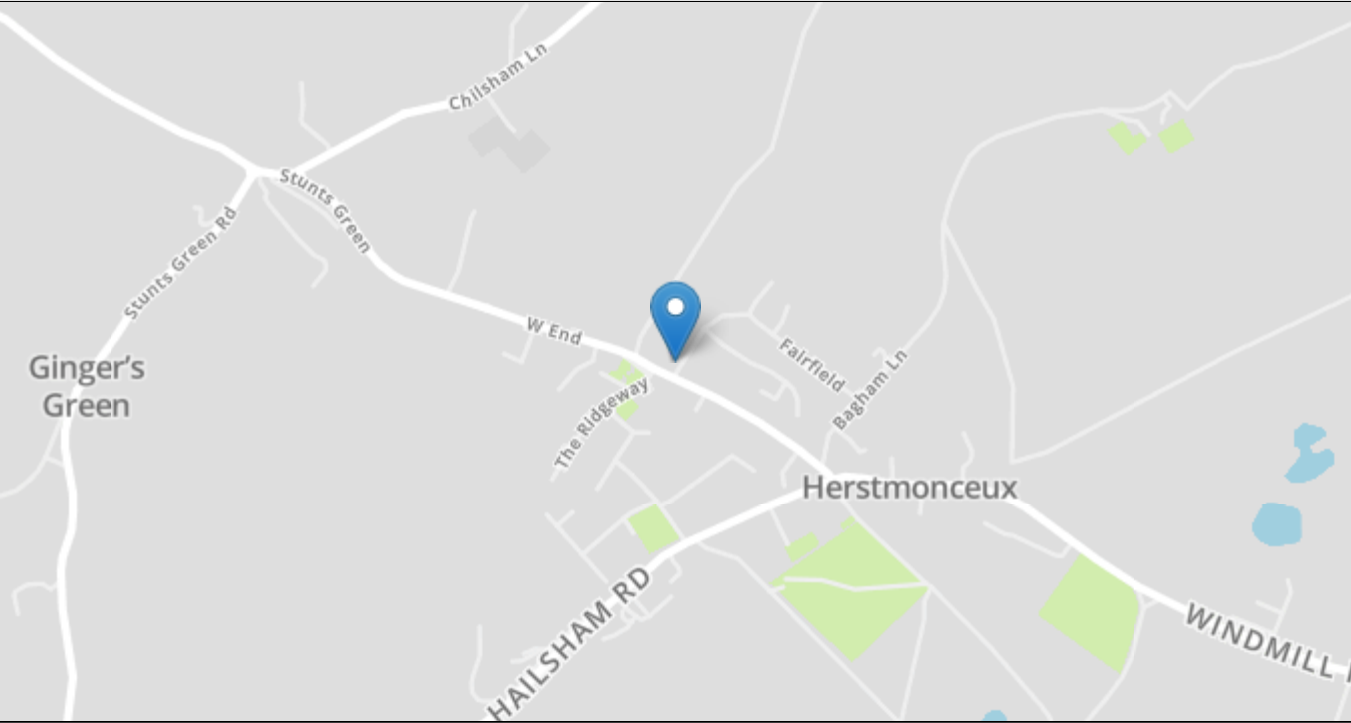

## Price Guide

£170,000 - £185,000

Leasehold



Sales particulars are intended only as general guidance. The Company therefore gives notice that none of the material issued or visual depictions of any kind made on behalf of the Company can be relied upon as accurately describing any of the Specified Matters prescribed by any Order made under the Property Misdescriptions Act 1991. Nor do they constitute a contract, part of a contract or a warranty. You should obtain clarification on any matters or information that are important to you.