



## Queen Street

Saxon Court | Hitchin | Hertfordshire | SG4 9TB

[www.stonegate-estates.co.uk](http://www.stonegate-estates.co.uk)



# QUEEN STREET

---

## Property Description

We are delighted to offer this rarely available, well presented two bed retirement property in the popular Saxon Court development within the heart of Hitchin town centre.

Situated within easy walking distance of the local shops the apartment is offered with no chain along with a fitted kitchen, built in wardrobe to master bedroom and a large storage cupboard in the hallway. The second bedroom is ideal as a dining room, study or guest room.

For peace of mind, there is a 24hr Careline system throughout the property. Communal lounge and laundry rooms. Guest suite for visitors and parking on site. Short walking distance to the town centre. Please note buyers must be aged 60 plus.

Hitchin town provides a broad range of shops and a regular traditional market, together with a good selection of restaurants, bars and pubs within its historic centre. The town also provides a swimming centre, theatres and a library, whilst the commuter is served by the main line railway station (Kings Cross - 30 minutes) and direct links to the A1(M).

**£275,000 Leasehold**



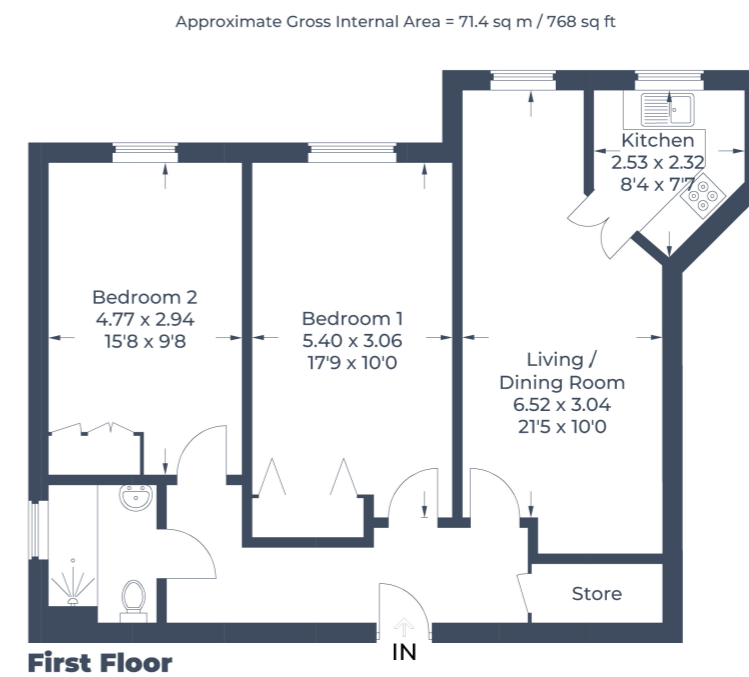

Illustration for identification purposes only, measurements are approximate, not to scale.  
 © CJ Property Marketing Produced for Stonegate Estates



- Two Bedroom Retirement Apartment
- Town Centre Location
- Residence Lounge
- Communal Gardens
- No Chain
- Fitted Kitchen
- Development Manager on Site
- Lift to all Floors

EPC Rating: C

Stonegate Estate Agents

01462 438979

[sales@stonegate-estates.co.uk](mailto:sales@stonegate-estates.co.uk) | [www.stonegate-estates.co.uk](http://www.stonegate-estates.co.uk)

