



Day & Co
ESTATE AGENTS

28 Cavendish Street

Keighley

BD21 3RG



39a Oakmoor Avenue, Long Lee,
Keighley, West Yorkshire, BD21
4FL

£190,000

T: 01535 664609

W: www.dayandcoestateagents.co.uk

E: keighley@dayandcoestateagents.co.uk

- SEMI-DETACHED HOUSE
 - DISTANT VIEWS TO REAR
 - DRIVEWAY
- THREE BEDROOMS
 - PLEASANT REAR GARDEN
 - EPC RATING B

SUMMARY

** MODERN SEMI-DETACHED HOUSE, DISTANT VIEWS TO THE REAR, PLEASANT GARDENS, DRIVEWAY TO SIDE, THREE BEDROOMS, DINING KITCHEN, DOWNSTAIRS CLOAKS/W.C., EPC RATING B **

FULL DESCRIPTION

A modern Three Bedroom semi-detached house situated in the popular area of Long Lee. This property has a pleasant enclosed rear garden with shed and enjoys distant views to the rear. The accommodation briefly comprising of an Entrance Hallway, Downstairs W.c. with toilet and wash basin. Living room, Dining Kitchen with a modern range of fitted wall and base units, window and French Doors to the rear. First Floor - Landing, Three Bedrooms, House Bathroom comprising of a bath with screen and shower over, w.c., wash basin. Gas Central Heating & Double Glazing. Outside - Front Garden, Driveway for off Road Parking, Enclosed garden to the rear with patio and shed. EPC Rating B

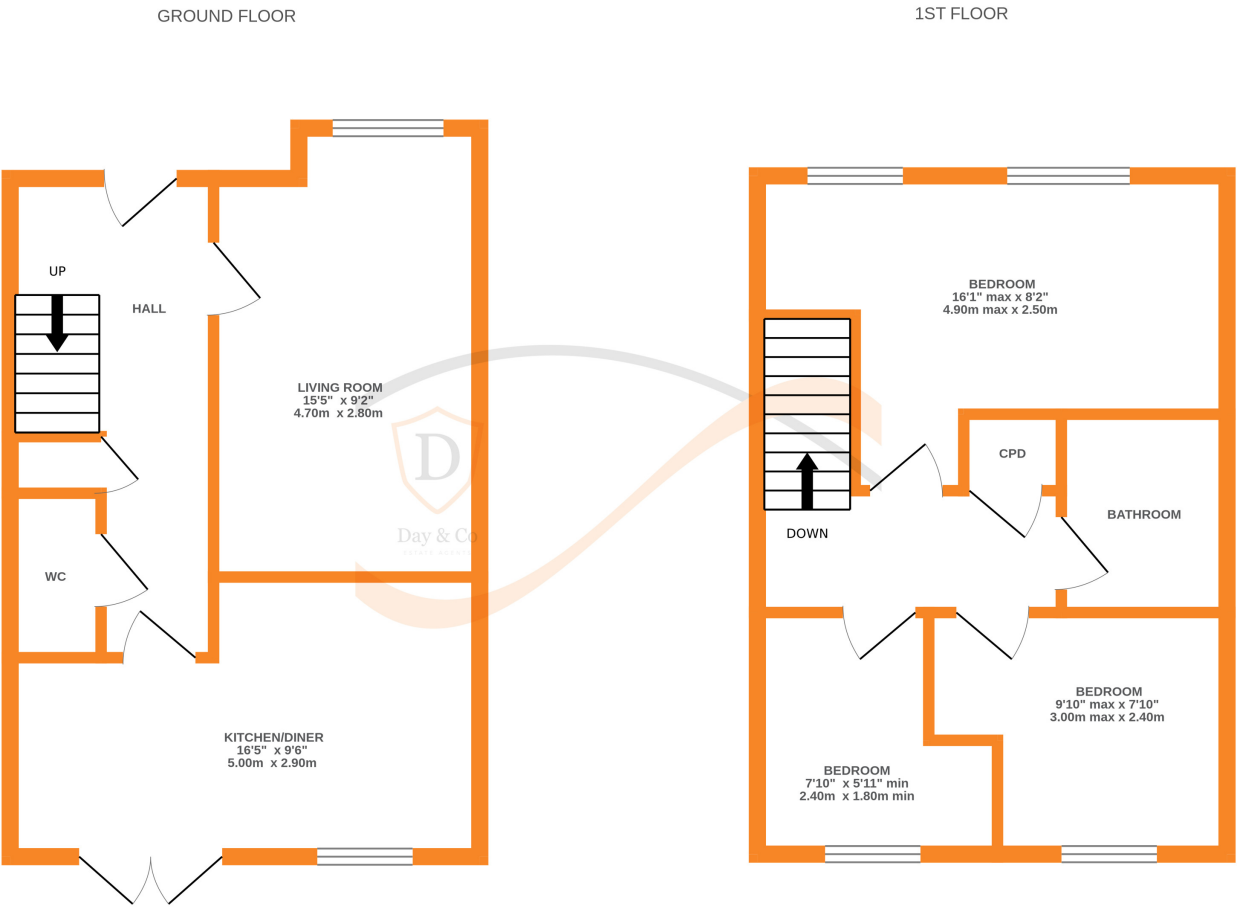

Whilst every attempt has been made to ensure the accuracy of the floorplan contained here, measurements of doors, windows, rooms and any other items are approximate and no responsibility is taken for any error, omission or mis-statement. This plan is for illustrative purposes only and should be used as such by any prospective purchaser. The services, systems and appliances shown have not been tested and no guarantee as to their operability or efficiency can be given.
Made with Metropix ©2025