



9 Whittle Court,  
Knowlhill, Milton Keynes, MK5 8FT

Tel: 01908 231 551   
mail@elevationstateagents.com



**12 Chetwode Avenue, Monkston, Milton  
Keynes, Buckinghamshire, MK10 9EJ**

**£330,000 Freehold**

- Three bedrooms
- Terraced property
- POPULAR LOCATION
- Lounge
- Kitchen Diner
- Part converted garage/storeroom
- Rear Garden
- Energy rating D
- EPC Rating



See our full selection of properties online at [www.elevationstateagents.com](http://www.elevationstateagents.com)



A three bedroom terrace property situated in the very popular Monkston development. The family home offers three good size bedrooms, first floor lounge, family bathroom, kitchen diner, garage and gardens. To arrange an early viewing call the elevation team.

## Ground Floor

### Entrance Hall

Leading to:

### Part Converted Garage/Store Room

### Kitchen Diner

12' 3" x 8' 9" (3.73m x 2.67m)

## FIRST FLOOR

### Master Bedroom

12' 4" x 8' 9" (3.76m x 2.67m)

### Lounge

15' 9" x 12' 4" (4.80m x 3.76m)

## SECOND FLOOR

### Bedroom Two

12' 4" x 10' 3" (3.76m x 3.12m)

### Bedroom Three

12' 3" x 8' 9" (3.73m x 2.67m)

### Family Bathroom

Fitted to comprise three piece suite

## EXTERIOR

### Rear Garden

### Driveway

## Disclaimer

Whilst we have endeavoured to prepare our sales particulars accurately none of the services, appliances or equipment have been tested. A buyer should satisfy themselves on such matters prior to purchase. Any measurements or distances mentioned in these particulars are for guide reference only. If such particulars are fundamental to a purchase, buyers should rely on their own enquiries. All enquiries should be directed to Elevation Estate Agents in the first instance.

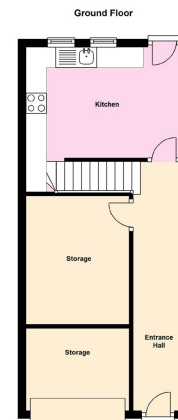

Floor Plans are for illustrative purposes only  
Plans produced using PlotSite