



Flat 1, 81 Station Road

Northwich CW9 5LT

£575

www.westates.co.uk

01606 331784



- Communal Entrance
- Open Plan Living Room
- Lounge & Kitchen Areas
- Double Bedroom
- Shower Room
- Allocated Parking
- Convenient Location
- Unfurnished

Description

A well-presented, one bedroom first floor apartment, which forms one of four similar properties housed within a large period house. The property is ideally located being very close to Northwich railway station and within walking distance of the town centre. With PVCu double glazing and electric heating, comprises: Communal lobby with stairs to first floor, open plan living room with lounge and kitchen areas, double bedroom and shower room. Outside there is a parking space to the rear. Available unfurnished, restrictions apply.



Location

NEW INSTRUCTION

Tenure**EPC Rating:****Important Notes**

Type Here

First Floor

Approx. 31.7 sq. metres (340.9 sq. feet)

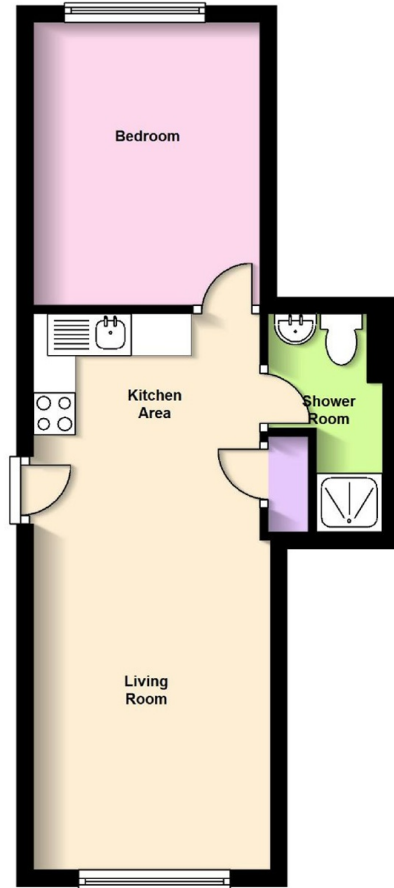

Total area: approx. 31.7 sq. metres (340.9 sq. feet)



Boomin

These particulars, whilst believed to be accurate are set out as a general outline only for guidance and do not constitute any part of an offer or contract. Intending purchasers should not rely on them as statements of representation of fact, but must satisfy themselves by inspection or otherwise as to their accuracy. All measurements quoted are approximate. We are unable to confirm the working order of any fixtures and fittings including appliances that are included in these particulars. No person in this firm's employment has the authority to make or give any representation or warranty in respect of the property.