



- Two Bedroom Apartment
- 40% Share With Option To Staircase Up
- Refitted Bathroom
- New Gas Combi Boiler
- Allocated Parking Space
- Short Walk To Town & Station
- Complete Onward Chain
- Lounge/Diner
- Ample Storage Space
- UPVC Windows

115 Malyon Close, Braintree, Essex. CM7 2QZ.

Michaels Property Consultants are delighted to present to the market this rather unique opportunity to purchase this two bedroom apartment on a 40% shared ownership basis with the option to staircase up in the future. New to the market and offered for sale with a complete onward chain, we feel this ideal starter home presents a more affordable option for first time buyers looking to get onto the property ladder.



Property Details.

Entrance Hall



Kitchen



11' 6" x 7' 8" Max (3.51 m x 2.34m)

Lounge/Diner



Bedroom One



11' 6" x 10' 0" (3.51m x 3.05m)



15' 2" x 13' 6" Max (4.62m x 4.11m)

Property Details.

Bedroom Two



11' 2" x 7' 8" (3.40m x 2.34m)

Bathroom



One Allocated Parking Space

Property Details.

Floorplans

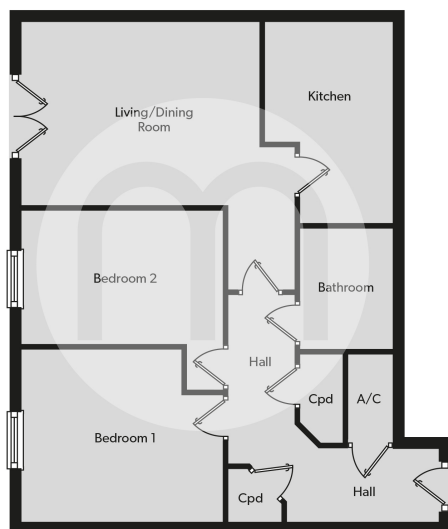

Location

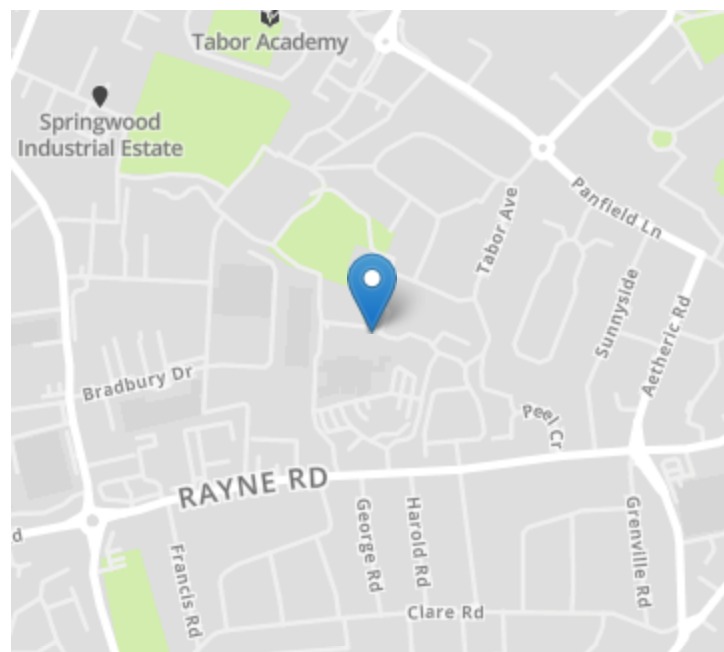

Energy Ratings

We have not carried out a structural survey and the services, appliances and specific fittings have not been tested. All photographs, measurements, floor plans and distances referred to are given as a guide only and should not be relied upon for the purchase of carpets or any other fixtures or fittings. Gardens, roof terraces, balconies and communal gardens as well as tenure and lease details cannot have their accuracy guaranteed for intending purchasers. Lease details, service ground rent (where applicable) are given as a guide only and should be checked and confirmed by your solicitor prior to exchange of contracts.