

Northfield Avenue, London, W13

Approximate Floor Area = 66.6 sq m / 718 sq ft

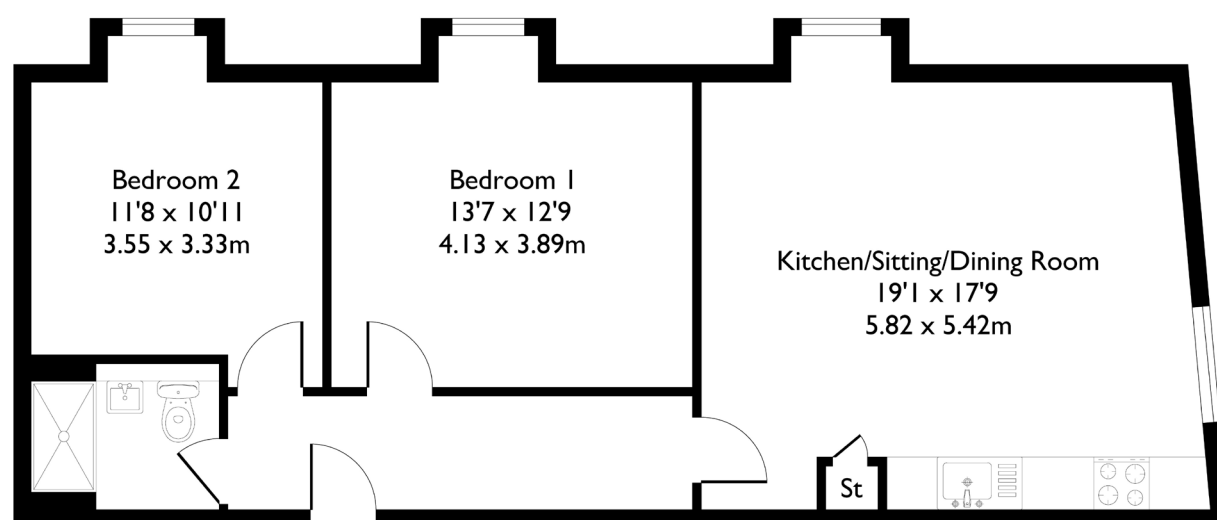

Top Floor



2 BEDROOM FLAT

Northfield Avenue, W13

£475,000

Welcome to this beautifully presented two double-bedroom top floor flat, featuring a bright open-plan kitchen and living space, along with a modern bathroom.

The property opens into a wide entrance hallway, offering a sense of space as soon as you walk in. With plenty of natural light and excellent storage throughout, this home combines practicality with comfort. The flat itself boasts generously sized rooms, a peaceful setting, and attractive views, all within a highly desirable location. Just 30 seconds from Northfields Station (Piccadilly Line) and bus stops, it also benefits from being only 120m from Lammas Park, with local shops and cafes right on the doorstep – including a much-loved coffee shop opposite, where beans are roasted on-site.

FEATURES

- Two Double Bedrooms
- One Bathroom
- Open Plan Kitchen/Living
- Northfields Station
- Northfields Amenities
- Bus stops Closeby
- Solar Panels
- Fully Furnished
- EPC Rating C



2 BEDROOM FLAT

Northfield Avenue, W13

There are a number of additional features that make this property stand out. Solar panels have been installed on the roof, with Flat 5 benefiting from four of the seven, reflecting its position as the largest flat in the building.

The front door to the flat is fitted with a secure Banhams deadlock, providing extra peace of mind. The building is professionally managed by Highstar, who are currently obtaining quotes for the repair of the street façade.

The flat is available fully furnished and equipped, ready to let or move straight into. It has also been thoroughly cleaned, ensuring a smooth and fresh start for its new owners. With its light-filled interiors, thoughtful upgrades, and unbeatable location next to amenities and transport, this flat offers a superb opportunity for both homeowners and investors alike. EPC Rating C.

