

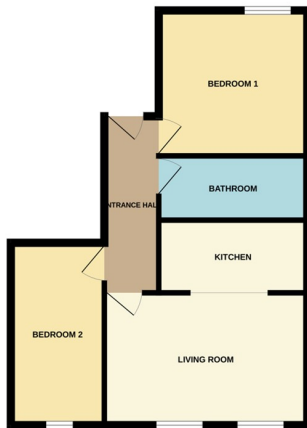

Cecil Pacey Court, Peterborough PE1 3NJ

£110,000



*** NO ONWARD CHAIN *** " Ideal as a first time buy or investment opportunity, this 2 bedroom, first floor flat is ready to move straight into. In the property, you will find an living area, kitchen, 2 bedrooms and bathroom. To the rear, there is communal parking. Council Tax Band - A / EPC Energy Rating - B "

ENTRANCE

Door to front.

KITCHEN

5' 2" x 10' 7" (1.57m x 3.23m) (approx) Fitted with a range of base units with work surfaces over, stainless steel sink unit with mixer tap, integrated oven and hob.

LIVING ROOM

9' 6" x 14' 6" (2.90m x 4.42m) (approx) Two windows to front.

BEDROOM ONE

10' 5" x 10' 6" (3.17m x 3.20m) (approx) Window to rear.

BEDROOM TWO

6' 8" x 13' 0" (2.03m x 3.96m) (approx) Window to front.

BATHROOM

4' 7" x 10' 5" (1.40m x 3.17m) (approx) Fitted with a three piece suite comprising low level W/C, wash hand basin, bath with shower over, cupboard with hot water tank enclosed.

OUTSIDE

Communal parking.

AGENT NOTES

The lease details are 125 years from the 29th September 1991, therefore leaving 90 years remaining.

The service charge is £110.25 per year.

The ground rent is £50 per year.

AGENT NOTES

The floorplan is for illustrative purposes only. Fixtures and fittings do not represent the current state of the property. Not to scale and is meant as a guide only.

