



One Bedroom Studio Flat
Victoria Street, Gillingham, Kent, ME7 1EW

Guide Price £100,000
Leasehold

Victoria Street, Gillingham, Kent, ME7 1EW

Guide Price £100,000

Leasehold

Description

** Guide Price £100,000 - £120,000 ** This well-located investment opportunity or first-time purchase is bound to be popular. Located in the town centre, with great access to transport links and local amenities, this ground floor studio apartment offers spacious accommodation, separate kitchen, bathroom, and access to the communal gardens. Gillingham train station is a short walk away from the property along with Gillingham High street consisting of local shops and cafes. This won't be around for long so call the Greyfox sales team in Rainham to arrange your viewing now!

NOTE - The term of the Lease is 125 years from 12/12/2017.

Key Features

- Ground Floor Studio Apartment
- Offered With No Onward Chain
- Potential First Time Purchase or Investment Opportunity
- Separate Kitchen
- Spacious Bathroom
- Popular Town Centre Location
- Communal Garden
- Leasehold – 125 years 12/12/2017

Local Area

Gillingham is located within the Medway towns and offers railway links to central London and Ebbsfleet International and road connections to the A2/M2, M25 and M20. In addition to its town centre Gillingham offers a host of amenities including ice skating, country parks, an outdoor pool, a golf course, Medway Park Sports Centre and more.

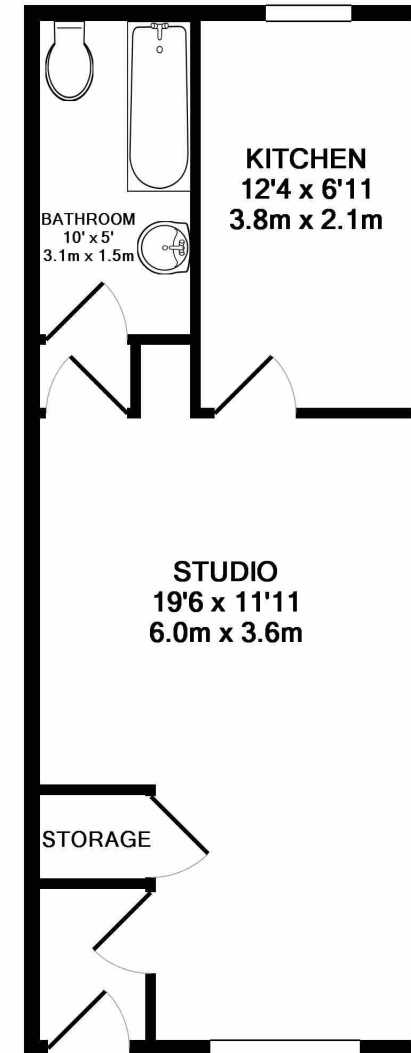

TOTAL APPROX. FLOOR AREA 379 SQ.FT. (35.2 SQ.M.)
Measurements are approximate. Not to scale. Illustrative purposes only
Made with Metropix ©2018



Property Location

Victoria Street, Gillingham, Kent, ME7 1EW

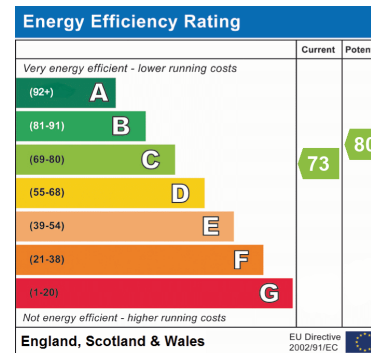
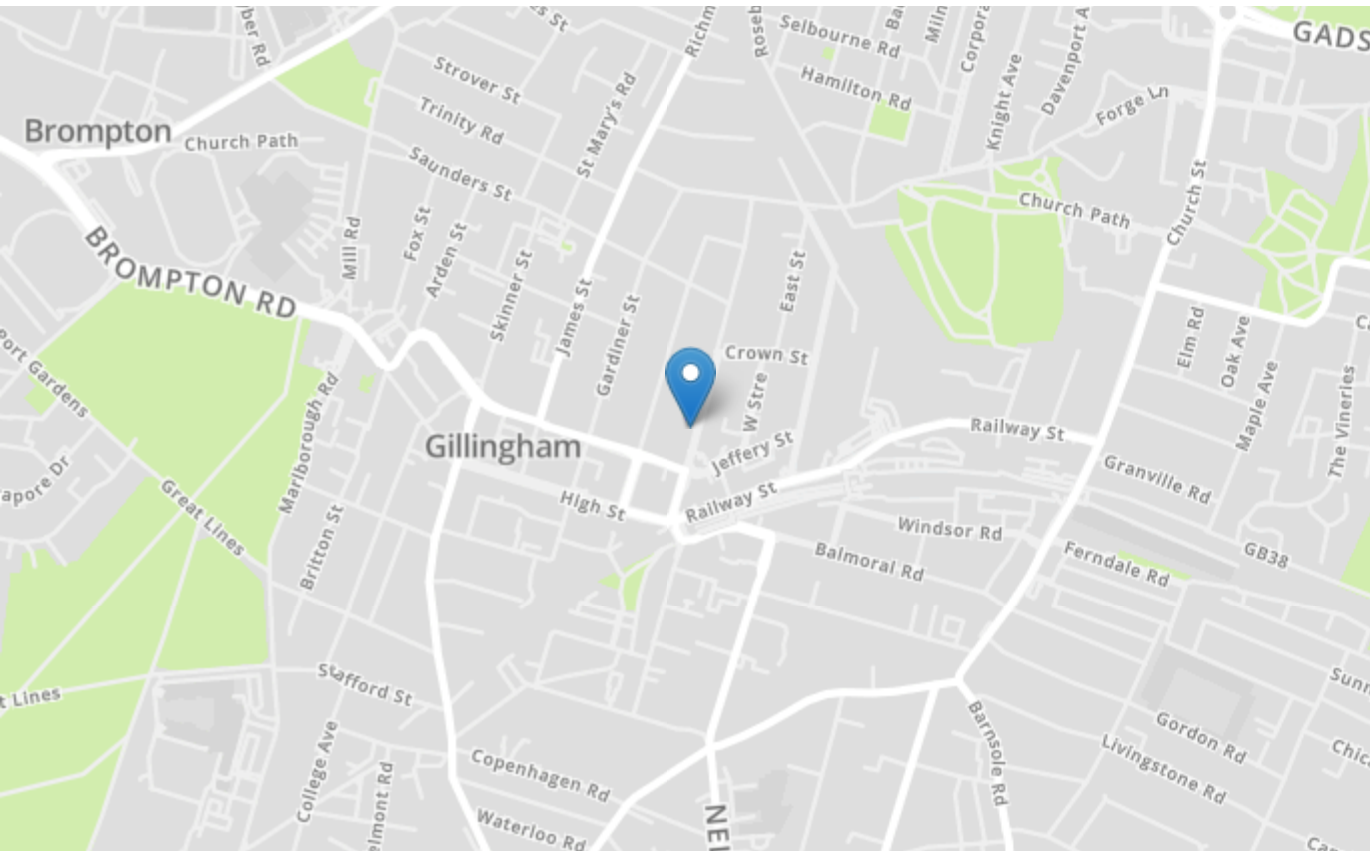

Tenure	Leasehold
Lease Term	125 years from 12/12/2017
Ground Rent	£25.00 PA
Service Charge	£850.00 PA
Local Authority	Medway
Council Tax	Band A

Greyfox Walderslade
 Unit 2, Thetford House
 Walderslade Village Centre
 Walderslade Road
 Chatham
 Kent
 ME5 9LR
 Tel: 01634 672227 Email:
 walderslade@greyfox.co.uk

Greyfox Rainham
 67C High Street
 Rainham
 Kent
 ME8 7HS
 Tel: 01634 377737 Email:
 rainham@greyfox.co.uk

Agent Notes

These particulars are prepared as a general guide to a broad description of the property and should not be relied upon as a statement or representation of fact and do not constitute part of an offer or contract. The seller does not make or give nor do our employees or Greyfox have authority to make or give any representation or warranty to the property. We have not carried out a structural survey and the services, appliances and specific fittings have not been tested. All photographs, measurements, floorplans and distances referred to are given as a guide only and should not be relied upon for the purchase of carpets or any other fixtures or fittings. Lease details, service charges and ground rent (where applicable) and council tax are given as a guide only and should be checked and confirmed by you on inspection and your solicitor prior to exchange of contracts. If there are any points of particular importance to you we will be pleased to check the information for you and to confirm that the property remains available. This is particularly important should you be travelling some distance to view and where statements have been made by us to the effect that the information has not been verified. The copyright of all details, photographs and floorplans remain exclusive to Greyfox. For details of our privacy policy and referral fee arrangements with any of our selected partner companies please visit <https://www.greyfox.co.uk/legal/privacy> and <https://www.greyfox.co.uk/referral-fees>.