



11 Wallberry Mews, Douglas, Isle of Man. IM2 2ND

Fantastic mid-terraced mews house in a great location within Braddan. With two good sized bedrooms, bright and sunny lounge/dining. Close to schools and amenities perfect for families.



£255,000 Freehold

PROPERTY DESCRIPTION

ACCOMODATION Situated at 11 Wallberry Mews in Braddan, this modern mid-terraced mews home offers an excellent opportunity for first-time buyers or investors, thanks to its prime location near schools, shops, and local park. The property features a well-sized lounge/dining room, providing a comfortable space for relaxation and dining, alongside a functional kitchen designed for everyday convenience. Both bedrooms are generously sized and come with fitted wardrobes, maximizing storage and enhancing the home's practicality. The modern shower room is sleek and well-appointed. With all modern uPVC double-glazed windows and front and back doors, the home is energy-efficient and low-maintenance. The rear garden has been thoughtfully landscaped with stone slabs and raised planters, creating a stylish and easy-to-care-for outdoor space perfect for enjoying sunny days or entertaining guests.

INCLUSIONS Light Fittings, Blinds, Most Curtains, Sound system in Lounge.

DISCLAIMER Whilst Manxmove Ltd believe that these details are correct, neither Manxmove Ltd or their clients guarantee their accuracy in any way. Consequently, these details are not to be used to form part of any legally binding contract. Prospective purchasers or tenants are advised to visit this property to satisfy themselves as to the correctness of these details. Please note, we use wide angle camera lenses in order to show as much of each room as possible. This is not intended to mislead any prospective purchasers or tenants in any way and an honest verbal description is always available prior to viewing if required

FEATURES

- Mid-Terraced Mews House
- Sunny Lounge/Dining
- Two Double Bedrooms
- Modern Shower Room
- uPVC Double Glazed Throughout
- Perfect for First Time Buyers or Investors
- Communal Parking
- Gas Fired Central Heating



Property Images



FLOORPLAN

GROUND FLOOR
347 sq.ft. (32.2 sq.m.) approx.

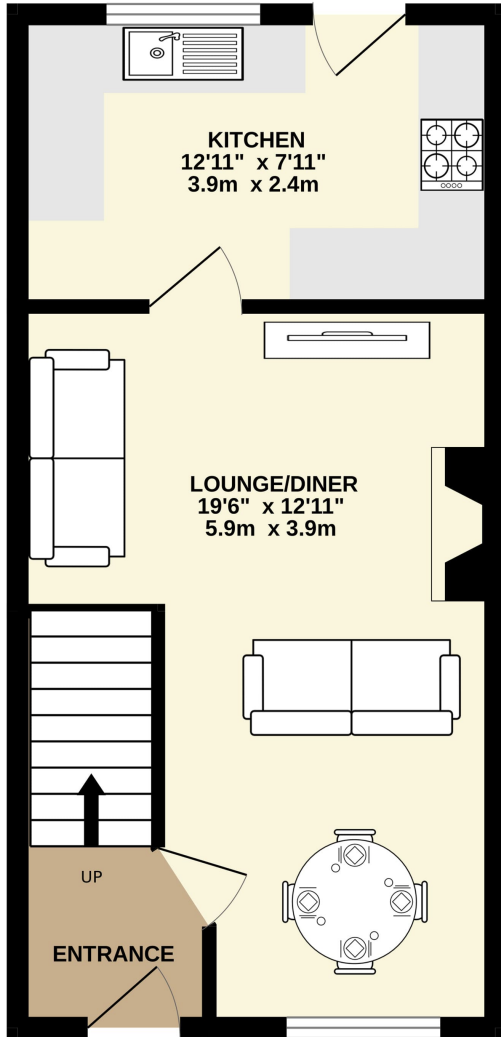

1ST FLOOR
352 sq.ft. (32.7 sq.m.) approx.

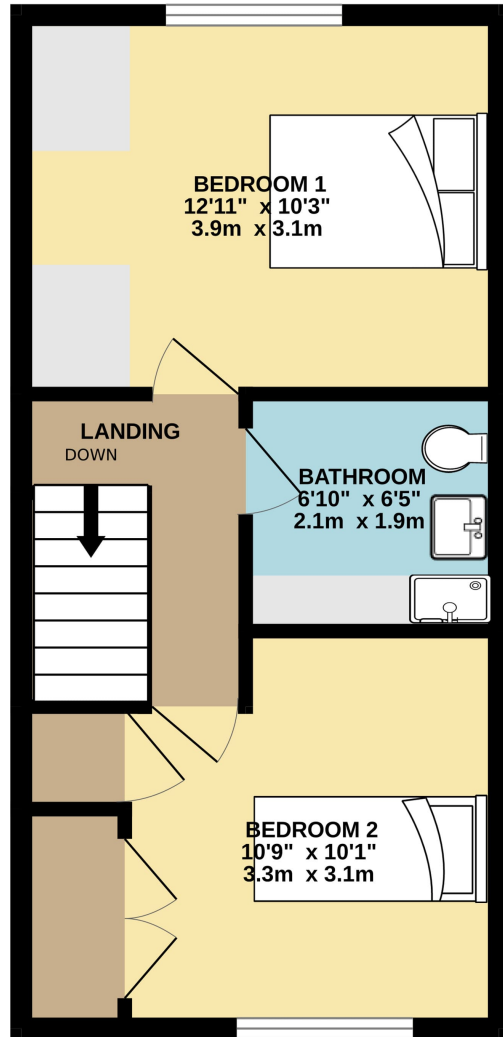

TOTAL FLOOR AREA : 699 sq.ft. (64.9 sq.m.) approx.

Whilst every attempt has been made to ensure the accuracy of the floorplan contained here, measurements of doors, windows, rooms and any other items are approximate and no responsibility is taken for any error, omission or mis-statement. This plan is for illustrative purposes only and should be used as such by any prospective purchaser. The services, systems and appliances shown have not been tested and no guarantee as to their operability or efficiency can be given.
Made with Metropix ©2024

DISCLAIMER: Whilst Manxmove Ltd believe that these details are correct, neither Manxmove Ltd or their clients guarantee their accuracy in any way. Consequently, these details are not to be used to form part of any legally binding contract. Prospective purchasers or tenants are advised to visit this property to satisfy themselves as to the correctness of these details. Please note, we use wide angle camera lenses in order to show as much of each room as possible. This is not intended to mislead any prospective purchasers or tenants in any way and an honest verbal description is always available prior to viewing if required.