



Day & Co  
ESTATE AGENTS

28 Cavendish Street  
Keighley  
BD21 3RG



8 Ogden Crescent, Denholme,  
Bradford, West Yorkshire, BD13  
4LB

£259,995

T: 01535 664609

W: [www.dayandcoestateagents.co.uk](http://www.dayandcoestateagents.co.uk)

E: [keighley@dayandcoestateagents.co.uk](mailto:keighley@dayandcoestateagents.co.uk)



- Superbly Presented Semi-Detached Family Home
- Block Paved Drive/Garage With Electric Doors
- Four Bedrooms & Master En Suite

- Modern Fitted Kitchen/Conservatory
- Popular Village of Denholme/Far Reaching Views
- EPC Rating D

## SUMMARY

**\*\*A SUPERBLY PRESENTED 4 BEDROOM (MASTER EN-SUITE) SEMI-DETACHED FAMILY HOME, GENEROUS SIZE PLOT WITH FAR REACHING VIEWS - POPULAR VILLAGE OF DENHOLME!!\*\*** Having a modern fitted kitchen, conservatory, block paved drive, garage with electric doors, generous size garden - OFFERED FOR SALE WITH NO ONWARD CHAIN!! EPC RATING D.

## FULL DESCRIPTION

An ideal purchase for the growing family is this well presented four bedroom (master en-suite) family home situated on a generous size plot in the popular village of Denholme with far reaching views. The well proportioned accommodation comprises of an entrance hall, the lounge has a double glazed window to the front, radiator and electric fire. The kitchen has an attractive range of modern base and wall mounted units, integrated appliances to include fridge, freezer, dishwasher, oven, hob, extractor fan and gives access to the conservatory which in turn has double glazed patio doors giving access to the rear garden. There is a double bedroom with double glazed window to the rear and radiator, bedroom five/snug is also on this level with double glazed window to the front and a radiator. The shower room completes the ground floor accommodation having a spa shower cubicle, wash hand basin, WC, under floor heating, two double glazed windows to the side. To the first floor there are two further bedrooms, the master having an en-suite shower room. A useful box room is also on this level. Externally the property has a front garden, block paved drive, garage (measuring 24'7" x 13'3") with electric doors, generous size rear garden with far reaching views. Offered for sale with no onward chain, EPC Rating D.

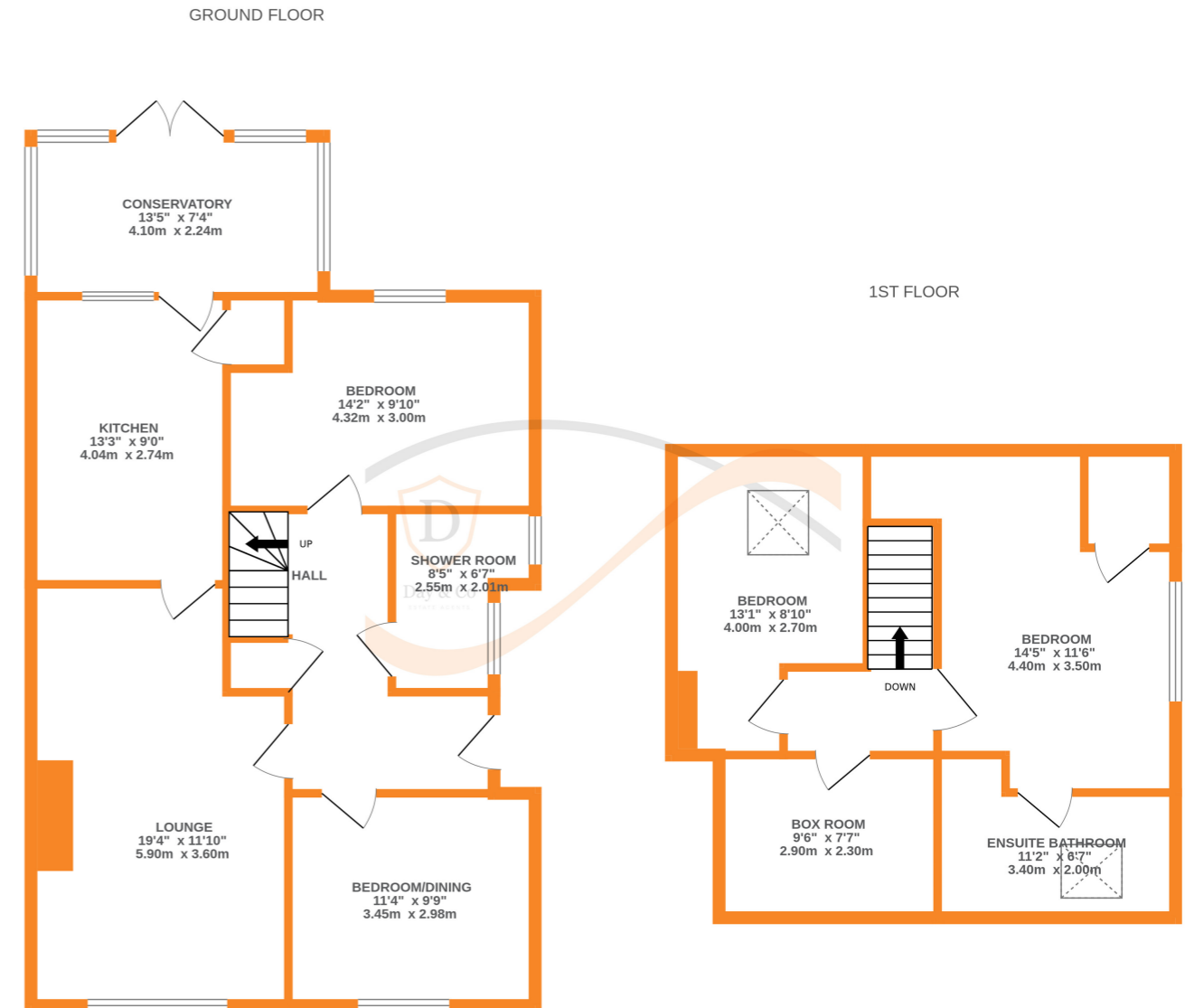

Whilst every attempt has been made to ensure the accuracy of the floorplan contained here, measurements of doors, windows, rooms and any other items are approximate and no responsibility is taken for any error, omission or mis-statement. This plan is for illustrative purposes only and should be used as such by any prospective purchaser. The services, systems and appliances shown have not been tested and no guarantee as to their operability or efficiency can be given.  
Made with Metropix ©2024