



15 Derwent Road, Henlow, Bedfordshire, SG16 6HE

£305,000

This beautifully presented two bedroom mid terrace home offers spacious and well planned accommodation. The property has recently been redecorated throughout and benefits from new carpets and flooring. There is a useful downstairs cloakroom, spacious kitchen/diner and generous size lounge. Upstairs are two double bedrooms and family bathroom. The fully enclosed rear garden is maintenance free and a driveway to the front provides off road parking for two vehicles. NO UPWARD CHAIN.

Lane &
BENNETTS

15 Derwent Road, Henlow

Approximate Gross Internal Area
775 sq ft - 72 sq m

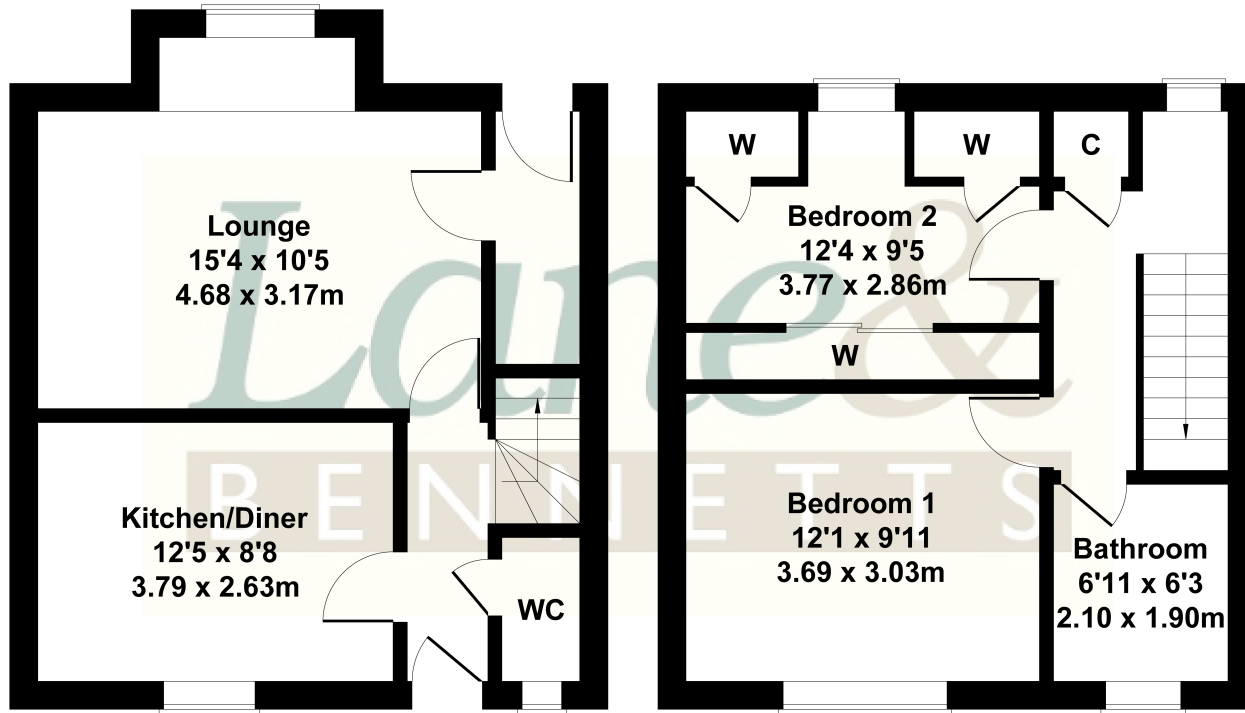

GROUND FLOOR

FIRST FLOOR

Not to Scale. Produced by The Plan Portal 2025
For Illustrative Purposes Only.

- TWO BEDROOM MID TERRACE
- IMMACULATLY PRESENTED
- BRAND NEW CARPETS AND FLOORING
- REDECORATED THROUGHOUT
- KITCHEN/DINER WITH BUILT IN APPLIANCES
- DOWNSTAIRS CLOAKROOM
- DRIVEWAY WITH OFF ROAD PARKING
- COUNTRYSIDE VIEWS TO FRONT
- NO UPWARD CHAIN

