



- Well Presented & Modernised Bungalow
- Complete Onward Chain
- Two Double Bedrooms
- Large Open Plan Lounge/Diner/Kitchen
- Modern Kitchen With A Range Of Units & Appliances
- Bi-Folding Doors To Rear Garden
- Main Bedroom With En-Suite Shower Room
- Four Piece Family Bathroom
- Quiet Road In The Sought After Area Of Gosfield

28 Chestnut Avenue, Gosfield, Halstead, Essex. CO9 1TD.

Tucked away on the peaceful and sought-after Chestnut Avenue in Gosfield, this tastefully modernised two double bedroom bungalow offers stylish and spacious living throughout.



Property Details.

Room Measurements

Entrance Hall



2.41m x 2.38m (7' 11" x 7' 10")

Open Plan Lounge/Diner



3.63m x 8.23m (11' 11" x 27' 0")

Kitchen/Breakfast Room



3.24m x 4.16m (10' 8" x 13' 8")

Inner Hall

Bedroom One



5.48m x 3.40m (18' 0" x 11' 2")

Property Details.

En-Suite



3.27m x 1.65m (10' 9" x 5' 5")

Family Bathroom



2.33m x 2.91m (7' 8" x 9' 7")

Bedroom Two



3.90m x 3.22m (12' 10" x 10' 7")

Outside



Property Details.

Floorplans

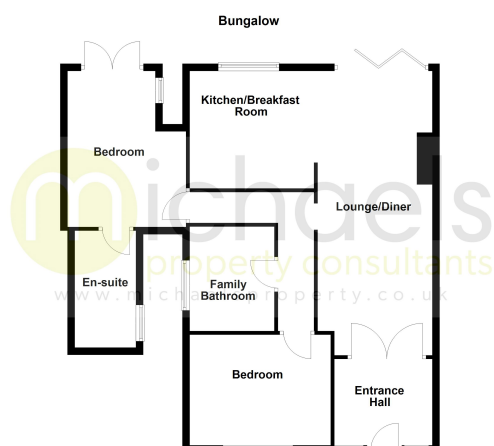

Location

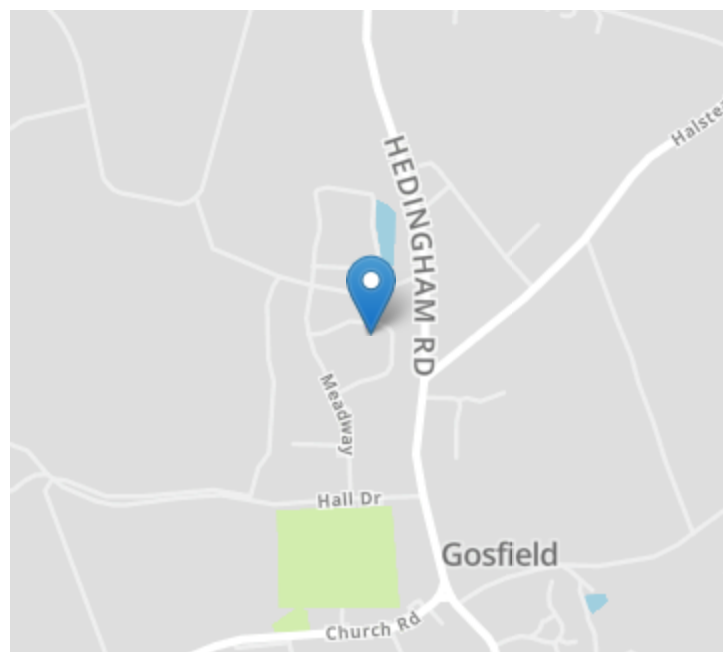

Energy Ratings

We have not carried out a structural survey and the services, appliances and specific fittings have not been tested. All photographs, measurements, floor plans and distances referred to are given as a guide only and should not be relied upon for the purchase of carpets or any other fixtures or fittings. Gardens, roof terraces, balconies and communal gardens as well as tenure and lease details cannot have their accuracy guaranteed for intending purchasers. Lease details, service ground rent (where applicable) are given as a guide only and should be checked and confirmed by your solicitor prior to exchange of contracts.