



Estate Agents and Solicitors

## 15/1 Murieston Crescent, Dalry, Edinburgh, EH11 2LJ

Beautifully Presented, Two-Bedroom, Ground-Floor Flat with Private Front Garden

Up to date price and viewing info at [mov8realestate.com/property](https://www.mov8realestate.com/property)

éspc rightmove<sup>®</sup> Zoopla  
find your happy

# Property Description

Beautifully presented, two-bedroom, ground-floor flat with a private front garden, forming part of a traditional stone-built tenement. Located in a desirable crescent with a central park, in the Dalry area, just west of Edinburgh city centre.

Comprises an entrance hallway, living/dining room, kitchen, two double bedrooms, a utility cupboard, and a bathroom.

Finished with a tasteful mix of contemporary decor together with retention of period details, ready-to-move-in.

Highlights include a quality fitted kitchen, a stylish bathroom suite, varnished hardwood flooring, and HIVE gas central heating. In addition, there are tall ceilings, cornice work, double-glazed sash and case windows, and working window shutters.

Externally, the property benefits from a private front garden, enclosed by tall privacy hedging; and a well-maintained shared rear garden with direct access from Bedroom one's patio doors. There is ample zoned street parking to the front and surrounding streets; whilst the open green space of Murieston Park lies opposite.

A welcoming entrance hall affords access throughout the majority of the property and features ample space for outerwear, a clothes pulley, and varnished hardwood flooring. Set to the front, the living room enjoys a southerly-facing aspect, with features including a period cornice work, an 'Edinburgh Press' with shelves, and twin windows allowing plentiful natural light. Set off, with varnished hardwood flooring continuing from the living room, a quality fitted kitchen has custom-built roof storage, whilst modern units include real-wood worktops, a tiled surround, a sink with a drainer, shelving, an integrated oven and gas hob; a freestanding fridge and chest freezer; and a washing machine housed in the utility cupboard.

Set to the rear, bedroom one offers a generous room, tastefully finished with light decor, carpeted flooring, cornice work, a built-in wardrobe, a further built-in wardrobe with full-height space, an 'Edinburgh Press' with shelves, and French patio doors leading to the shared garden. Bedroom two is set to the front and also offers a good-sized room, similarly well-finished with light decor, carpeted flooring, and cornice work. Completing the accommodation, a stylish bathroom has custom-built roof storage, and a contemporary three-piece suite including a rainfall shower over the bath, metro tiling, a ladder-style radiator, and bespoke shelving.



15/1 Murieston Crescent, Edinburgh EH11 2LJ

Approximate Gross Internal Area: (710 sq ft - 66 sq m.)

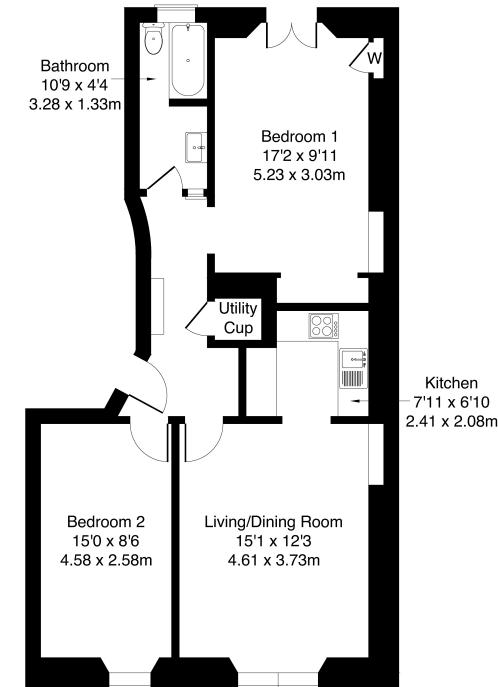
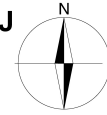

Legal Disclaimer: Floor-plan and measurements are for illustrative guidance only, and not intended to form part of any contract.

# Area Description





Dalry is a high-amenity area within walking distance of Haymarket Station, Edinburgh's West End and the city centre. There is excellent local shopping, with specialist shops and supermarkets close by, including Co-operative and Lidl supermarkets, whilst a Sainsbury's and Aldi are located nearby in Gorgie. There is an extensive range of cafes, bars and restaurants both in Dalry

End, whilst leisure facilities include the Fountain Park complex with a multi-screen cinema and fitness centre and the Dalry Swim Centre. Dalry is also convenient for Napier and Heriot-Watt universities, and Edinburgh College. There are frequent bus services, whilst the tram network is available from Haymarket for direct connections to Edinburgh Airport, the city centre and Newhaven.





### Our Services

-  Free pre-sale property valuations
-  Great value fixed estate agency fees
-  Extensive buyer matching database
-  Purchase and sale conveyancing

### Contact Us

0345 646 0208

[sales@mov8realestate.com](mailto:sales@mov8realestate.com)

[www.mov8.com](http://www.mov8.com)

### Head Office

6 Redheughs Rigg, Edinburgh, EH12 9DQ

### Glasgow Office

77 Renfrew Street, Glasgow, G2 3BZ



Estate Agents and Solicitors



These particulars do not form part of any contract and the statements or plans contained herein are not warranted nor are they to scale. All descriptions, dimensions, areas, reference to condition and necessary permissions for use and occupation and other details are given in good faith, and are believed to be correct, but any prospective purchaser should not rely on them as statements or representations of fact, and any prospective purchaser must satisfy themselves by inspection or otherwise as to the correctness of each of them. The Seller shall not be bound to accept the highest or any offer nor to accept a full offer of the Fixed Price where this is applicable. Approximate measurements have been taken by sonic device and measurements are most often taken to the widest point of any room or space. Services and appliances have not been tested for efficiency or safety and no warranty is given as to their compliance with any Regulations. Offers should be made using the Combined Standard Clauses.