

St. Kilda Road, W13 9DF

Approximate Floor Area = 125 sq m / 1345 sq ft

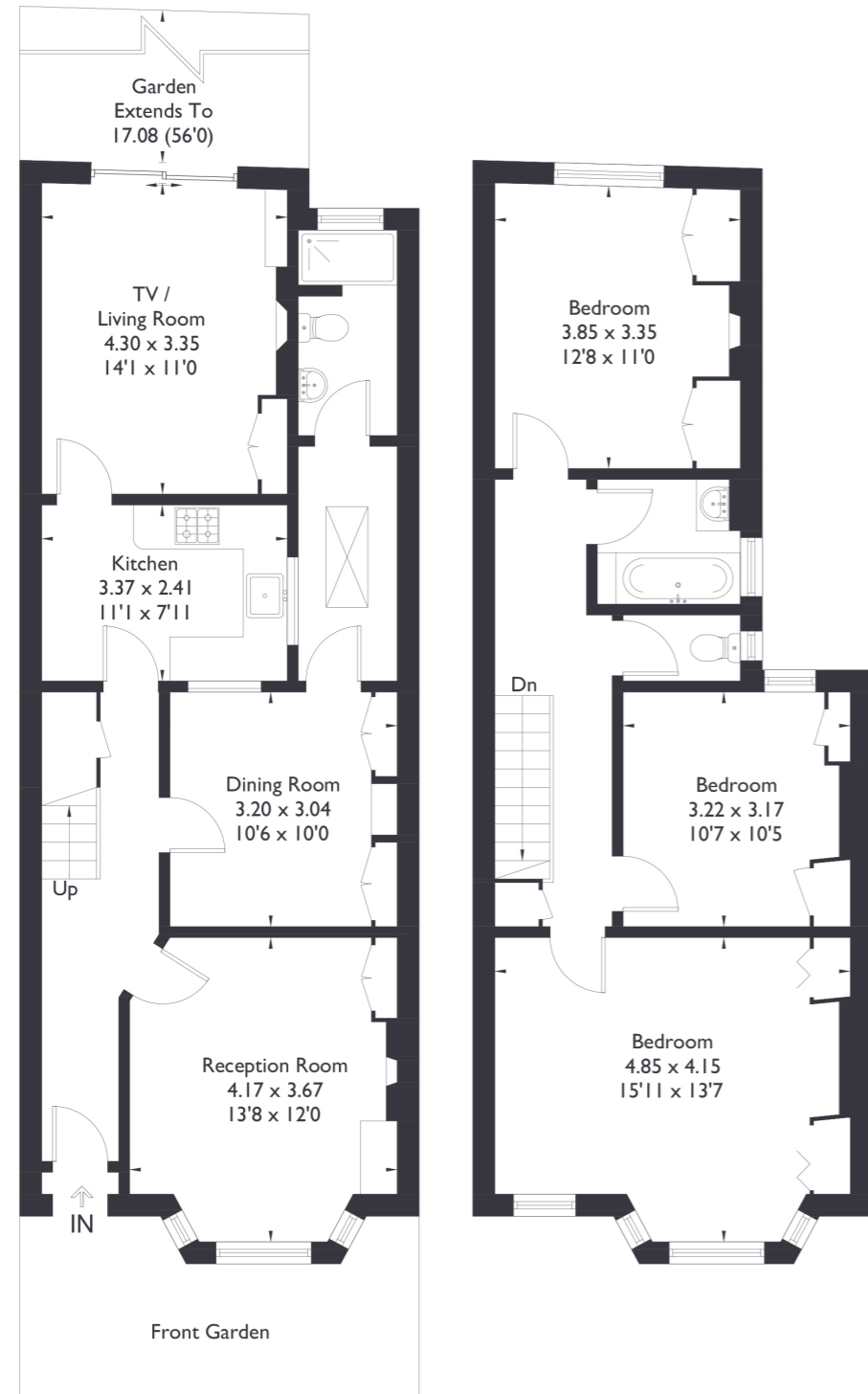

Ground Floor

First Floor



3 BEDROOM HOUSE

St Kilda Road, W13
£875,000

Introducing this delightful three bedroom, two bathroom house located in this charming pocket of Ealing.

This home offers a fantastic opportunity for refurbishment and holds immense potential. Featuring spacious rooms and original details throughout.

FEATURES

- Three Bedrooms
- Two Bathrooms
- Potential to Extend (STPP)
- Chain Free
- Close to Oaklands and Fielding Primary Schools
- Between West Ealing and Northfields Tube Stations



Inside, the home offers a truly inviting feel with its cosy working fireplace feature. On the ground floor, you'll find two generous reception rooms, a separate kitchen, and a downstairs W/C and wet room. As you make your way upstairs, you'll be greeted by three comfortable double bedrooms and a separate bathroom and toilet. Step outside to a beautiful, large, east-facing garden, which allows space for potential extensions both downstairs and upstairs. St Kilda offers an excellent location for connectivity, by providing easy access to public transportation and nearby amenities (West Ealing Elizabeth Line and Northfields Station). It's also close to Oaklands Primary, Fielding Primary and Elthorne High School. Additionally, this home boasts immense potential for renovation, allowing new owners to personalise and create their dream home. EPC Rating D.

