

27, Crofton Close Bracknell RG12 0UR



Situated in a sought-after residential cul-de-sac, just 0.7 miles walk from Martins Heron mainline railway station, this beautifully presented three-bedroom family home offers a superb blend of style, comfort, and convenience. Ideally positioned close to local amenities and the tranquil Savernake Lake, the property boasts bright and spacious living throughout. The ground floor features a generous living room and a sleek, refitted kitchen, designed with both practicality and modern living in mind. Upstairs, you'll find three well-proportioned bedrooms and a tastefully refitted family bathroom. To the rear, a beautifully landscaped and enclosed garden provides a peaceful retreat—perfect for entertaining or unwinding. Additional benefits include an integral garage and private driveway parking for 2 cars. Early viewing is highly recommended to fully appreciate this lovely home and its fantastic location. For more detailed material property information please click on the various brochure links.

£440,000 Freehold





Energy Efficiency Rating		
	Current	Potential
Very energy efficient - lower running costs		
(92+) A		
(81-91) B		85
(69-80) C	72	
(55-68) D		
(39-54) E		
(21-38) F		
(1-20) G		
Not energy efficient - higher running costs		
England, Scotland & Wales		EU Directive 2002/91/EC

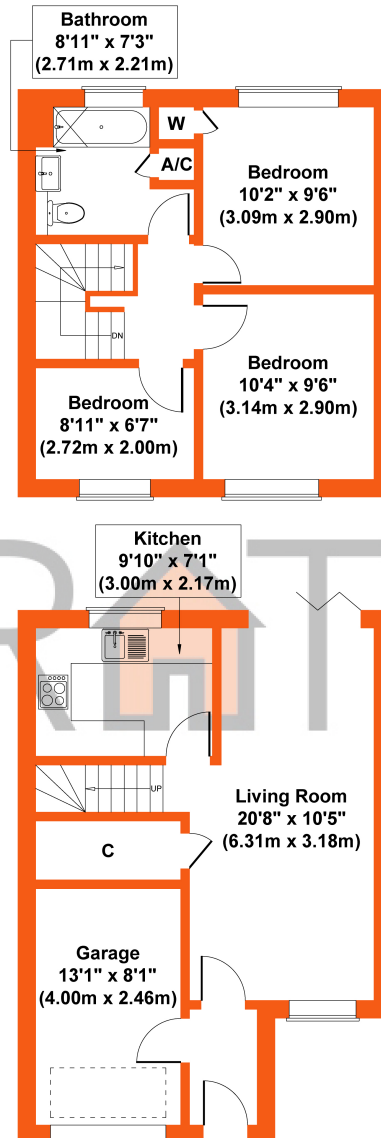

Approx. Gross Internal Floor Area 864 sq. ft. (80.3 sq. m.)

SKETCH PLAN FOR ILLUSTRATIVE PURPOSES ONLY

All measurements walls, doors, windows, fittings and appliances,
their sizes and locations, are approximate only.
They cannot be regarded as being a representation by the seller, nor their agent.

Produced by The Plan Portal 2025

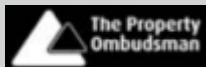

These particulars have been prepared in good faith to give a fair overall view of the property; they do not constitute an offer and will not form part of any contract. We make no representation about the conditions of the property nor that any services or appliances are in good working order; this should be checked by your surveyor. Furthermore, you should not assume that any items or features referred to in these particulars or shown in the photographs are included in the sale price. Your solicitor should check this as part of the normal conveyancing process.