

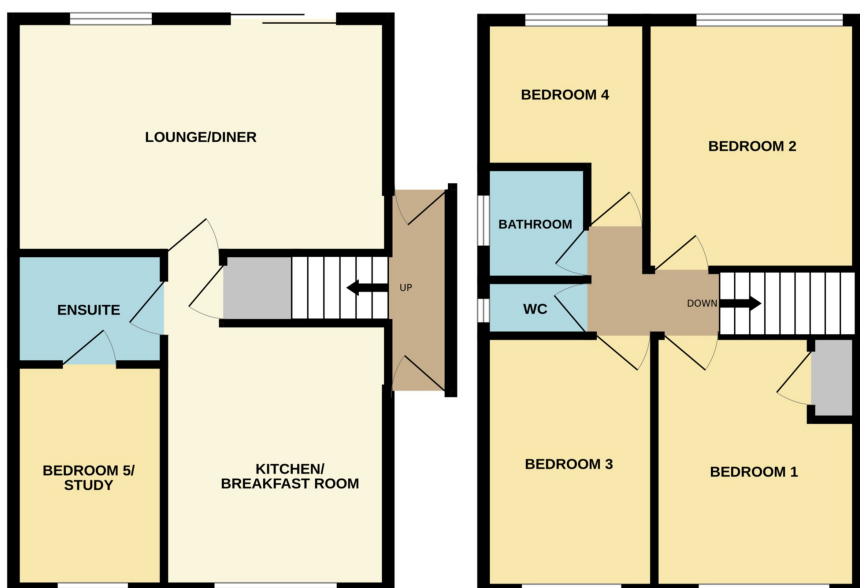

DEEPING ST JAMES

£300,000



*** DETACHED FAMILY HOME *** This versatile four/five bedroom detached family home is ideally located within easy reach of local amenities and schooling. The well presented accommodation includes an entrance porch, a spacious kitchen/diner, and a generous lounge/diner with sliding doors opening onto the rear garden. A versatile ground floor fifth bedroom or study benefits from its own en suite shower room, offering ideal guest or work-from-home space. Upstairs, there are four further bedrooms, a family bathroom, and a separate WC. Outside, the property features off road parking and an enclosed rear garden with patio and gravel areas. EPC Energy Rating C / Council Tax Band C.