

Truuli



Lakehall Road, Thornton Heath, Surrey, CR7

£275,000 Leasehold

- share of freehold
- Maisonette
- Modern decor
- Close proximity to all local transport and amenities
- Two double bedrooms
- First floor conversion
- Loft space that can be used for storage or to extend (SSTP)

2, Lansdowne Road, Croydon, Surrey, CR9 2ER

Tel: 0330 043 0002

Email: save@truuli.co.uk Web: www.truuli.co.uk

Lakehall Road, Thornton Heath, Surrey, CR7

£275,000 Leasehold

A lovely first floor maisonette, with its own private entrance. The property has been well maintained by the current owners and comprises; a large open plan kitchen living room, two double bedrooms and a modern three piece bathroom.

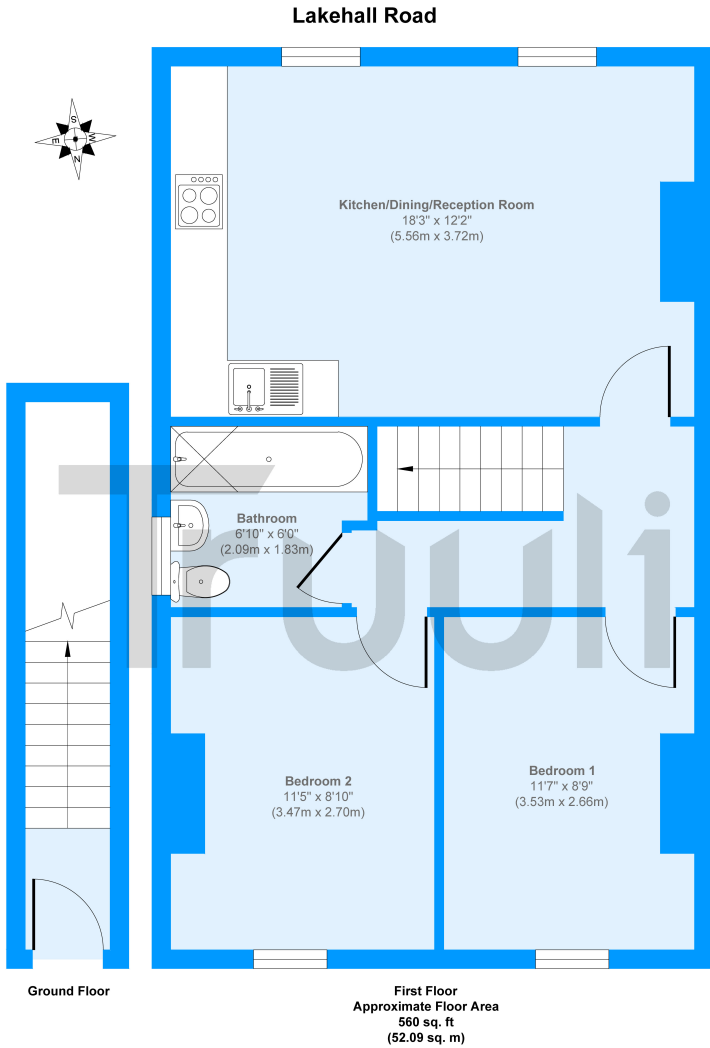

Approx. Gross Internal Floor Area 560 sq. ft / 52.09 sq. m
Produced by Elements Property

Energy Efficiency Rating		
	Current	Potential
Very energy efficient - lower running costs		
(92-100) A		
(81-91) B		
(69-80) C		
(55-68) D	60	66
(39-54) E		
(21-38) F		
(1-20) G		
Not energy efficient - higher running costs		
England, Scotland & Wales	EU Directive 2002/91/EC	

