



Day & Co
ESTATE AGENTS

28 Cavendish Street

Keighley

BD21 3RG



9 Westburn Avenue, Keighley,
West Yorkshire, BD22 6AL

£185,000

T: 01535 664609

W: www.dayandcoestateagents.co.uk

E: keighley@dayandcoestateagents.co.uk

- EPC Rating Is C
 - Three Bedrooms
 - Lounge With Wood Burning Stove
 - Enclosed Rear Garden/NO CHAIN
- Well Presented End Town House
 - Spacious Dining Kitchen
 - Recently Refurbished Accommodation

SUMMARY

****A SUPERBLY PRESENTED 3 BEDROOM END TOWN HOUSE, POPULAR RESIDENTIAL LOCATION WITH EXCELLENT ACCESS TO LOCAL SCHOOLS!**** Recently refurbished accommodation, spacious dining kitchen with wood burning stove, lounge with wood burning stove, enclosed landscaped rear garden & patio, generous size tarmac area to front - OFFERED FOR SALE WITH NO ONWARD CHAIN!! EPC rating is C.

FULL DESCRIPTION

Of interest to a variety of buyers is this well presented three bedroom end town house situated in the popular residential location of Exley Head with excellent access to local schools. The property has recently undergone a programme of modernisation and the accommodation comprises of an entrance hall, the lounge has a wood burning stove, radiator, double glazed window to the front. The spacious dining kitchen has a range of modern base and wall mounted units, breakfast bar, double glazed patio doors to the rear, double glazed window to the side, wood burning stove. To the first floor there are three bedrooms, the master having fitted mirror fronted wardrobes. The bathroom has a modern three piece suite comprising of a bath with shower over, WC, wash hand basin. Externally there is a landscaped enclosed rear garden with patio and a good size tarmac area to the front. Offered for sale with no onward chain, EPC rating is C.

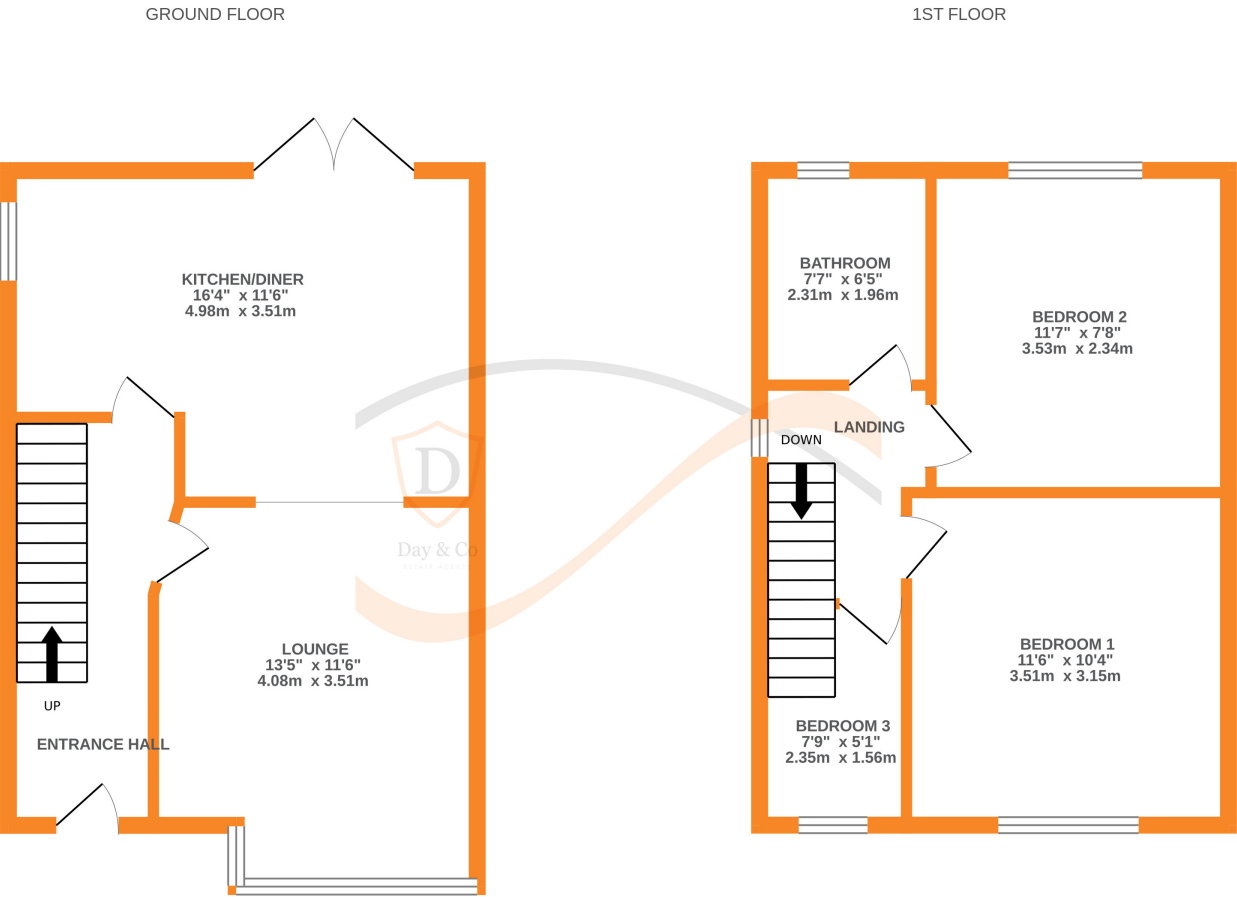

Whilst every attempt has been made to ensure the accuracy of the floorplan contained here, measurements of doors, windows, rooms and any other items are approximate and no responsibility is taken for any error, omission or mis-statement. This plan is for illustrative purposes only and should be used as such by any prospective purchaser. The services, systems and appliances shown have not been tested and no guarantee as to their operability or efficiency can be given.
Made with Metropix ©2025