



Three Bedroom End of Terrace House
Hanway, Rainham, Gillingham, Kent, ME8 6AL

Guide Price £300,000
Freehold

Hanway, Rainham, Gillingham, Kent, ME8 6AL

Guide Price £300,000

Freehold

Description

****Guide Price £300,000-£325,000**** Three-bedroom end of terrace home situated on a generous corner plot, offering excellent potential to extend to the side and rear (STPP). Upon entering, you are welcomed by a practical porch leading into a good-sized lounge. There is a separate dining room with French doors opening onto the rear garden, along with a well-appointed kitchen offering ample storage, making it ideal for family living. To the first floor, there are three well-proportioned bedrooms. The main bedroom benefits from a built-in storage cupboard and dual aspect windows, allowing for plenty of natural light. A modern family bathroom completes the upstairs accommodation. Externally, the property boasts a spacious rear and side garden with a mix of patio and lawn areas, enclosed by walls and featuring a useful shed. Double gates provide access to the driveway. To the front, there is a lawned area alongside a tandem driveway offering ample off-street parking. The property is excellently situated for local amenities, including Avenue Tennis, a range of shops, well-regarded schools, and convenient transport links. This property is expected to be popular so pick up the phone and start dialling the Greyfox sales team in Rainham to arrange your viewing now!

Key Features

- Three Bedroom End Of Terrace Family Home
- Close To Local Shops, Well-Regarded Schools & Transport Links
- Tandem Driveway Offering Off-Street Parking
- Potential To Extend To The Side & Rear (STPP)
- Main Bedroom Benefitting from Dual Aspect Windows Allowing For Plenty Of Natural Light
- Situated In A Popular Quiet Cul-De-Sac In Rainham
- Two Reception Rooms
- Large Enclosed Corner Plot Garden

Local Area

Rainham in the Medway towns is located descending towards the banks of the river Medway, approximately 39 miles from London. The ancient Watling Street main road (A2) runs through the town with the M2 motorway on the southern edge with good links to the M25/M20. There are a good number of shops and facilities within the town, a mainline station and a selection of local schools including Rainham Mark Grammar School.

GROUND FLOOR
371 sq.ft. (34.5 sq.m.) approx.

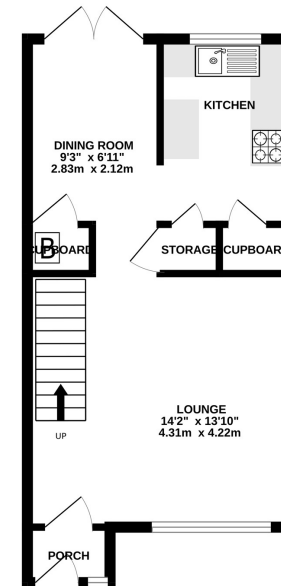

1ST FLOOR
355 sq.ft. (33.0 sq.m.) approx.

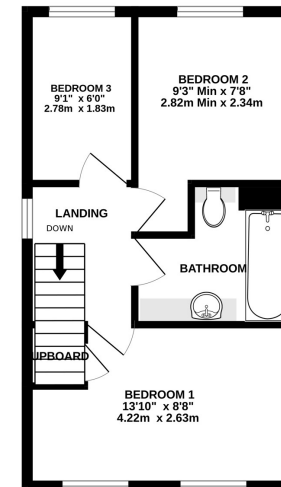

TOTAL FLOOR AREA : 727 sq.ft. (67.5 sq.m.) approx.

Whilst every attempt has been made to ensure the accuracy of the floorplan contained here, measurements of doors, windows, rooms and any other items are approximate and no responsibility is taken for any error, omission or mis-statement. This plan is for illustrative purposes only and should be used as such by any prospective purchaser. The services, systems and appliances shown have not been tested and no guarantee as to their operability or efficiency can be given.
Made with Metropix ©2026



Property Location

Hanway, Rainham, Gillingham, Kent, ME8 6AL

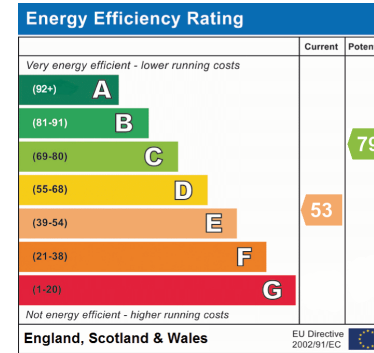
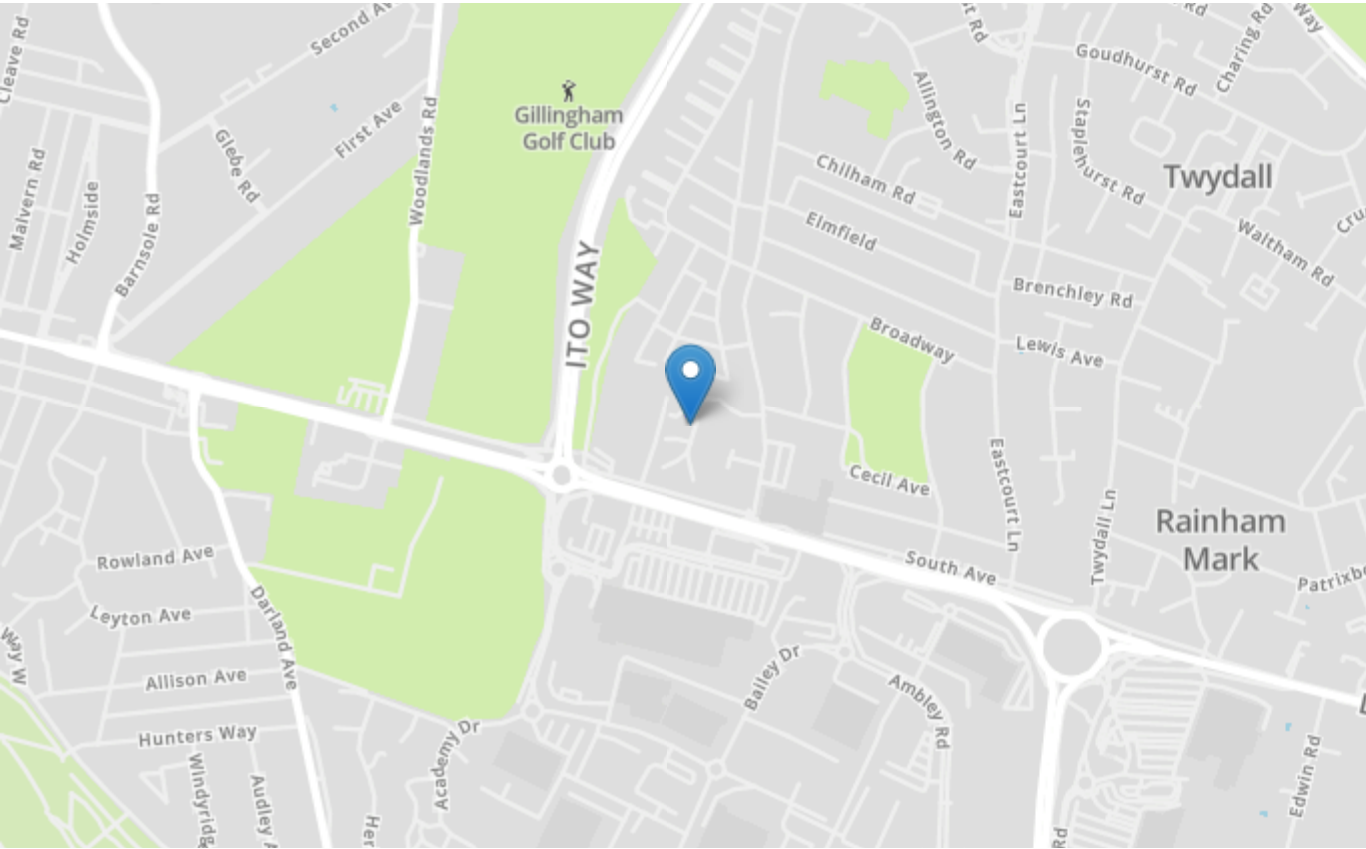

Tenure	Freehold
Lease Term	n/a
Ground Rent	n/a
Service Charge	n/a
Local Authority	Medway
Council Tax	Band B

Greyfox Walderslade

Unit 2, Thetford House
Walderslade Village Centre
Walderslade Road
Chatham
Kent
ME5 9LR
Tel: 01634 672227 Email:
walderslade@greyfox.co.uk

Greyfox Rainham

67C High Street
Rainham
Kent
ME8 7HS
Tel: 01634 377737 Email:
rainham@greyfox.co.uk

Agent Notes

These particulars are prepared as a general guide to a broad description of the property and should not be relied upon as a statement or representation of fact and do not constitute part of an offer or contract. The seller does not make or give nor do our employees or Greyfox have authority to make or give any representation or warranty to the property. We have not carried out a structural survey and the services, appliances and specific fittings have not been tested. All photographs, measurements, floorplans and distances referred to are given as a guide only and should not be relied upon for the purchase of carpets or any other fixtures or fittings. Lease details, service charges and ground rent (where applicable) and council tax are given as a guide only and should be checked and confirmed by you on inspection and your solicitor prior to exchange of contracts. If there are any points of particular importance to you we will be pleased to check the information for you and to confirm that the property remains available. This is particularly important should you be travelling some distance to view and where statements have been made by us to the effect that the information has not been verified. The copyright of all details, photographs and floorplans remain exclusive to Greyfox. For details of our privacy policy and referral fee arrangements with any of our selected partner companies please visit <https://www.greyfox.co.uk/legal/privacy> and <https://www.greyfox.co.uk/referral-fees>.