



**Flat 1-6, 46 Jameson Road
Bexhill-on-Sea
East Sussex
TN40 1EL**

Offers in Excess of £920,000

bettermove

Jameson Road Bexhill-on-Sea

Bettermove are proud to present this 8 bedroom converted building with 6 self contained flats in the sought after area of Bexhill-on-Sea.

The property benefits from double glazing, electric heating throughout in each flat and has off street parking available.

The property is tenanted and will be sold with tenants in situ for immediate investment - rental yields can be obtained through Bettermove.

The interior of this beautifully presented property consists of 4 x 1 bedroom flats and 2 x 2 bedroom flats across three floors. The exterior boasts a communal garden, perfect for enjoying the summer months. The property also benefits from 3 garages and further parking being available.

Located in the popular seaside town of Bexhill-on-Sea, the property is close to a range of amenities, including shops, supermarkets, restaurants and pubs. Excellent transport connections are within walking distance of Bexhill-on-Sea Train Station and many local bus routes.

This exciting opportunity should not be missed! All enquiries can be made through Bettermove on 0330 004 0050.

You can secure the purchase today by paying an exclusivity fee of £1,000 which gives you the rights to purchase within a given timeframe.

Paying this fee ensures that the seller takes their property off the market and reserves it exclusively for you, therefore eliminating the risk of gazumping and aborted costs.

The exclusivity fee is returned to you upon successful completion of the property.



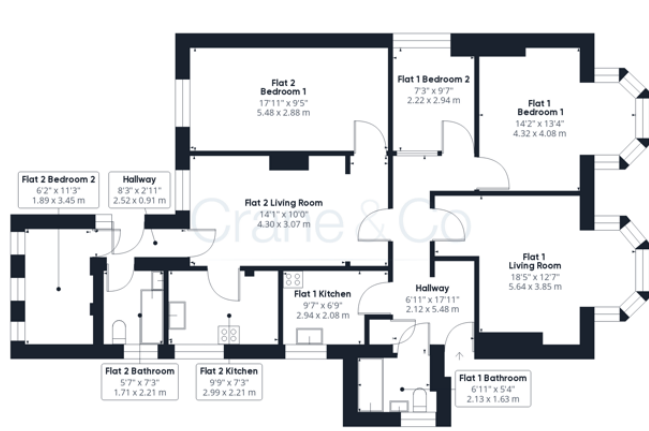

Floor 0



Floor 1



Floor 2



20-22 Bridge End, Leeds, LS1 4DJ
t: 0330 004 0050 e: hello@bettermove.co.uk
www.bettermove.co.uk