



4 Epsom Court, Sutton Place, Bexhill-on-Sea,
East Sussex, TN40 1PB

£300,000



- Two Bedroom Seafront Apartment For Sale
- South Facing Balcony
- Modern Fitted Kitchen
- Two Spacious Double Bedrooms
- Modern Fitted Shower Room
- Immaculate Condition Throughout
- Uninterrupted Sea Views
- Sought After Position Close To The Town Centre & Ravenside
- Sold With No Onward Chain
- Viewing Highly Recommended.



1ST FLOOR FLAT
632 sq.ft. (58.7 sq.m.) approx.

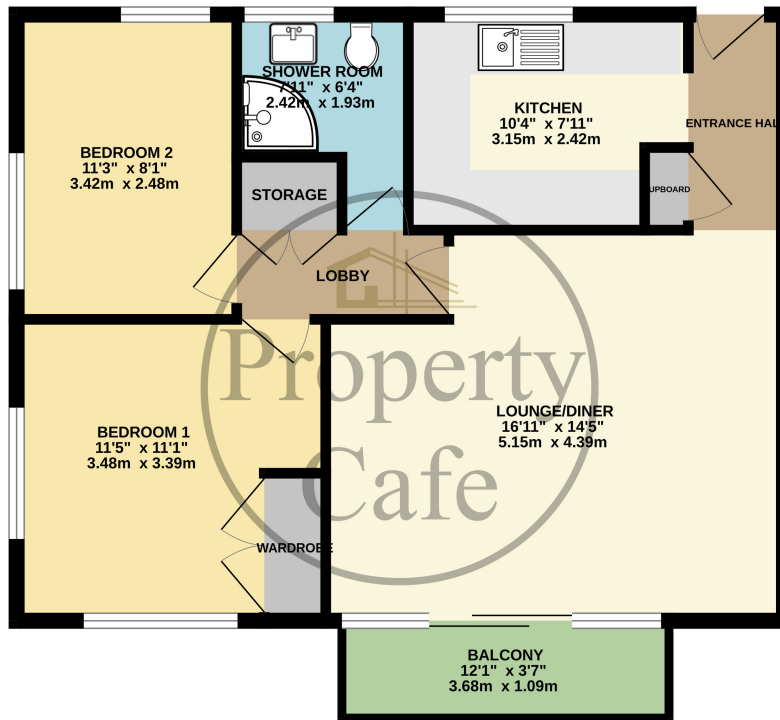

TOTAL FLOOR AREA : 632 sq.ft. (58.7 sq.m.) approx.

Whilst every attempt has been made to ensure the accuracy of the floorplan contained here, measurements of doors, windows, rooms and any other items are approximate and no responsibility is taken for any error, omission or mis-statement. This plan is for illustrative purposes only and should be used as such by any prospective purchaser. The services, systems and appliances shown have not been tested and no guarantee as to their operability or efficiency can be given.
Made with Metropix 02024