

SOLE
AGENT

7 Maison le Marchant

Grandes Maisons Road | St Sampson | GY24JP

This immaculate first floor modern flat is conveniently located near the amenities of The Bridge and within walking distance of Delancey Park. Accommodation comprises lounge/diner, kitchen, bedroom and bathroom. The property benefits from an underground parking space for one car, visitor parking and use of the communal garden. Regret no smokers, pets or children. Available 1st July.

£1,800 pcm

1 BEDROOM

1 BATHROOM

1 RECEPTION

PHOTOS



PHOTOS



FIRST FLOOR

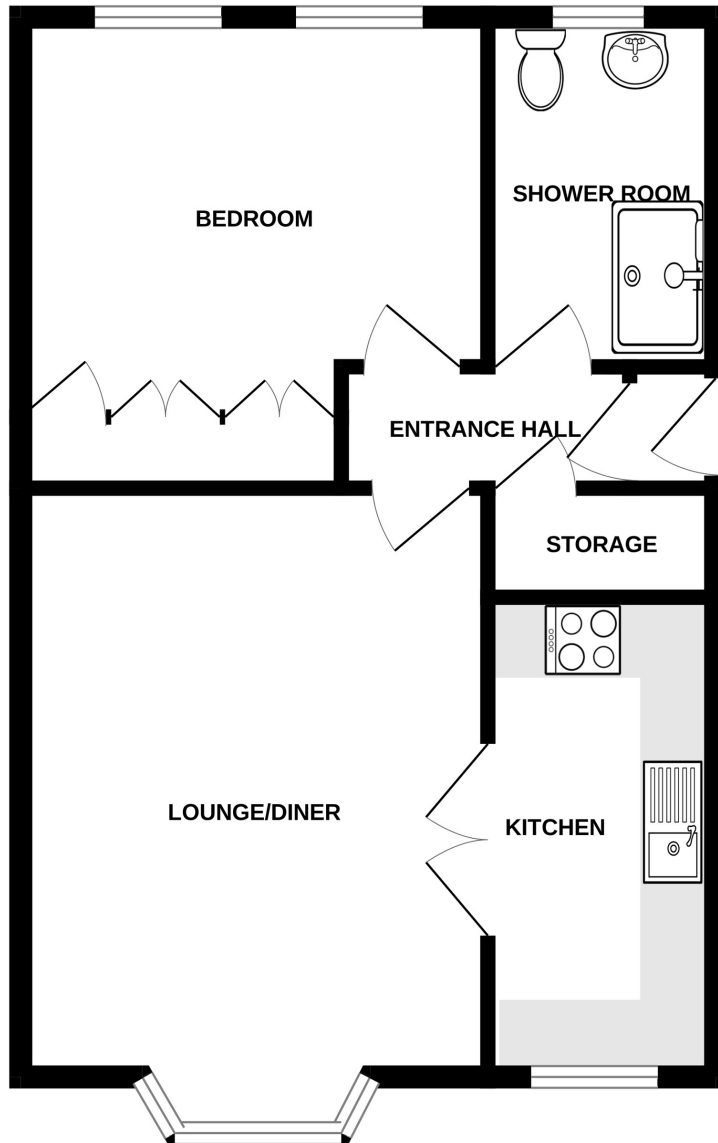

7 MAISON LE MARCHANT

Whilst every attempt has been made to ensure the accuracy of the floorplan contained here, measurements of doors, windows, rooms and any other items are approximate and no responsibility is taken for any error, omission or mis-statement. This plan is for illustrative purposes only and should be used as such by any prospective purchaser. The services, systems and appliances shown have not been tested and no guarantee as to their operability or efficiency can be given.
Made with Metropix ©2025