

Truuli



Danet Court, Campden Road, South Croydon, Surrey, CR2 7BZ

£385,000 Leasehold

- Two double bedrooms
- Large storage cupboards in the hallway
- Underground parking space
- Two bathrooms
- Close to Lloyd Park
- Large open plan kitchen, living and dining area

Southbridge Place, Surrey, CR0 4HA

Tel: 0330 043 0002

Email: save@truuli.co.uk Web: www.truuli.co.uk

Danet Court, Campden Road, South Croydon, Surrey, CR2 7BZ

£385,000 Leasehold

Vendor's comments: "We first fell in love with the flat in 2019 after a long year of searching. After a slight COVID delay, we moved in towards the end of 2020. It fit the bill perfectly, being brand new but not having that standard new build look and feel.

One of the key things we love about living here is the location; with Lloyds Park down the road, really good local schools and nurseries, and the high street with lots of lovely independent coffee shops, barbers, convenience stores and a Tesco local all just a 10-minute walk away.

It's also perfectly situated for commuting or travel (South Croydon is a 7-minute walk away or bus/tram to East Croydon in about 10 minutes)."

Ground Floor
717 sq.ft. (66.6 sq.m.) approx.

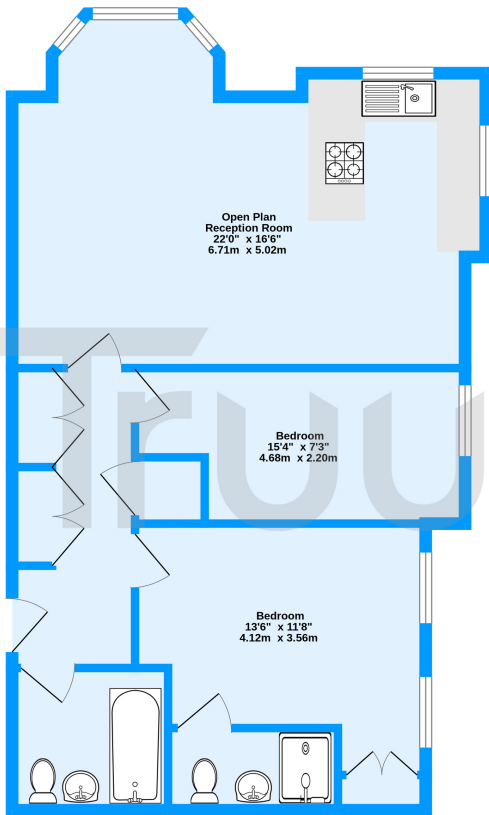

Danet Court, Campden Road, Croydon, CR2
TOTAL FLOOR AREA: 717 sq.ft. (66.6 sq.m.) approx.
Measurements are approximate. Not to scale. Illustrative purposes only
Made with Metropix ©2024

Energy Efficiency Rating		Current	Potential
Very energy efficient - lower running costs			
(92+)	A		
(81-91)	B	89	89
(69-80)	C		
(55-68)	D		
(39-54)	E		
(21-38)	F		
(1-20)	G		
Not energy efficient - higher running costs			
England, Scotland & Wales		EU Directive 2002/91/EC	

