



60 Elgar Drive, Shefford, Bedfordshire, SG17 5RA

£365,000

Four bedroom end of terrace townhouse offering spacious and flexible accommodation over three floors. The property benefits from a spacious L-shaped lounge with Juliet balcony overlooking the rear garden, a fitted kitchen/dining room, versatile family room, study and a downstairs cloakroom. There are also four good size bedrooms with the master bedroom with en-suite on the first floor, and the three further bedrooms and family bathroom on the second floor. Outside there are both front and rear gardens as well as parking via the driveway and space to the rear. Situated in a quiet cul-de-sac location and available with a short onward chain.



60 Elgar Drive, Shefford

Approximate Gross Internal Area
1453 sq ft - 135 sq m

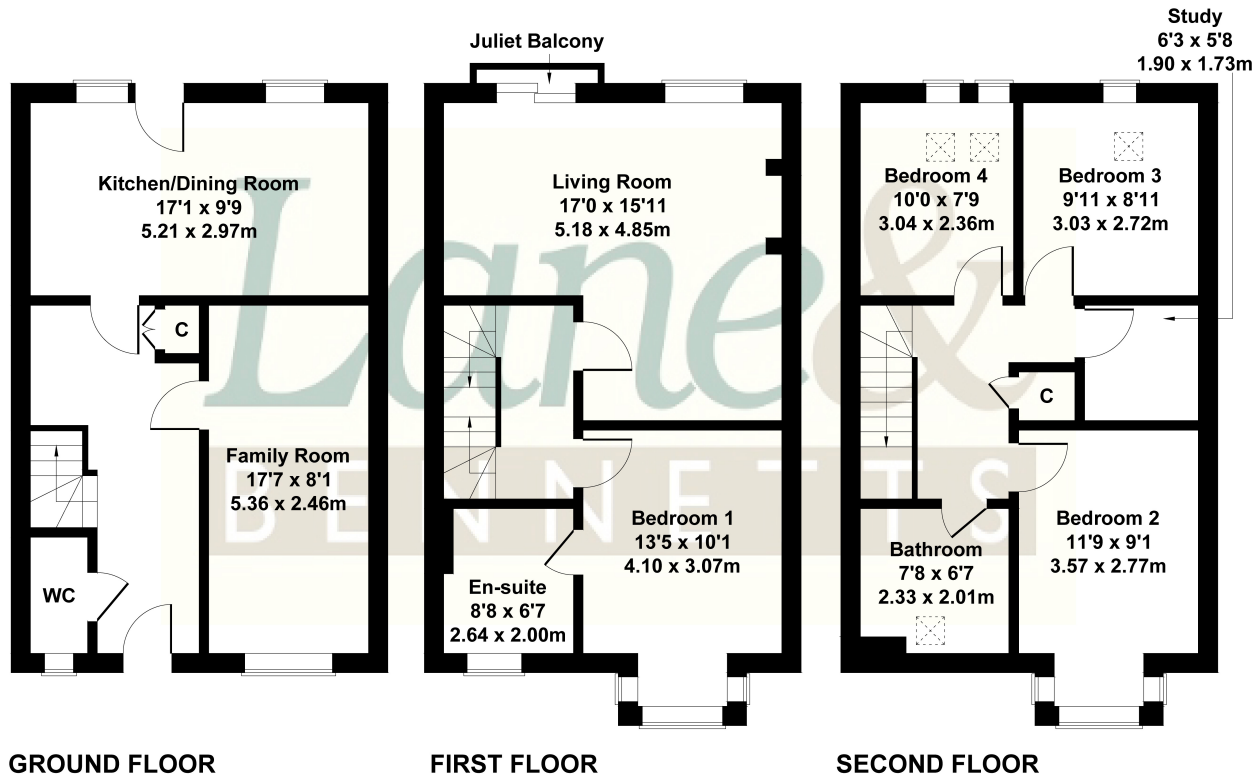

Not to Scale. Produced by The Plan Portal 2024
For Illustrative Purposes Only.

- FOUR BEDROOM END OF TERRACE TOWN HOUSE
- FLEXIBLE ACCOMMODATION OVER THREE FLOORS
- SPACIOUS L-SHAPED LOUNGE WITH JULIET BALCONY
- FAMILY ROOM & STUDY
- FITTED KITCHEN/DINING ROOM
- FAMILY BATHROOM, CLOAKROOM & EN-SUITE
- FRONT & REAR GARDENS
- DRIVEWAY & ADDITIONAL PARKING SPACES
- CUL-DE-SAC LOCATION
- SHORT ONWARD CHAIN

