



## Queen Street

Saxon Court | Queen Street | Hitchin | Hertfordshire | SG4 9TB

[www.stonegate-estates.co.uk](http://www.stonegate-estates.co.uk)





# QUEEN STREET

---

## Property Description

We offer for sale this one bedroom dual aspect retirement property situated on the upper ground floor in the heart of the town center.

The property is light and airy and is presented in good decorative order throughout. The main living room has dual aspects toward the town center and the kitchen also has a window to create maximum light.

There is a shower room along with a good sized bedroom and the development offers a visitors suite, communal lounge and laundry along with delightful gardens.

Viewing is strongly advised.

**£160,000 Leasehold**







**Floor Plan**

Approx. 41.0 sq. metres (441.8 sq. feet)

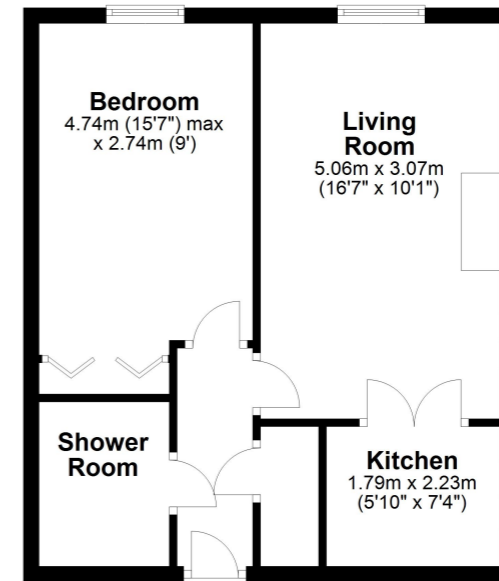

Total area: approx. 41.0 sq. metres (441.8 sq. feet)

All measurements shown are approximate and for guidance only. Garages and workshops are not included in any gross floor areas unless integral to the main building where they will be included. Plan produced using PlanUp.





- One Bedroom Retirement Apartment
- Upper Ground Floor
- Lift to all Floors
- Town Centre Location
- Dual Aspect to Living Room
- Careline 24hr System
- Residents Lounge
- Communal Gardens

EPC Rating: B

Stonegate Estate Agents

01462 438979

[sales@stonegate-estates.co.uk](mailto:sales@stonegate-estates.co.uk) | [www.stonegate-estates.co.uk](http://www.stonegate-estates.co.uk)

