



Two Bedroom Terraced House
Conrad Close, Parkwood, Gillingham, Kent, ME8 9SD

Guide Price £270,000
Freehold

Conrad Close, Parkwood, Gillingham, Kent, ME8 9SD

Guide Price £270,000

Freehold

Description

Guide Price £270,000-£290,000. This beautifully presented modern family home offers two spacious double bedrooms and is ideally located in a cul-de-sac in popular Parkwood. Perfect for first-time buyers and investors alike, the home is ready for you to move in and enjoy, thanks to its stylish natural décor throughout. The property features a welcoming porch leading into a generously sized lounge and a charming country-style kitchen with ample space and an additional utility area under the stairs. The separate dining room with sliding doors opens to a large garden with a patio, lawn, and convenient gated rear access, ideal for outdoor entertaining or relaxing. Upstairs, a fully modernised family bathroom with shower over the bath, both double bedrooms include built-in cupboards, offering plenty of space for comfortable living. Added benefits include an en-bloc garage, road parking and a fully boarded loft with a pull-down ladder, providing excellent storage solutions.

With its proximity to local shops, schools, transport links, and amenities, we anticipate high interest in this property. Don't miss your chance to view, contact the Greyfox sales team in Rainham today and secure your new home!

Key Features

- Perfect Family Home, First Time Purchase or Potential Investment Opportunity
- Mid Terrace House
- Two Reception Rooms
- Popular Parkwood Location, Close to Schools, Transport Links, Shops & Local Amenities
- Two Generous Double Bedrooms
- Spacious Porch & Handy Storage Throughout
- Garage En-Bloc & On Road Parking
- Rear Garden Measuring Approx 25x20ft With Rear Access

Local Area

Parkwood is located on the southern side of Rainham with good road links to the M2/M20 and is served by Rainham Station into central London. Parkwood offers a variety of schools and amenities and enjoys a pleasant position on the edge of rural Kent.

GROUND FLOOR
427 sq.ft. (39.6 sq.m.) approx.

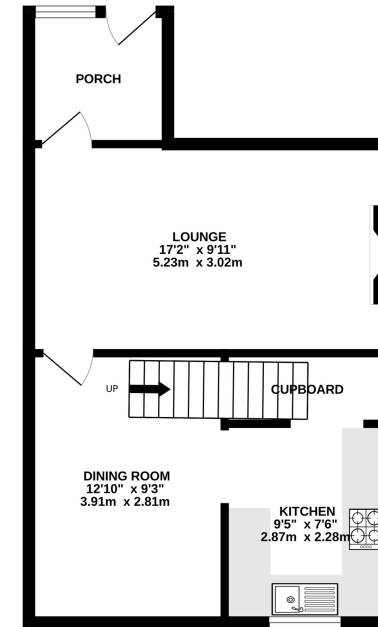

1ST FLOOR
388 sq.ft. (36.1 sq.m.) approx.

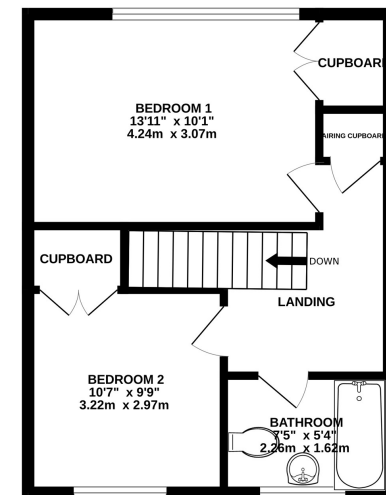

TOTAL FLOOR AREA : 815 sq.ft. (75.7 sq.m.) approx.

Whilst every attempt has been made to ensure the accuracy of the floorplan contained here, measurements of doors, windows, rooms and any other items are approximate and no responsibility is taken for any error, omission or mis-statement. This plan is for illustrative purposes only and should be used as such by any prospective purchaser. The services, systems and appliances shown have not been tested and no guarantee as to their operability or efficiency can be given.
Made with Metropix ©2024



Property Location

Conrad Close, Parkwood, Gillingham, Kent, ME8 9SD

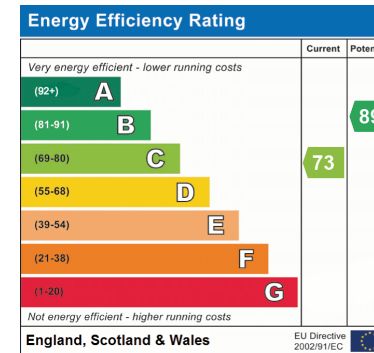
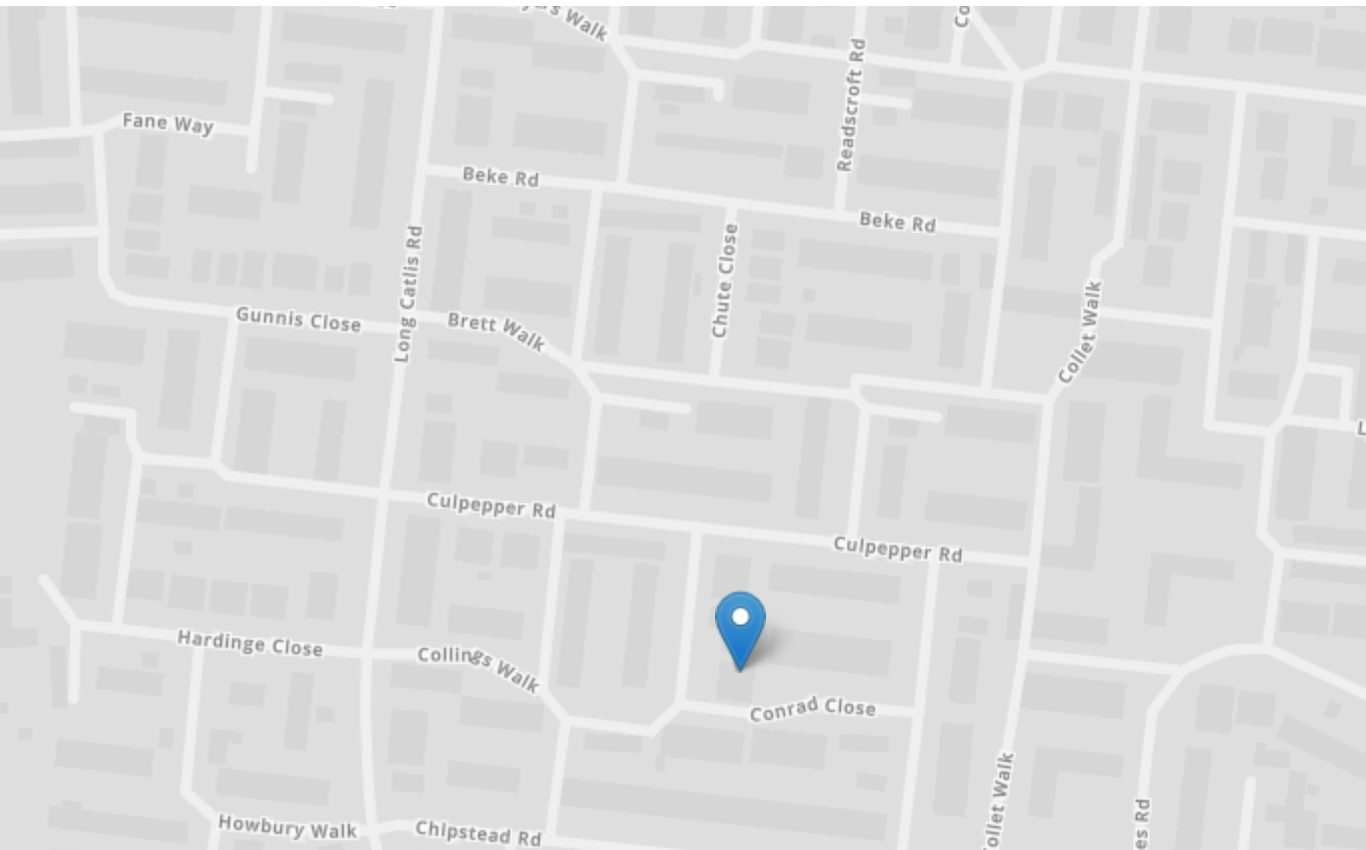

Tenure	Freehold
Lease Term	N/A
Ground Rent	N/A
Service Charge	N/A
Local Authority	Medway
Council Tax	Band B

Greyfox Walderslade

Unit 2, Thetford House
Walderslade Village Centre
Walderslade Road
Chatham
Kent
ME5 9LR
Tel: 01634 672227 Email:
walderslade@greyfox.co.uk

Greyfox Rainham

67C High Street
Rainham
Kent
ME8 7HS
Tel: 01634 377737 Email:
rainham@greyfox.co.uk

Agent Notes

These particulars are prepared as a general guide to a broad description of the property and should not be relied upon as a statement or representation of fact and do not constitute part of an offer or contract. The seller does not make or give nor do our employees or Greyfox have authority to make or give any representation or warranty to the property. We have not carried out a structural survey and the services, appliances and specific fittings have not been tested. All photographs, measurements, floorplans and distances referred to are given as a guide only and should not be relied upon for the purchase of carpets or any other fixtures or fittings. Lease details, service charges and ground rent (where applicable) and council tax are given as a guide only and should be checked and confirmed by you on inspection and your solicitor prior to exchange of contracts. If there are any points of particular importance to you we will be pleased to check the information for you and to confirm that the property remains available. This is particularly important should you be travelling some distance to view and where statements have been made by us to the effect that the information has not been verified. The copyright of all details, photographs and floorplans remain exclusive to Greyfox. For details of our privacy policy and referral fee arrangements with any of our selected partner companies please visit <https://www.greyfox.co.uk/legal/privacy> and <https://www.greyfox.co.uk/referral-fees>.