



Situated in the sought after village of North Warnborough, this charming terrace two bedroom cottage retaining many character features is offered to the market with no onward chain and would make a ideal first time purchase or investment.

Accommodation on the ground floor includes a sitting room with fireplace, a refitted kitchen and access to a small outside garden space. Upstairs the property offers two bedrooms with the master benefiting from storage space and a refitted shower room.

North Warnborough is a small village situated in North East Hampshire. Its neighbouring villages are Odiham, Hook and Winchfield. The London-Basingstoke Canal conservation area passes through the middle of the village, which is bounded to the north by the River Whitewater.

The village consists of a conservation area, bounded by Mill Corner in the north and The Street in the south, lying to each side of the B3349 Reading to Alton road. Most of the village's listed buildings lie within the conservation area. There are good transport links with easy access to the M3 motorway

and direct links to London Waterloo and Southampton from Hook's rail station where there are also indirect routes to Reading and Salisbury.

















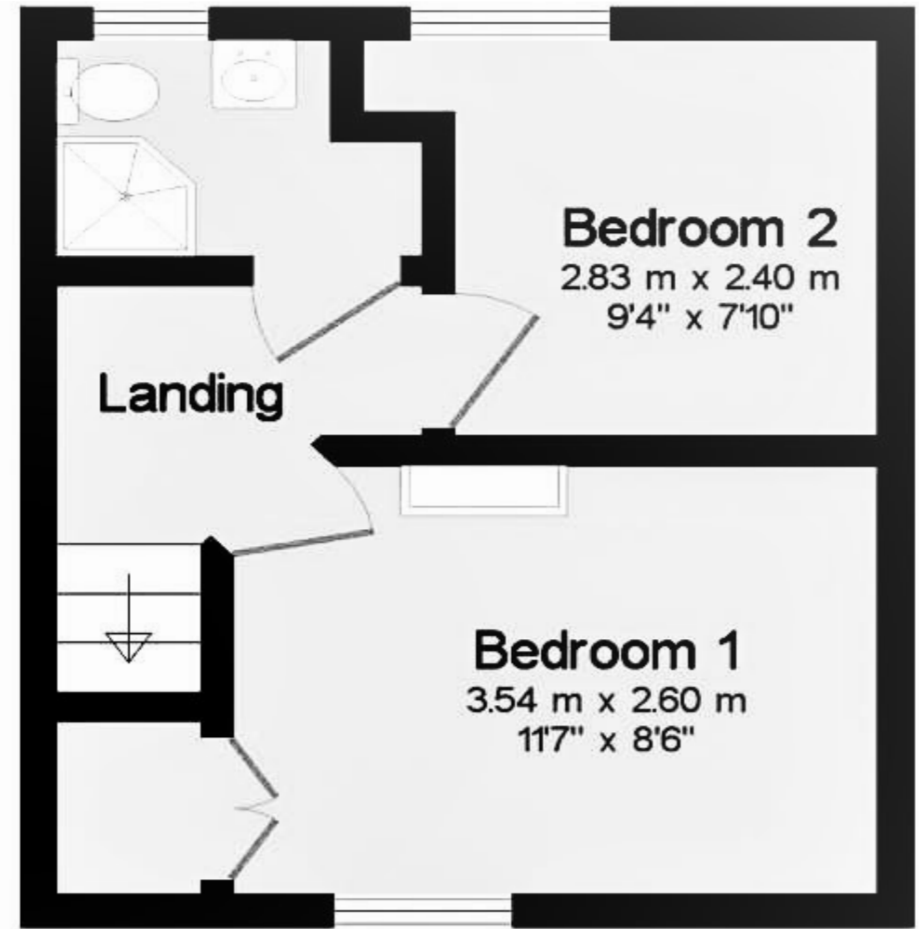
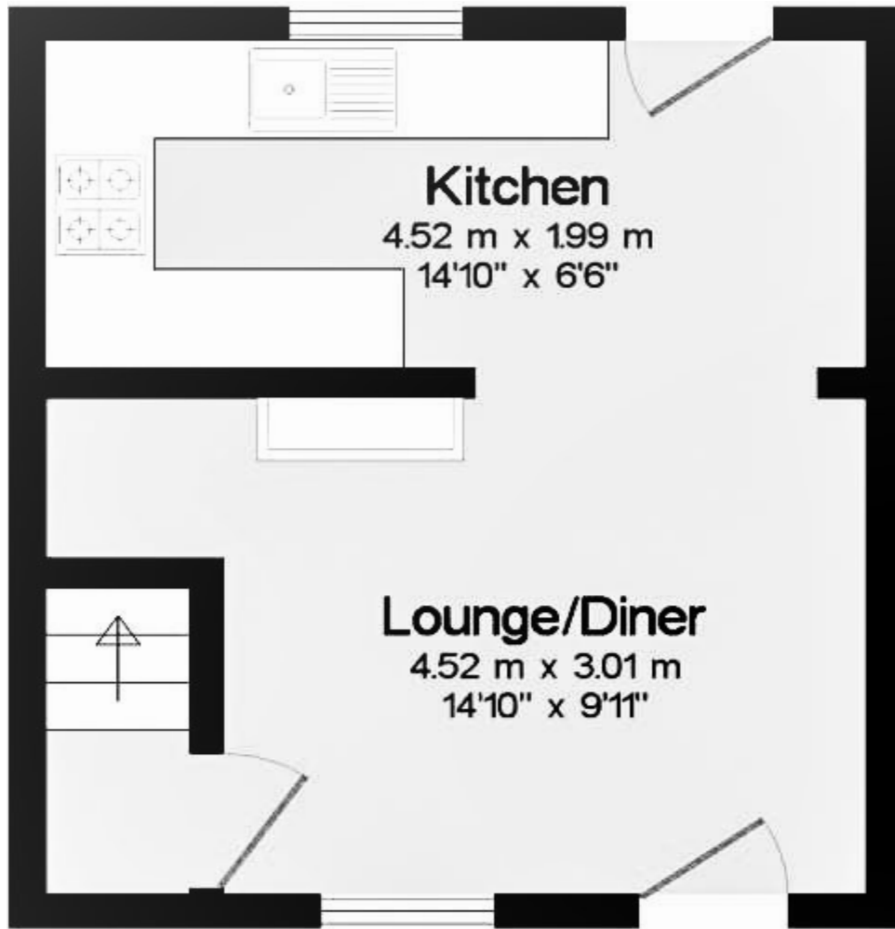

CONSUMER PROTECTION REGULATIONS

McCarthy Holden give notice that the particulars are produced in good faith and in accordance with the Consumer Protection from Unfair Trading Regulations 2008 (CPR). They are set out as a general guide only and do not constitute any part of a contract or warranty whatsoever. Intending purchasers or tenants should not rely on them as statements of representation of fact, but must satisfy themselves by inspection or otherwise as to their accuracy. No person in the employment of McCarthy Holden has any authority to make or give any representation or warranty whatever in relation to the property. A detailed survey has not been carried out nor have the services, heating systems, appliances or specific fittings been tested. Any photograph incorporated within these particulars shows only certain parts of the property and it must not be assumed that any contents or fixtures and fittings shown in the photographs are either included with the property or indeed remain in it. Room sizes shown and any floor plans should not be relied upon for carpets and furnishings. If there is any point which is of particular importance to you we will be pleased to check the information for you and confirm that the property remains available. This is particularly important if you are contemplating travelling some distance to view the property.

Fixture and Fittings:

All items of fixture and fittings, including but not exclusively carpets, curtains/blinds, light fittings, kitchen equipment generally and garden ornaments etc. are specifically excluded unless mentioned.

Directions:

Postcode: RG29 1BE

Please contact McCarthy Holden for detailed directions

Viewing:

Telephone: 01256 704851
Email: odiham@mccarthyholden.co.uk

Services:

Mains electricity, water, drainage and
gas central heating

Local Authority:

Hart District Council
Tel: 01252 622122
Council Tax Band - D

McCarthy
Holden 