



Bennett Court, Station Road, Letchworth Garden City SG6 3WA





2 Bedroom Apartment £260,000 Leasehold

'Bennett Court' is a modern retirement complex located near a wide variety of shops and amenities; this property is one of the largest in the development, featuring two large double bedrooms, a large lounge with dining area, a resident's lounge, guest suite, lift access to all floors and pull cords in each room.

- Large communal garden
- Two bedroom apartment
- Town centre location
- Lift to all floors
- Close to station
- Over 60's development
- Great size apartment
- House manager
- EPC rating C. Council tax band C



Ground Floor:

Communal Entrance:

Second Floor:

Entrance:

The entrance leads to the hallway.

Hallway: Doors to all rooms. Cupboard housing water heater, second cupboard.

'L' Shaped Lounge/Dining Area:

Abt. 15' 2" x 16' 7" (4.62m x 5.05m) Windows to side. Electric heater. Feature fireplace. Opening to kitchen.

Kitchen Area:

Abt. 4' 8" x 7' 6" (1.42m x 2.29m) Window to side. Fully fitted kitchen with a comprehensive range of matching wall and base units, stainless steel sink with mixer tap, eye-level electric oven, ceramic hob with extractor hood over. Space for fridge/freezer. Space for washing machine.

Bedroom One:

Abt. 15' 7" x 9' 3" (4.75m x 2.82m) Window to side. Fitted wardrobes with folding mirrored doors. Electric heater.

Bedroom Two:

Abt. 15' 7" x 9' 2" (4.75m x 2.79m) Window to side. Electric heater.

Bathroom:

Fitted with shower cubicle, pedestal wash basin and low-level WC. Extractor fan.

Additional Information:

Agents Note:

Draft details yet to be approved by the vendor and may be subject to change.



These particulars are a guide only and do not constitute an offer or a contract. The floor plan is for identification purposes only and not to scale. All measurements are approximate and should not be relied upon if ordering furniture, white goods and flooring etc. We have presented the property as we feel fairly describes it but before arranging a viewing or deciding to buy, should there be anything specific you would like to know about the property please enquire. Satchells have not tested any of the appliances or carried out any form of survey and advise you to carry out your own investigations on the state, condition, structure, services, title, tenure, and council tax band of the property. Some images may have been enhanced and the contents shown may not be included in the sale. Satchells routinely refer to 3rd party services for which we receive an income from their fee. If you would like us to refer you to one of these services please ask one of our staff who will pass your details on. We advise you check the availability of the property on the day of your viewing.

Ground Floor

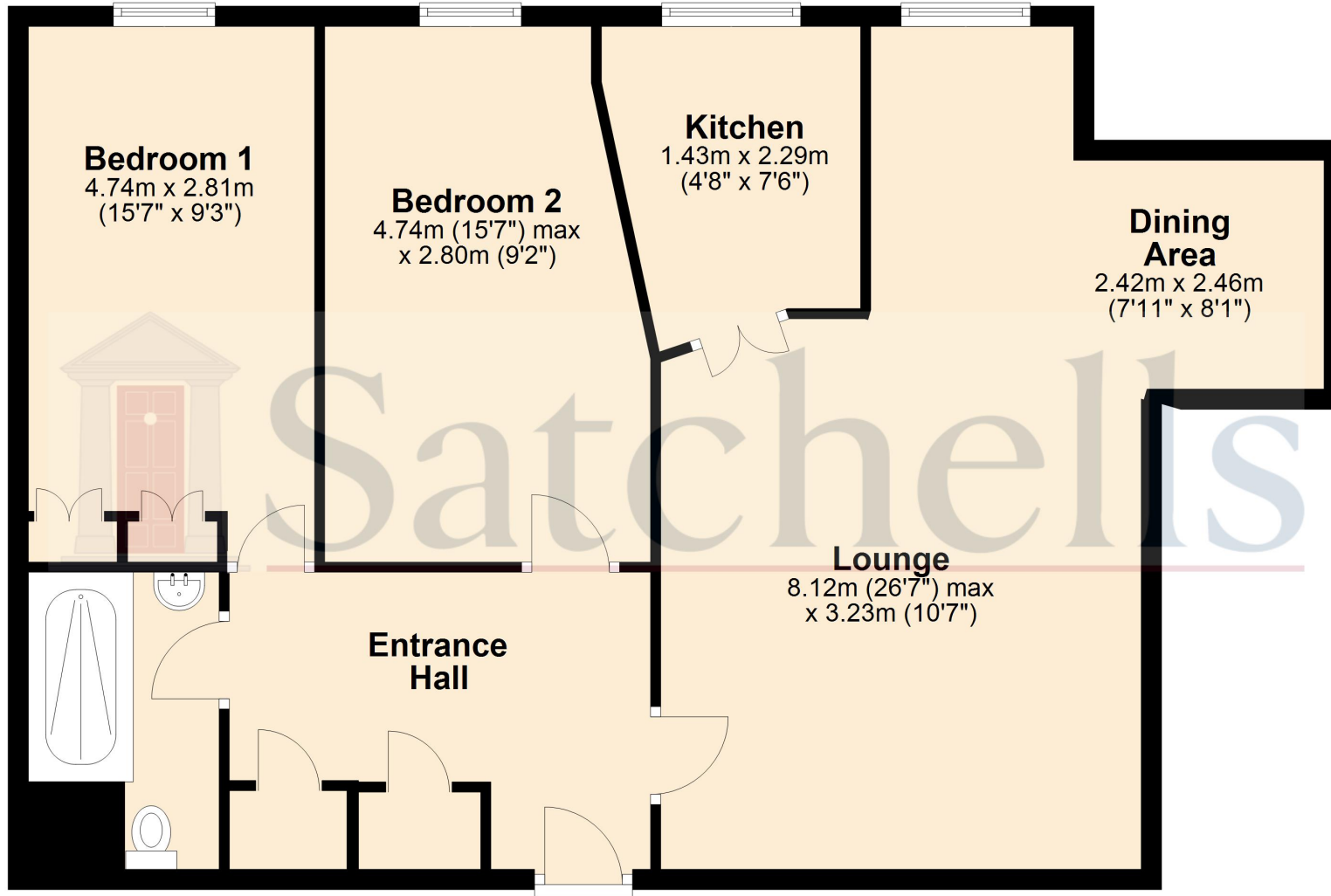

For illustrative purposes only - NOT TO SCALE - Measurements shown are approximate. The size and position of doors, windows, appliances and other features are approximate.
Plan produced using PlanUp.