



Bedford Road

Maples Court | Bedford Road | Hitchin | Hertfordshire | SG5 1HF

www.stonegate-estates.co.uk



BEDFORD ROAD

Property Description

Situated in the ever popular retirement development of just moments from Hitchin town centre. This well presented ground floor apartment benefits from the lounge doors opening onto the communal gardens offers comfortable and convenient retirement living.

The property features comfortable accommodation throughout with the lounge benefitting from doors opening on to the communal gardens which allows the fresh air in and direct access to the gardens. The kitchen is directly off of the lounge with the double bedroom and shower room and good size storage cupboard off of the entrance hall.

The development offers excellent communal facilities including a spacious residents' lounge, ideal for socialising or relaxing, as well as an on-site laundry room for added convenience.

Perfectly positioned in the heart of Hitchin town centre, residents will benefit from easy access to a wide range of shops, cafes, and local amenities, as well as excellent public transport links including Hitchin Railway Station which is the gateway to various destinations, including London St Pancras International, Cambridge and Gatwick Airport.

Offered with no onward chain, this apartment presents an ideal opportunity for those seeking stylish, low-maintenance retirement living in a vibrant town centre setting.

£185,000 Leasehold





Approximate Gross Internal Area = 44.9 sq m / 483 sq ft

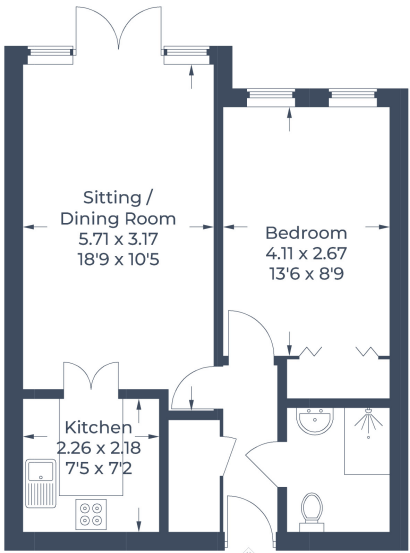

Ground Floor

Illustration for identification purposes only,
measurements are approximate, not to scale.
© CJ Property Marketing Produced for Stonegates



- Ground Floor Apartment
- One Bedroom
- Lounge opens directly onto Communal Garden
- Well Presented Throughout
- Superb Town centre Location
- Communal Gardens & Fountain
- Parking Available
- Chain Free Purchase

EPC Rating: C

Stonegate Estate Agents

01462 438979

sales@stonegate-estates.co.uk | www.stonegate-estates.co.uk

