

# Clay Street

Crockerton, BA12 8AG

COOPER  
AND  
TANNER



£299,000 Freehold

🚗 2 🛋️ 2 🚿 1 EPC E

## Description

A delightful extended end terrace two bedroom cottage that has part natural stone part brick elevations under a tiled roof. This charming property is located in the beautiful village of Crockerton. The accommodation in brief comprises an entrance porch, sitting room with wood flooring and fireplace and wood burner, a fitted kitchen, conservatory, first floor landing, two bedrooms, bathroom. Outside the home has a private drive offering parking, and a lovely rear garden with patio and lawned areas. Viewing highly advised.

## Clay Street, Crockerton, Warminster, BA12

Approximate Area = 738 sq ft / 68.5 sq m

For identification only - Not to scale

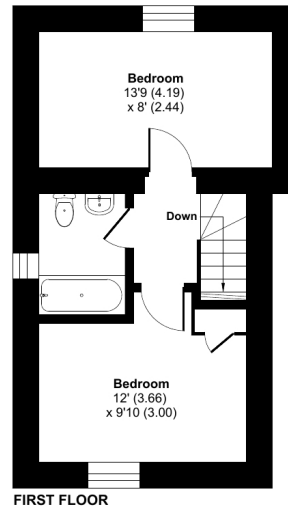
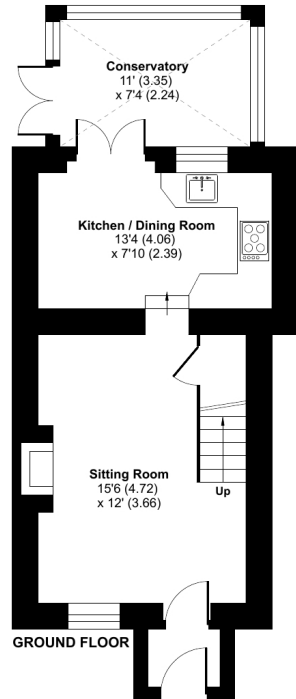

Floor plan produced in accordance with RICS Property Measurement Standards incorporating International Property Measurement Standards (IPMS2 Residential). © nichecom 2024. Produced for Cooper and Tanner. REF: 1144703



### Features

- Charming Village home
- Private parking
- Established front and rear gardens
- Extended at the rear
- Two bedrooms
- Fitted Kitchen
- Bathroom
- Close to Woodland walks
- Shearwater lake nearby
- Double glazed and electric heating

### Local Information

- Council Tax Band B
- Tenure Freehold
- EPC Rating E

#### WARMINSTER OFFICE

Telephone 01985 215579

48-50, Market Place, Warminster, Wiltshire BA12 9AN

[warminster@cooperandtanner.co.uk](mailto:warminster@cooperandtanner.co.uk)

**COOPER  
AND  
TANNER**

Important Notice: These particulars are set out as a general outline only for the guidance of intended purchasers and do not constitute, nor constitute part of, an offer or contract. All descriptions, dimensions, reference to condition and necessary permissions for use and occupation, warranties and other details are given without responsibility and any intending purchasers should not rely on the m as statements or rep representations of fact but must satisfy themselves by inspection or otherwise as to the correctness of each of them.

