



55 Riverbank Laleham Road, Surrey, STAINES-UPON- THAMES, TW18 2QF

VERY WELL PRESENTED & SPACIOUS TWO BEDROOM APARTMENT SITUATED IN THIS MUCH SOUGHT AFTER RIVERSIDE MANSION BLOCK IDEALLY LOCATED FOR TOWN CENTRE, MAINLINE TRAIN STATION & RIVER THAMES. The property benefits from a spacious lounge/diner with French doors to patio enjoying views over the well-kept communal grounds, separate fitted kitchen, two double bedrooms, modern white bathroom suite and a long lease. Viewings Highly Recommended!

ROOM DESCRIPTIONS

Communal Entrance

With security-entry door.

Entrance Hall

Recessed downlighters, power points, laminate wood-style flooring, two built-in storage cupboards, radiator.

Lounge/Diner

Garden aspect UPVC double glazed window and French doors to patio, light and power points, cast-iron fireplace with tiled hearth, stripped wooden floorboards.



Kitchen

Front aspect UPVC double glazed window, range of fitted units at eye and base level, laminate roll edged worktops, sink drainer unit, built-in oven and hob with extractor over, space for automatic washing machine and dishwasher, integrated fridge/freezer, partly tiled walls, light and power points.



Bedroom 1

Rear aspect UPVC double glazed window, light and power points, radiator.



Bedroom 2

Front aspect UPVC double glazed window, light and power points, radiator, built-in storage cupboard housing hot water tank and wall-mounted gas boiler.



ROOM DESCRIPTIONS

Bathroom

Front aspect UPVC double glazed window, white three piece bathroom suite comprising panel enclosed bath with shower over, low level W.C and wash hand basin inset to cabinet. Fully tiled walls, heated towel rail.



Outside

Patio Area

With low level brick wall, overlooking communal gardens.



Extensive Communal Riverside Grounds

Well-maintained communal lawn areas with extensive flower and shrub beds. Gated access to Tow path.



FLOORPLAN



Ground Floor

Approx. 60.9 sq. metres (656.0 sq. feet)

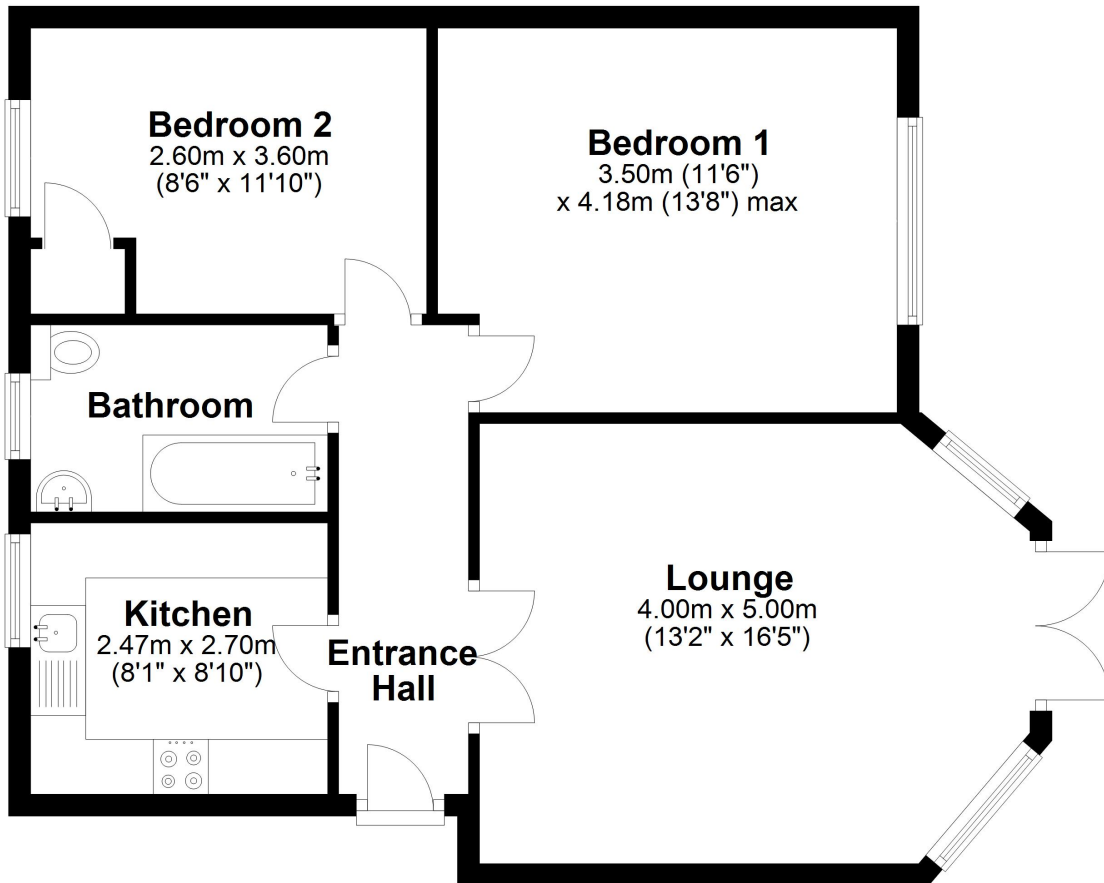

Total area: approx. 60.9 sq. metres (656.0 sq. feet)