



11 Hermitage Court Edgell Road, Staines-upon-Thames. TW18 2DR.
1 Bedroom Apartment - £210,000 Leasehold

11 Hermitage Court Edgell Road, Staines-upon-Thames. TW18 2DR.

01784 451458

1 Bedroom Apartment - £210,000 Leasehold

WELL PRESENTED AND SPACIOUS ONE BEDROOM APARTMENT IN SOUGHT AFTER DEVELOPMENT WITHIN MOMENTS OF TOWN CENTRE & STATIONS. The property benefits from a spacious lounge/diner, separate modern fitted kitchen, large double bedroom, modern white bathroom suite and a long lease. Viewings Highly Recommended!

Key Features

**WELL PRESENTED & SPACIOUS
GREAT LOCATION
WITHIN MOMENTS OF STAINES TOWN CENTRE & MAINLINE TRAIN STATION
WELL MAINTAINED DEVELOPMENT
LONG LEASE**

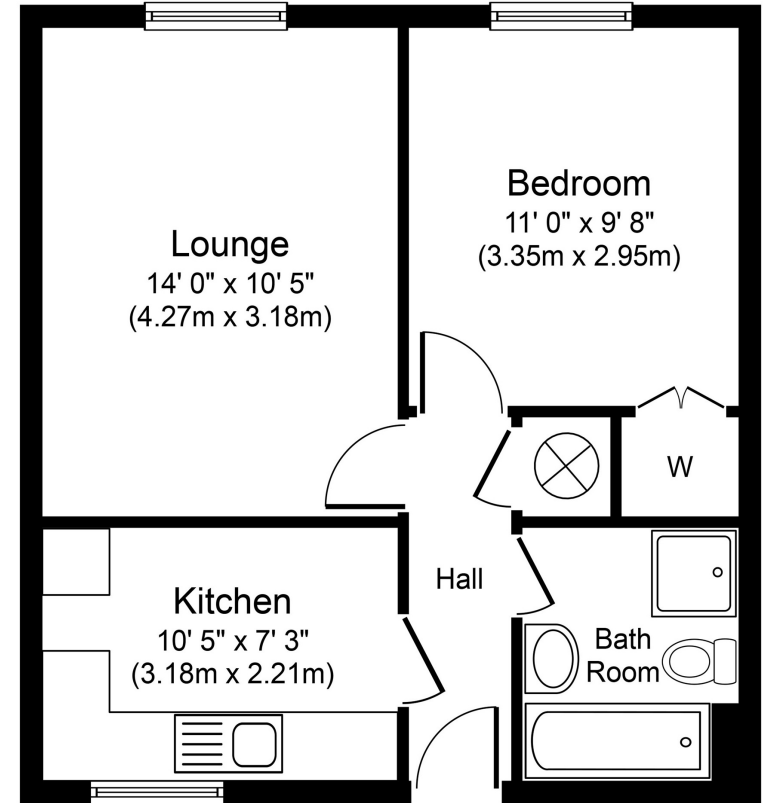

**Approximate Floor Area
429 sq. ft.
(39.9 sq. m.)**

Whilst every attempt has been made to ensure the accuracy of the floor plan contained here, measurements of doors, windows, rooms and any other items are approximate and no responsibility is taken for any error, omission, or mis-statement. This plan is for illustrative purposes only and should be used as such by any prospective purchaser or tenant. The services, systems and appliances shown have not been tested and no guarantee as to their operability or efficiency can be given.
Copyright V360 Ltd 2020 | www.houseviz.com



GREGORY BROWN
RESIDENTIAL SALES & LETTINGS



11 Hermitage Court Edgell Road, Staines-upon-Thames. TW18 2DR.

gregory-brown.co.uk

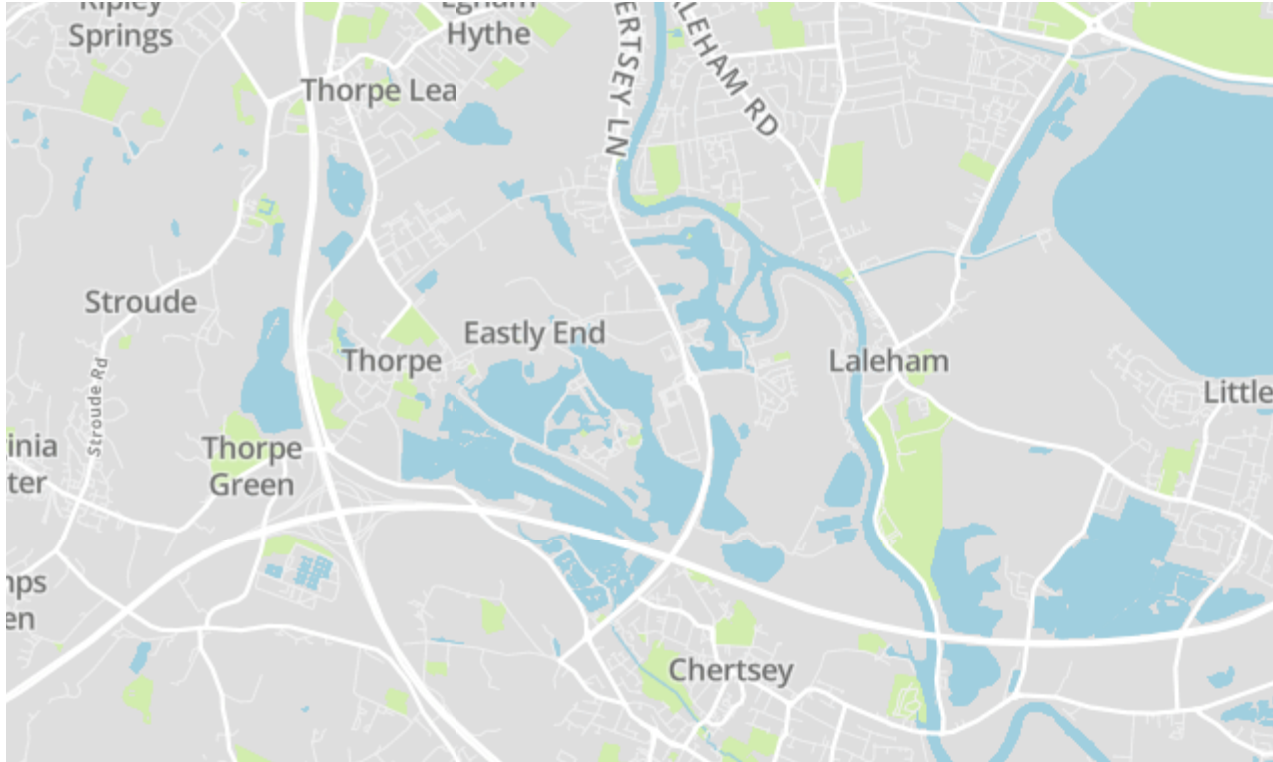

Tenure	Leasehold
Lease Term	100+ Years Remaining
Ground Rent	£100 PA
Service Charge	£500 PA 2024
Local Authority	
Council Tax	

We have prepared these property particulars as a general guide to a broad description of the property. They are not intended to constitute part of an offer or contract. We have not carried out a structural survey and the services, appliances and specific fittings have not been tested. All photographs, measurements, floorplans and distances referred to are given as a guide only and should not be relied upon for the purchase of carpets or any other fixtures or fittings. Lease details, service charges and ground rents (where applicable) and council tax are given as a guide only and should be checked and confirmed by your solicitor prior to exchange of contracts. The copyright of all details, photographs and floorplans remain exclusive to Gregory Brown.

