



This three bedroom detached family home is situated on a sought-after road within Taplow and within the catchment zones for both the highly acclaimed Lent Rise School and Burnham Grammar School. The property is offered to the market as superbly presented and includes a recently installed heating system.

The ground floor features a 24ft living/dining room, an adjoining conservatory, an 11ft fitted kitchen, a downstairs cloakroom and an entrance hall and porch.

To the first floor there are three bedrooms and a four piece family bathroom.

Externally, the rear garden is mainly laid to lawn and stretches to approximately 70ft and provides access to the garden store whilst to the front there is a driveway with parking for up to four cars in addition to a 19ft garage.

This property is an excellent family purchase due to its convenient location and generous size and comes onto the market with no onward chain.

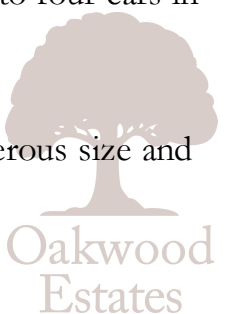

Property Information

	THREE BEDROOM DETACHED HOUSE		LENT RISE SCHOOL / BURNHAM GRAMMAR CATCHMENT ZONES
	24FT LIVING/DINING ROOM		CONSERVATORY
	FOUR PIECE BATHROOM		DOWNSTAIRS CLOAKROOM
	19FT DETACHED GARAGE		70FT (APPROX.) GARDEN
	PARKING FOR 4 CARS		NO CHAIN

					
x3	x1	x1	x4	Y	Y
Bedrooms	Reception Rooms	Bathrooms	Parking Spaces	Garden	Garage

External

The rear garden is mainly laid to lawn and stretches to approximately 70ft and provides access to the garden store whilst to the front there is a driveway with parking for up to four cars in addition to a 19ft garage.

Location

Burnham and Taplow stations are served by Crossrail. 'The Elizabeth Line' travels through London connecting Reading in the west and to Shenfield in the east meaning the heart of the West End (Bond Street) is just 38 minutes away. There are excellent road links providing easy access to the M4 and M25.

The Bishop Centre is close by with a wide range of lifestyle retail stores including Tesco's. Sainsbury's and Waitrose also have stores within a mile of the development. Maidenhead town centre provides a wealth of national and local shops in and around the Nicholson Shopping Centre, as well as sports facilities and night-life venues.

Water dominates the area, the River Thames at Maidenhead is picturesque and attractive to walk along or a magnet for water sports - rowers, barges and pleasure boats. The Thames Maidenhead Rowing Club has its base nearby and the purpose-built rowing venue at Dorney Lake is to the south. There are several good golf courses within a few miles and the village has its own Cricket Club. The area is designated green belt with beautiful Burnham Beeches close by.

Transport Links

Nearby Stations:

- Burnham (0.7 mi)
- Taplow (0.8 mi)
- Maidenhead (2.7 mi)

Council Tax

Band E

Floor Plan

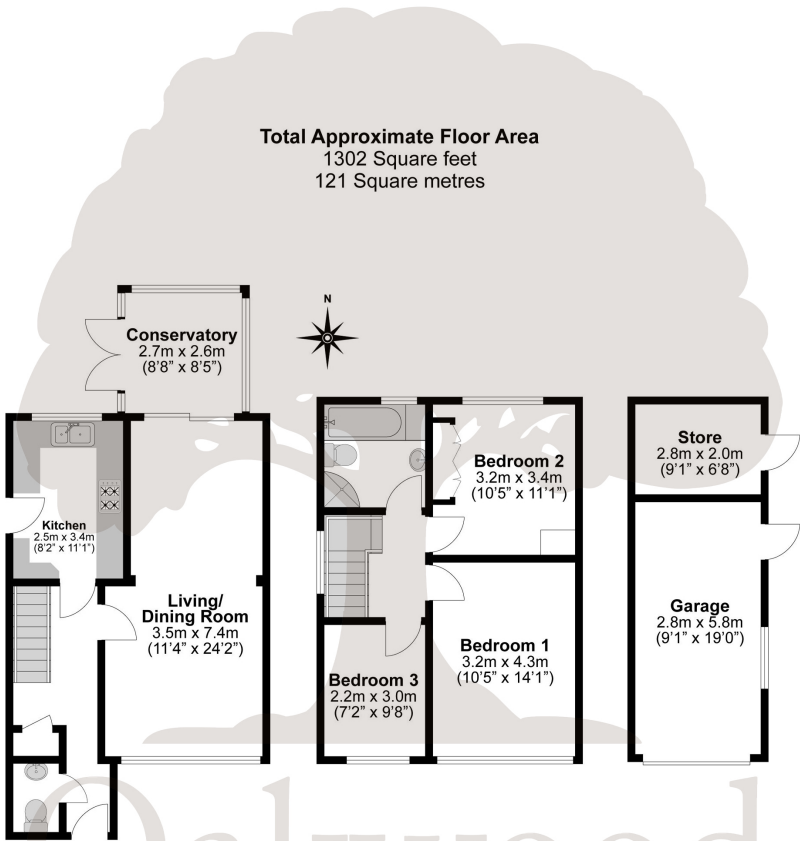

Illustrations are for identification purposes only, measurements are approximate, not to scale.

Prospective purchasers should be aware that these sales particulars are intended as a general guide only and room sizes should not be relied upon for carpets or furnishing. We have not carried out any form of survey nor have we tested any appliance or services, mechanical or electrical. All maps are supplied by Goview.co.uk from Ordnance Survey mapping. Care has been taken in the preparation of these sales particulars, which are thought to be materially correct, although their accuracy is not guaranteed and they do not form part of any contract.

