

PLOT 46 HAMPTON WOODS, PETERBOROUGH. PE7 8UT

£245,000

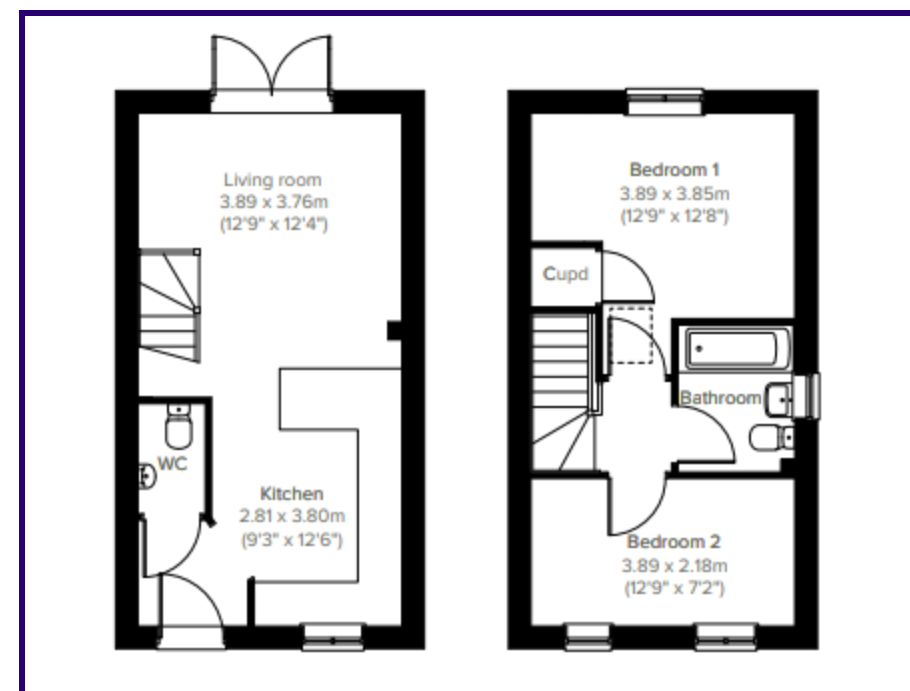

PENNELL & PARTNERS

Pennell & Partners, 5 Cross Street, Peterborough, PE1 1XA - 01733 209222 - hello@pennellandpartners.co.uk

ABOUT THE PROPERTY

NEW BUILD

Brand New Build: Be the first to enjoy this immaculate new build, featuring high-quality finishes and a contemporary layout.

Modern Kitchen: The fully fitted kitchen is a highlight, a convenient breakfast bar, and a stylish sink—perfect for entertaining or enjoying casual meals.

Open Plan Living: The first floor offers an open plan living area that maximizes space and light, with French doors leading to a private and enclosed rear garden—ideal for relaxing or hosting outdoor gatherings.

Convenient Downstairs W/C: A handy downstairs W/C adds to the practicality of the ground floor layout.

Two Generous Bedrooms: Upstairs, you'll find two well-proportioned bedrooms offering plenty of space for rest and relaxation.

Well-Equipped Family Bathroom: The family bathroom is fitted with modern fixtures, providing a comfortable and stylish space.

This property is perfectly suited for those seeking a contemporary lifestyle in a vibrant community. Don't miss out on this rare opportunity to own a stunning new build in one of Peterborough's most popular areas. Contact us today to arrange a viewing and make this house your new home

EPC Rating:



ENTRANCE HALL

W/C

.993m x 1.611m (3' 3" x 5' 3")

KITCHEN/DINER/LOUNGE

7.515m x 3.887m (24' 8" x 12' 9")

FIRST FLOOR LANDING

FAMILY BATHROOM

1.701m x 2.154m (5' 7" x 7' 1")

MASTER BEDROOM

3.882m x 3.004m (12' 9" x 9' 10")

BEDROOM TWO

3.888m x 2.147m (12' 9" x 7' 1")

DRIVEWAY

BLOCK PAVE DRIVEWAY WITH ALOCATED PARKING FOR ONE/TWO CAR(S).
SIDE ACCESS TO REAR GATE LEADING TO REAR GARDEN

REAR GARDEN

LAWN (TO BE) THROUGHOUT.
ENCLOSED BY NEW FENCING.
SIDE GATE ACCESS AND FRECH DOORS OPENING FROM LOUNGE/DINING AREA