



**Shawfield Park,**  
Bickley, Kent. BR1 2NQ



**Tenure: Freehold**

**6 Bedrooms | 3 Reception Rooms | 3 Bathrooms**

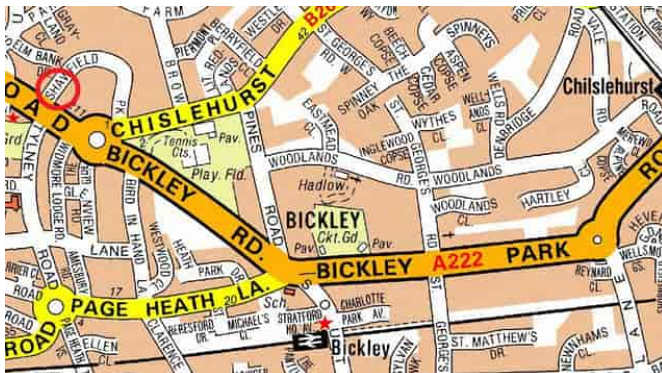

Set in this highly regarded residential road amidst similar age and style properties is this exquisitely appointed and skilfully enlarged four bedroomed house with additional self-contained two storey, two bedroom, two bathroom annexe. Presented in our opinion in excellent order throughout this handsome home provides versatile and flexible accommodation offering a rare opportunity for multi-generational living/nanny or au pair, or revision to a single detached home. This home is also suitable in our opinion, for further enlargement, subject to the usual consents. EPC Rating: TBA

**Enquiries To:**

**T: 020 8467 2252**

**E: beosales@georgeproctor.com**



**The Bickley Estate Office**

**Southborough Road, Bickley, Kent, BR1 2EB**

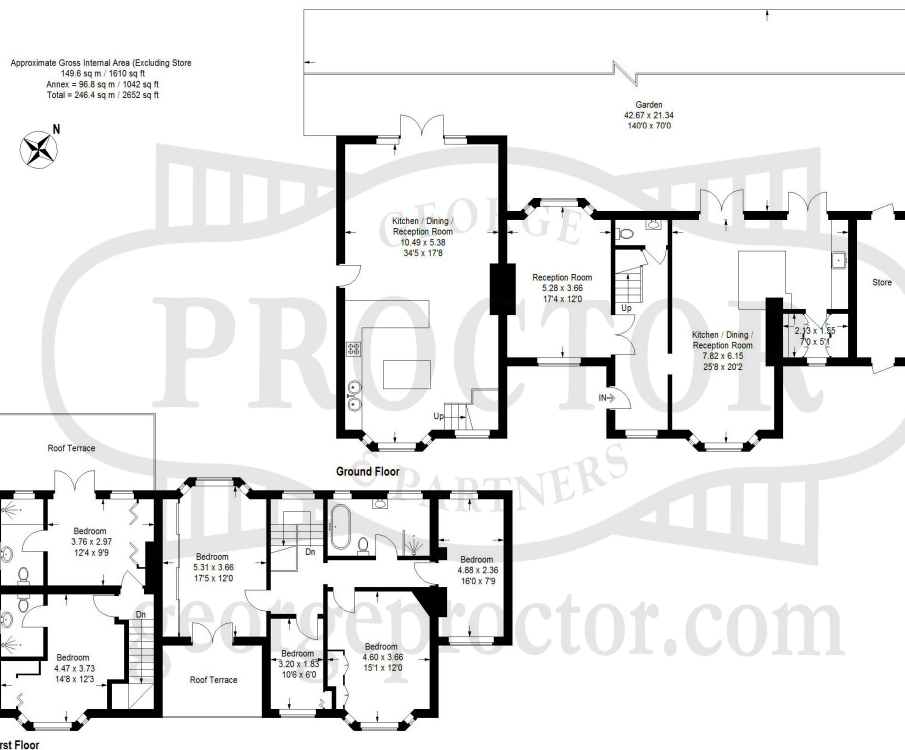

These particulars whilst believed to be accurate are made without responsibility on the part of the vendor or agents, their accuracy is not guaranteed nor do they form part of any contract and no warranty is given. Services or appliances have not been tested and no guarantee can be given as to their operation, buyers should seek professional advice where necessary. All measurements are approximate and may be rounded to the nearest three inches (10 cm). Floor plans, where shown, are indicative only. Any photographs included may be taken with the use of a wide angle lens. If there is a matter of particular interest please contact us for further information, especially before travelling any distance to view. Map reproduced by permission of Geographers A-Z Map Co Ltd. Licence No. A0514. This map is based upon Ordnance Survey maps with the permission of the controller of Her Majesty's Stationary Office.