



## 14 Stevenson Court, Douglas, Isle of Man . IM2 2EH

Purpose built two bedroom apartment situated in a great location within Farmhill. This first floor purpose-built apartment is an ideal choice for first-time buyers, those looking to downsize or investors. Located in a popular residential area and convenient for all amenities and schools.



**£220,000 Leasehold**

## PROPERTY DESCRIPTION

---

A spacious purpose-built first floor apartment situated in a convenient and sought-after location on Stevenson Way, Farmhill. Offering excellent potential, this well-proportioned home would benefit from some updating.

**ACCOMODATION** Two double bedrooms, including a main bedroom with ensuite shower room, providing comfortable and flexible living space. Living/dining room with access to a private south-west facing balcony, ideal for morning coffee. Kitchen with practical layout ready for modernisation and personal style improvements. Family bathroom serving the second bedroom and guests. Communal gardens, offering pleasant outdoor space for residents to enjoy. Allocated off-street parking. Ideally situated close to local schools, shops and amenities, with good transport links nearby, this apartment is well suited to first-time buyers, those looking to downsize, or investors seeking a property in a well-established residential location.

## FEATURES

---

- First Floor Purpose Built Apartment
- Close to Schools, Shops and Business Park
- Lounge with Access to Private Balcony
- Fitted Kitchen with Utility Area
- 2 Bedrooms and 2 Bathrooms (1 En-Suite)
- Well Maintained Communal Gardens
- Allocated Parking Space
- No Onward Chain





## Property Images

---



## FLOORPLAN



GROUND FLOOR  
629 sq.ft. (58.4 sq.m.) approx.

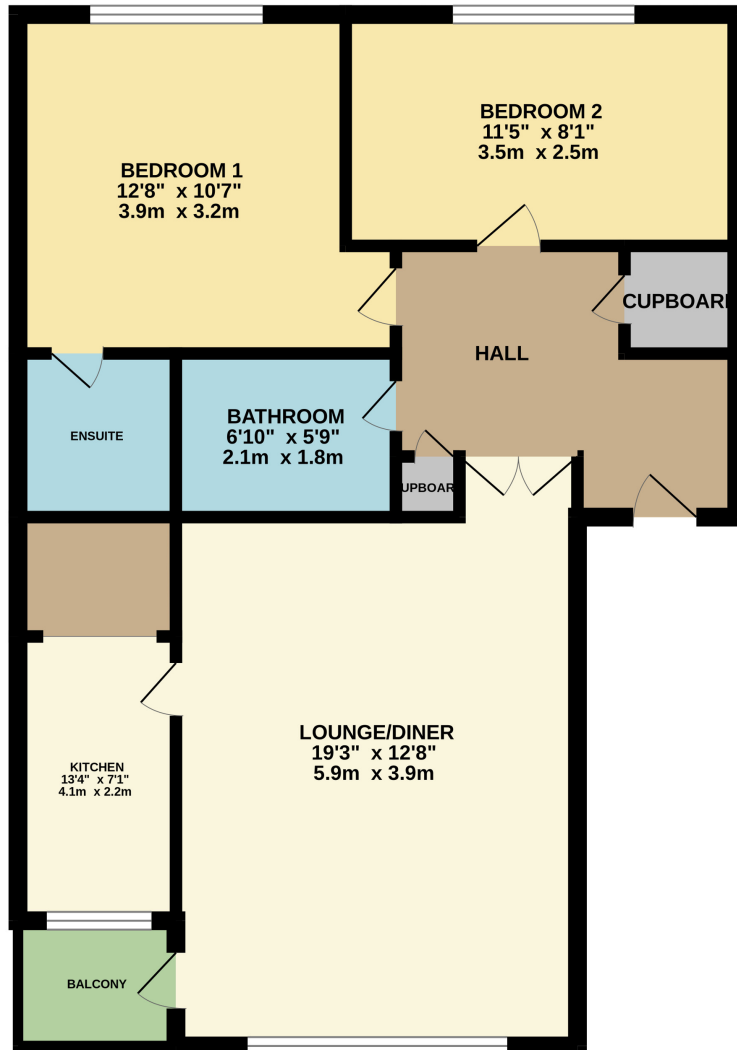

TOTAL FLOOR AREA : 629 sq.ft. (58.4 sq.m.) approx.

Whilst every attempt has been made to ensure the accuracy of the floorplan contained here, measurements of doors, windows, rooms and any other items are approximate and no responsibility is taken for any error, omission or mis-statement. This plan is for illustrative purposes only and should be used as such by any prospective purchaser. The services, systems and appliances shown have not been tested and no guarantee as to their operability or efficiency can be given.  
Made with Metropix ©2025

**DISCLAIMER:** Whilst Manxmove Ltd believe that these details are correct, neither Manxmove Ltd or their clients guarantee their accuracy in any way. Consequently, these details are not to be used to form part of any legally binding contract. Prospective purchasers or tenants are advised to visit this property to satisfy themselves as to the correctness of these details. Please note, we use wide angle camera lenses in order to show as much of each room as possible. This is not intended to mislead any prospective purchasers or tenants in any way and an honest verbal description is always available prior to viewing if required.

Manxmove Estate Agents - Douglas  
Victoria Road, Douglas, IM2 4HD  
01624 619966  
info@manxmove.im