



Tudhoe House Tudhoe Village, Durham. DL16 6LG

Tudhoe House presents an outstanding and elegant country house situated on the beautiful village green and conservation area, within the picturesque village of Tudhoe. A Grade II listed property set within approximately one acre of landscaped gardens offering a good degree of privacy to enjoy a peaceful setting to call home. The vast accommodation is beautifully presented throughout with many original features, including original grand fire surrounds and detailed decorative coving, offering a charming home full of character as well as many modern features including a stylish kitchen with Aga cooking range, a games room complete with snooker table, six double sized bedrooms and cellars. Viewing is truly essential.



£850,000

PROPERTY DESCRIPTION

Tudhoe House is a Georgian manor house dating back to 1825 set within approximately one acre of landscaped private grounds. Elegant interiors enhance the original charm and detail of this most wonderful Grade II listed manor house. The accommodation briefly comprises of generous sized reception rooms with period fireplaces, an open plan kitchen and dining area with an extensive range of maple wood cabinets along with a dining area with vistas towards the village green. A formal drawing room is situated to the rear aspect with an imposing bay window with views over the garden.

The Georgian staircase leads to the first floor providing five spacious double bedrooms and a house bathroom.

The second floor presents a versatile space currently utilised as an entertaining and games room with bar and charming features. There is also a spacious sixth bedroom with en-suite bathroom facility.

Externally the property enjoys a private setting, and is entered with double gates providing access in to a courtyard leading to large garage block and workshop. The property is set within exquisite mature grounds of approximately one acre, including an extensive area of formal lawn, mature shrubs and extensive varieties of mature trees. To the south west corner of the formal gardens is a bespoke gazebo with lighting, BBQ providing superb al-fresco entertaining space.

Tudhoe House is a most rare opportunity to acquire a beautiful country manor house, set within a picturesque village setting and yet within close proximity of Durham City and ease of commuting across the region.

Viewing Arrangements

Please contact Jan Dale directly for an accompanied viewing.

FEATURES

- Exceptional Mansion House
- Grade II Listed Building Status
- Beautiful Private Landscaped Gardens
- Situated within a Quaint Village Setting
- Grand and Elegant Throughout
- Six Double Bedrooms
- Viewing Truly is Essential



ROOM DESCRIPTIONS



FLOORPLAN



Tudhoe House, Tudhoe Village DL16 6TG
 TOTAL APPROX. FLOOR AREA 454 SQ.M
 Measurements shown are approximate and no responsibility is taken for any error, omission, or misstatement.
 This plan is for illustrative purposes only and should be used as such by any prospective purchaser.

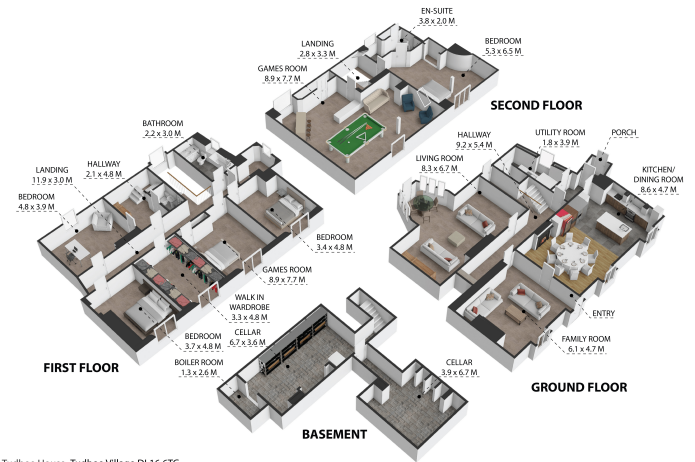

Tudhoe House, Tudhoe Village DL16 6TG
 TOTAL APPROX. FLOOR AREA 454 SQ.M
 Measurements shown are approximate and no responsibility is taken for any error, omission, or misstatement.
 This plan is for illustrative purposes only and should be used as such by any prospective purchaser.

Newcastle upon Tyne
 65, Quayside, Newcastle upon Tyne, NE1 3DE
 0845 6431186
 info@urban-base.com