



hastings
INTERNATIONAL

Foreshore

£495,000

Foreshore, London SE8 3AQ

A beautifully presented triple aspect apartment with two double bedrooms, period features and garden views located within a historic Grade II listed building on Deptford's Waterfront enjoying close proximity to the river Thames, Pepy's Park, Deptford High Street and Deptford mainline train [7mins London Bridge, 17mins City Thameslink and 24mins London St Pancras].

Occupying part of the second floor within a period conversion, this impressive triple aspect apartment comprises entrance hall with fitted storage cupboards, generous dual aspect reception room with Georgian style windows providing lots of natural light, garden views, wooden floorboards, dining area, bespoke open plan fitted kitchen with stainless steel work tops and integrated appliances, master bedroom, guest bedroom two and bathroom. Offering riverside living amidst Deptford's thriving cultural scene, this fabulous apartment is positioned within a handsome period building on Deptford's Waterfront, located moments from the river, Pepy's Park and mainline station.

- Foreshore SE8
- Two Double Bedrooms
- Family Bathroom
- Access To Communal Gardens
- Dual Aspect Reception Room
- Open Plan Fitted Kitchen
- Period Features
- Excellent location

Foreshore, SE8

Approx. Gross Internal Area 667 Sq Ft - 61.96 Sq M

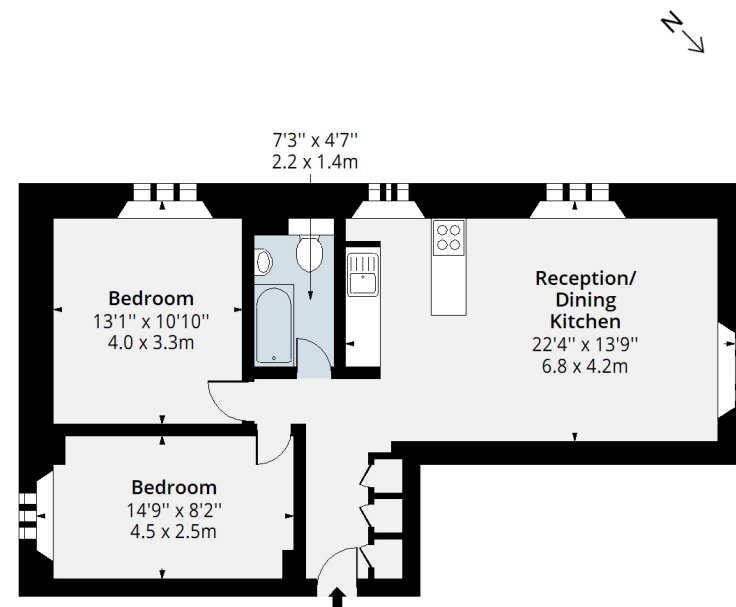

Second Floor

Floor Area 667 Sq Ft - 61.96 Sq M

This plan is not to scale and must be used as layout guidance only. All measurements and areas are approximate and should not be relied upon to provide accurate information. This plan must not be relied upon when making property valuations, design considerations or any other such relevant decisions. We accept no responsibility or liability (whether in contract, tort or otherwise) in relation to any loss whatsoever arising from or in connection with any use of this plan or the adequacy, accuracy or completeness of it or any information within it.



