



Day & Co
ESTATE AGENTS

28 Cavendish Street

Keighley

BD21 3RG



24 Nessfield Drive, Keighley,
West Yorkshire, BD22 6NP

£160,000

T: 01535 664609

W: www.dayandcoestateagents.co.uk

E: keighley@dayandcoestateagents.co.uk

- Awaiting EPC
- Three Bedrooms
- Front & Rear Gardens

- Semi-Detached Property
- In Need Of Modernisation
- Drive & Garage/NO CHAIN

SUMMARY

****A 3 BEDROOM SEMI-DETACHED PROPERTY, POPULAR RESIDENTIAL LOCATION OF EXLEY HEAD WITH EXCELLENT ACCESS TO LOCAL SCHOOLS!**** In need of modernisation, front & rear gardens, drive, garage - OFFERED FOR SALE WITH NO ONWARD CHAIN!! Awaiting EPC.

FULL DESCRIPTION

Offered for sale is this three bedroom semi-detached property situated in the popular residential location of Exley Head with excellent access to local schools. The property is in need of modernisation and the accommodation comprises of an entrance hall, through lounge/diner having double glazed sliding doors to the rear and an electric fire, two radiators. The kitchen has a range of base and wall mounted units, double glazed window to the rear and radiator. To the first floor there are three bedrooms and a shower room having shower cubicle, WC, wash hand basin. Externally there are gardens to the front and rear, a driveway and single garage. Offered for sale with no onward chain, awaiting EPC.

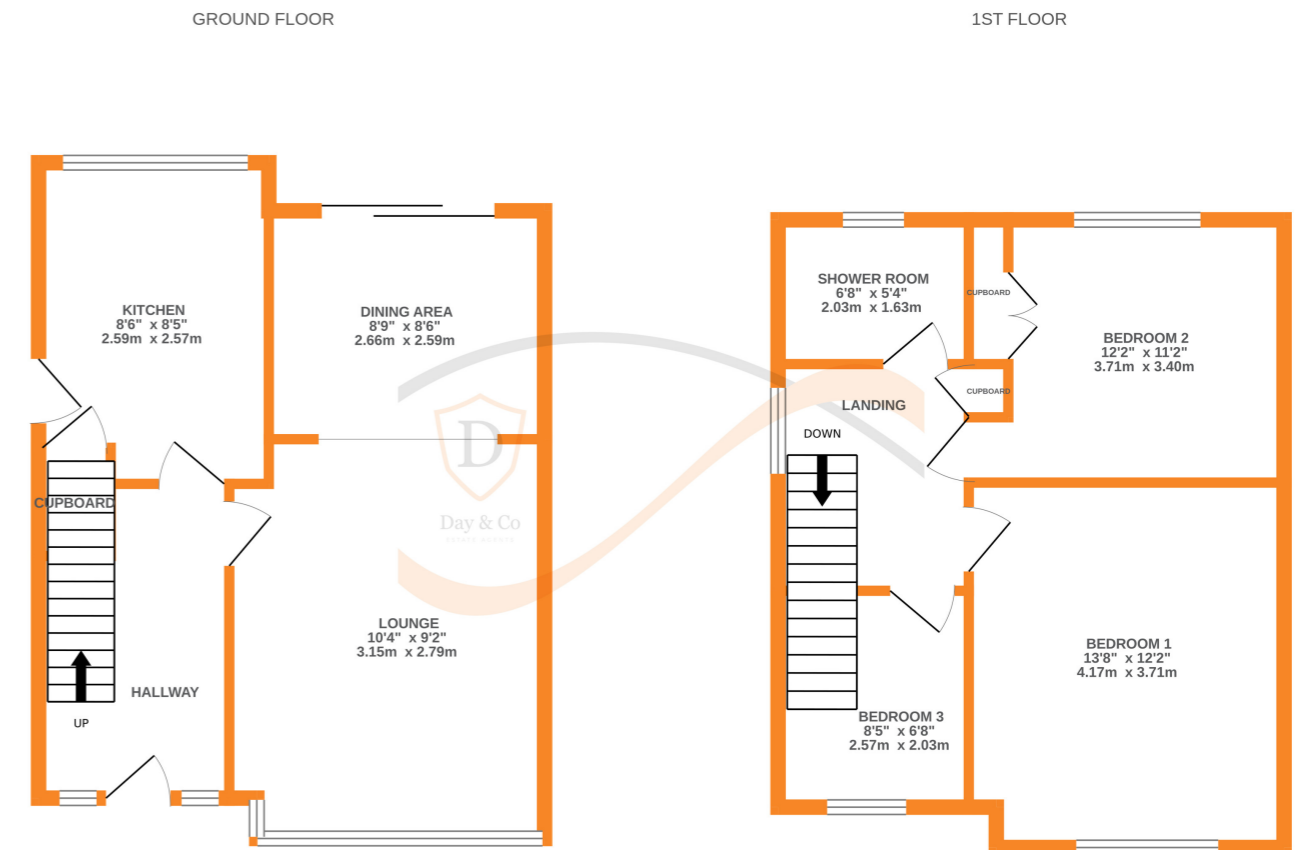

Whilst every attempt has been made to ensure the accuracy of the floorplan contained here, measurements of doors, windows, rooms and any other items are approximate and no responsibility is taken for any error, omission or mis-statement. This plan is for illustrative purposes only and should be used as such by any prospective purchaser. The services, systems and appliances shown have not been tested and no guarantee as to their operability or efficiency can be given.
Made with Metropix ©2024