



Les Parapluies

Rue De La Neuve Maison | St Saviour |

Les Parapluies is a beautiful 3/4 bedroom detached chalet bungalow which sits in a quiet lane in the rural Parish of St Saviour. Comprises:- entrance hall, large sitting/dining room, kitchen/diner, utility, shower room, bedroom 4/study, master bedroom suite with dressing room and en-suite bathroom, 2 further bedrooms and family bathroom. Externally the property boasts a double garage and ample parking to the front with a good size garden and patio area ideal for al fresco dining at the rear. Gardening included in rent. Regret not suitable for smokers or sharers. Cat at Landlord's discretion.

£3,000 pcm

4 BEDROOMS

3 BATHROOMS

1 RECEPTION

PHOTOS



PHOTOS





SPECIFICATIONS

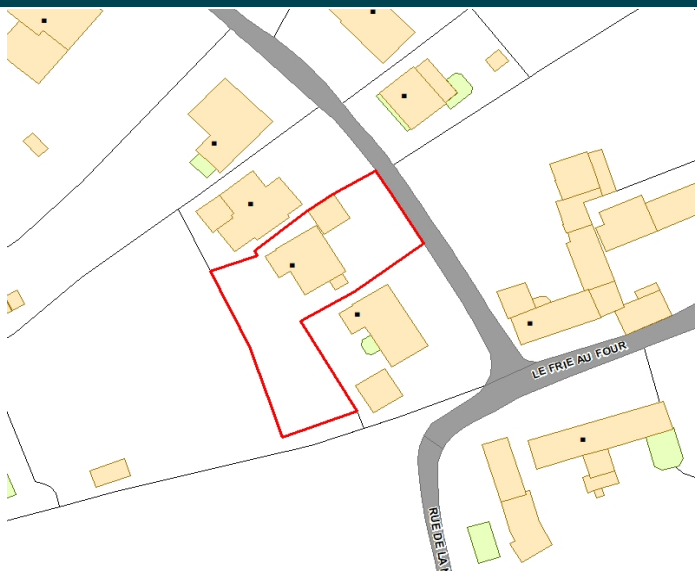

Entrance Hall

4.50m x 4.04m (14' 9" x 13' 3")

Dining Area

5.89m x 3.62m (19' 4" x 11' 11")

Lounge

5.79m x 3.01m (19' 0" x 9' 11")

Kitchen

4.20m x 3.00m (13' 9" x 9' 10")

Utility Room

1.93m x 1.51m (6' 4" x 4' 11")

Bedroom 4/Study

3.04m x 2.70m (10' 0" x 8' 10")

Shower Room

2.66m x 1.19m (8' 9" x 3' 11")

First Floor Landing

3.80m x 2.25m (12' 6" x 7' 5")

Master Bedroom

4.44m x 4.39m (14' 7" x 14' 5")

Dressing Room

3.75m x 1.42m (12' 4" x 4' 8")

En-Suite Bathroom

2.75m x 1.67m (9' 0" x 5' 6")

Bedroom 2

3.22m x 3.01m (10' 7" x 9' 11")

Bedroom 3

3.02m x 2.90m (9' 11" x 9' 6")

Family Bathroom

2.70m x 2.25m (8' 10" x 7' 5")

Garden

To the rear of the property is a good sized garden laid to lawn with a patio area ideal from al fresco dining.

Parking

In addition to the double garage, there is parking for several vehicles.

PRICE INCLUDES

- Carpets/flooring as fitted
- Blinds/curtains
- Light fittings

SPECIAL FEATURES

- Quiet location
- Double glazed
- Spacious accommodation
- Good storage
- Ample parking

SERVICES

Mains water, electricity and drainage.

APPLIANCES INCLUDED

- Four ring hob
- Oven
- Extractor fan

SCHOOL CATCHMENT

La Houquette Primary School and La Mare de Carteret High School

GROUND FLOOR

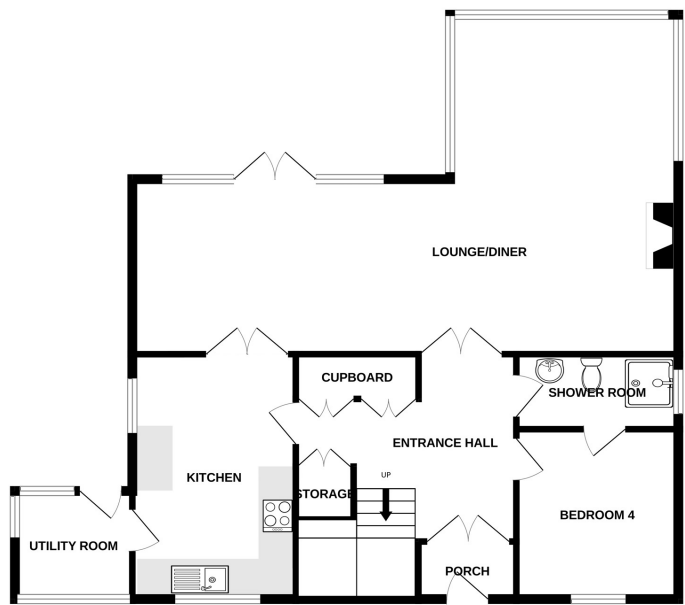

1ST FLOOR



LES PARAPLUIES

Whilst every attempt has been made to ensure the accuracy of the floorplan contained here, measurements of doors, windows, rooms and any other items are approximate and no responsibility is taken for any error, omission or mis-statement. This plan is for illustrative purposes only and should be used as such by any prospective purchaser. The services, systems and appliances shown have not been tested and no guarantee as to their operability or efficiency can be given.
Made with Metropix ©2023