

FOR SALE

Heathfield Road,
Mill Hill Conservation Area, W3

Flat
Mill Hill Conservation Area

£400,000 lh

1  1  1 



**horton
andgarton**

SALES / LETTINGS / PROPERTY MANAGEMENT

hortonandgarton.co.uk | Sales 020 3989 6464 | Lettings 020 3989 5454
161 Chiswick High Road, London, W4 2DT



FOR SALE

Heathfield Road,
Mill Hill Conservation Area, W3

Flat
Mill Hill Conservation Area

£400,000 lh

1  1  1 



**horton
andgarton**

SALES / LETTINGS / PROPERTY MANAGEMENT

hortonandgarton.co.uk | Sales 020 3989 6464 | Lettings 020 3989 5454
161 Chiswick High Road, London, W4 2DT



FOR SALE

Heathfield Road,
Mill Hill Conservation Area, W3

Flat
Mill Hill Conservation Area

£400,000 lh

1  1  1 



**horton
andgarton**

SALES / LETTINGS / PROPERTY MANAGEMENT

hortonandgarton.co.uk | Sales 020 3989 6464 | Lettings 020 3989 5454
161 Chiswick High Road, London, W4 2DT



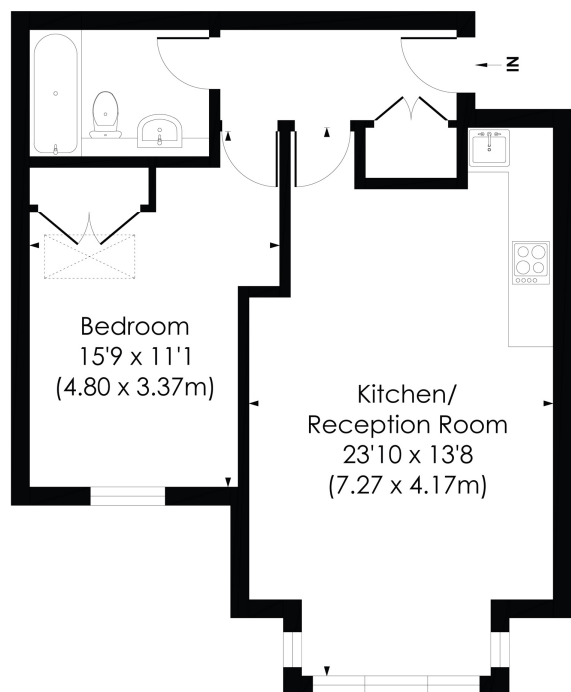

GROUND FLOOR

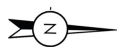

HEATHFIELD ROAD, W4

Approx. Gross Internal Floor Area
547 Sq' / 50.79 SqM

**horton
and garton**

© Pixangle Property Marketing Ltd. info@pixangle.com Tel: 0208 870 2118

This floor plan has been prepared for the purpose of illustration only in accordance with the latest RICS code of measuring practice and is not to scale. All measurements and areas are approximate and whilst every effort has been made to ensure the accuracy of the plan contained here, no responsibility is taken for any error, omission or misstatement.

Victorian conversion | One bedroom - One bathroom |
547 Sq' - 50.79 SqM | Superbly presented flat | EPC
rating C | Mill Hill Conservation Area



hortonandgarton.co.uk
Sales 020 3989 6464
Lettings 020 3989 5454

161 Chiswick High Road, London, W4 2DT