



Ideally located on a premier road in the heart of the village of Datchet, this four bedroom detached family home in excess of 2100sq.ft. offers considerable scope for remodelling and extending (STTP). To the ground floor the property comprises, a dual aspect through lounge in excess of 25 ft. with patio doors to the enclosed rear garden, a 16ft dining room, kitchen, entrance hall, cloakroom, and a 17ft annexe. To the first floor there are three double bedrooms, a single bedroom, bathroom and separate W.C. The rear garden is mainly laid to lawn with a patio area and side access. To the front, a large driveway allowing for ample parking and a double garage. This property is offered to the market with NO ONWARD CHAIN and is situated in the catchment area for local grammar schools making it an ideal family home.





Property Information

-  **FOUR BEDROOM DETACHED FAMILY HOME**
-  **SHORT WALK TO DATCHET GREEN/STATION (WATERLOO LINE)**
-  **POTENTIAL TO EXTEND (S.T.P.P)**
-  **DRIVEWAY PARKING**
-  **LOCATED ON A HIGHLY SOUGHT-AFTER ROAD**
-  **COUNCIL TAX - BAND G**
-  **DOUBLE GARAGE**

					
x4	x2	x1	x3	Y	Y
Bedrooms	Reception Rooms	Bathrooms	Parking Spaces	Garden	Garage

**External**

Front garden, ample driveway parking with side access to rear garden, double garage. Rear garden is laid to lawn with a patio area.

**Schools**

**PRIMARY SCHOOLS:**

Datchet St Mary's CofE Primary School  
0.1 miles away State school

Eton End School Trust (Datchet) Limited  
0.7 miles away Independent school

St George's School  
1.2 miles away Independent school

Castleview Primary School  
1.3 miles away State school

**SECONDARY SCHOOLS:**

Churchmead Church of England (VA) School  
0.3 miles away State school

Ditton Park Academy  
1.2 miles away State school

Long Close School  
1.4 miles away Independent school

**Transport Links**

Nearest stations:

Datchet (0.1 mi)  
Windsor & Eton Riverside (1.2 mi)  
Sunnymeads (1.2 mi)

**Council Tax**  
Band G

Floor Plan

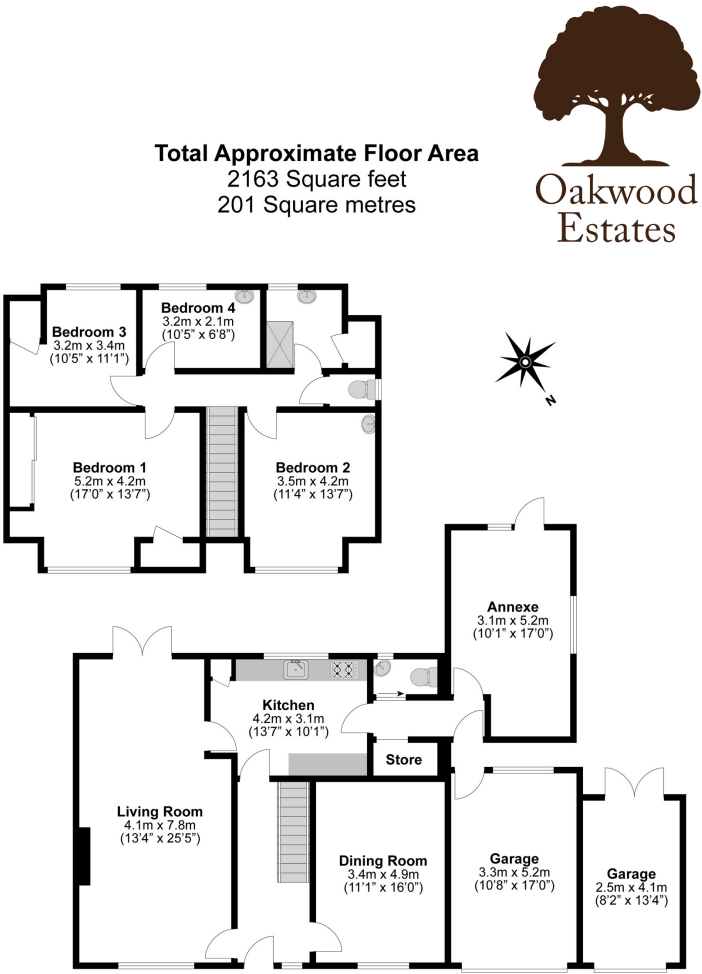

Illustrations are for identification purposes only, measurements are approximate, not to scale.

Prospective purchasers should be aware that these sales particulars are intended as a general guide only and room sizes should not be relied upon for carpets or furnishing. We have not carried out any form of survey nor have we tested any appliance or services, mechanical or electrical. All maps are supplied by Goview.co.uk from Ordnance Survey mapping. Care has been taken in the preparation of these sales particulars, which are thought to be materially correct, although their accuracy is not guaranteed and they do not form part of any contract.

