

Birchall Avenue, Culcheth, WA3 4DB £425,000

Offers Over

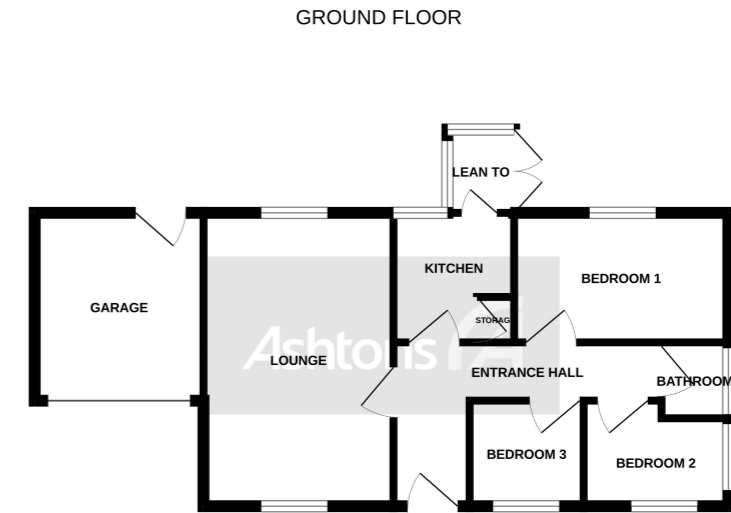

While every attempt has been made to ensure the accuracy of the floorplan contained here, measurements of floors, walls, rooms and any other items are approximate and no responsibility is taken for any error, omission or mis-statement. This plan is for illustrative purposes only and should be used as such by any prospective purchaser. The accuracy, systems and equipment shown have not been tested and no guarantee as to live capability or efficiency can be given. Made with Metreplan CS202



This charming and spacious three bedroom detached bungalow is located on Birchall Avenue, a quiet and sought-after residential street in the desirable village of Culcheth. The property sits on a generous plot with well-maintained front and rear gardens, offering plenty of outdoor space for relaxing and entertaining.

 x 3  x 1

See more of this house at [ashtons.net](https://www.ashtons.net)

