



Banister Road, London, W10

£2,500
pcm



Banister Road, London, W10

Located on the top floor (with lift) of City View and offering spectacular views of London is this modern and well presented two double bedroom, two bathroom apartment found in the heart of Kensal Rise. Key features include a balcony, access to a stunning communal roof terrace as well as a secure allocated parking space.

*Kindly note a surcharge of circa £60 per month will be added to the rent for gas (which is included within the service charge of the building).

City View is perfectly positioned with both Kensal Green station (Bakerloo Line & Overground) and Kensal Rise station (Overground) situated close by, along with Queen's Park station (Bakerloo Line & Overground). Furthermore, local amenities, restaurants and bars can be found just yards away, including Moberly Sports Centre, the Lexi Cinema, Queen's Park and the Grand Union Canal.

Features

- Allocated Parking Space
- Balcony
- Offered Furnished
- Available Now
- Top Floor With Spectacular Views
- Modern & Well Presented
- Access To A Stunning Communal Roof Terrace
- Found In The Heart Of Kensal Rise
- Two Double Bedrooms
- Two Bathrooms



Banister Road,
London, W10

City View,
Banister Road, W10

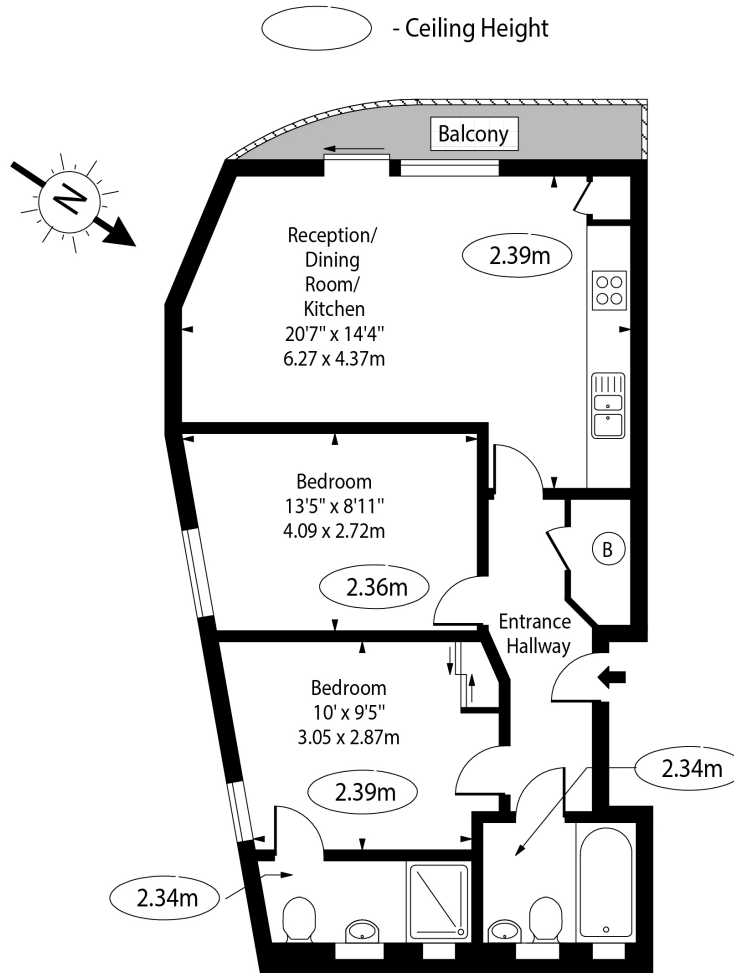

Seventh Floor

Approx Gross Internal Area 658 Sq Ft - 61.13 Sq M

For Illustration Purposes Only - Not To Scale Floor Plan by www.nogaphotostudio.com Ref: No.51939

This floor plan should be used as a general outline for guidance only. Any intending purchaser or lessee should satisfy themselves by inspection, searches, enquiries and full survey as to the correctness of each statement. Any areas, measurements or distances quoted are approximate and should not be used to value a property or be the basis of any sale or let.