



THE ESTATE AGENTS  
1977





**Cavendish Drive, Northampton NN3 3DH**  
**Offers Over £300,000 - Freehold**



## PROPERTY DESCRIPTION

The Estate Agents are pleased to present this spacious three bedroom, extended, detached property in the highly desirable and sought after area of Abington Vale. The well presented accommodation, briefly comprises; entrance porch, living room and open plan family/dining room, kitchen and utility room. On the first floor are three generous bedrooms and a large family bathroom. Outside the property benefits from a front garden offering off road parking which leads to the garage. The rear garden is low maintenance mainly laid to patio and an artificial lawn.

Abington Vale is a highly desirable area close to Abington Park, sought after primary & secondary schools and local amenities.

Northampton Town Centre, General Hospital and Train Station are all within easy reach and Abington Vale has fantastic road links with the A43/A45 and M1. Northampton has a regular service to London Euston in under an hour.

## POINTS OF INTEREST

- 3 Bedroom Detached
- Extended
- Garage
- Lovely Dining/Family Room
- Off Road Parking
- Front And Rear Gardens
- Utility Room
- Highly Desirable And Sought After Area Of Abington Vale

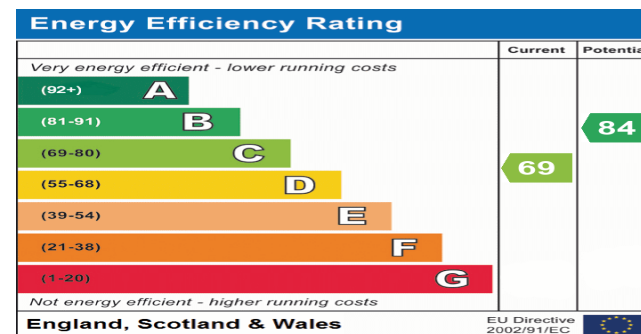

GROUND FLOOR  
605 sq.ft. (56.2 sq.m.) approx.

1ST FLOOR  
422 sq.ft. (39.2 sq.m.) approx.

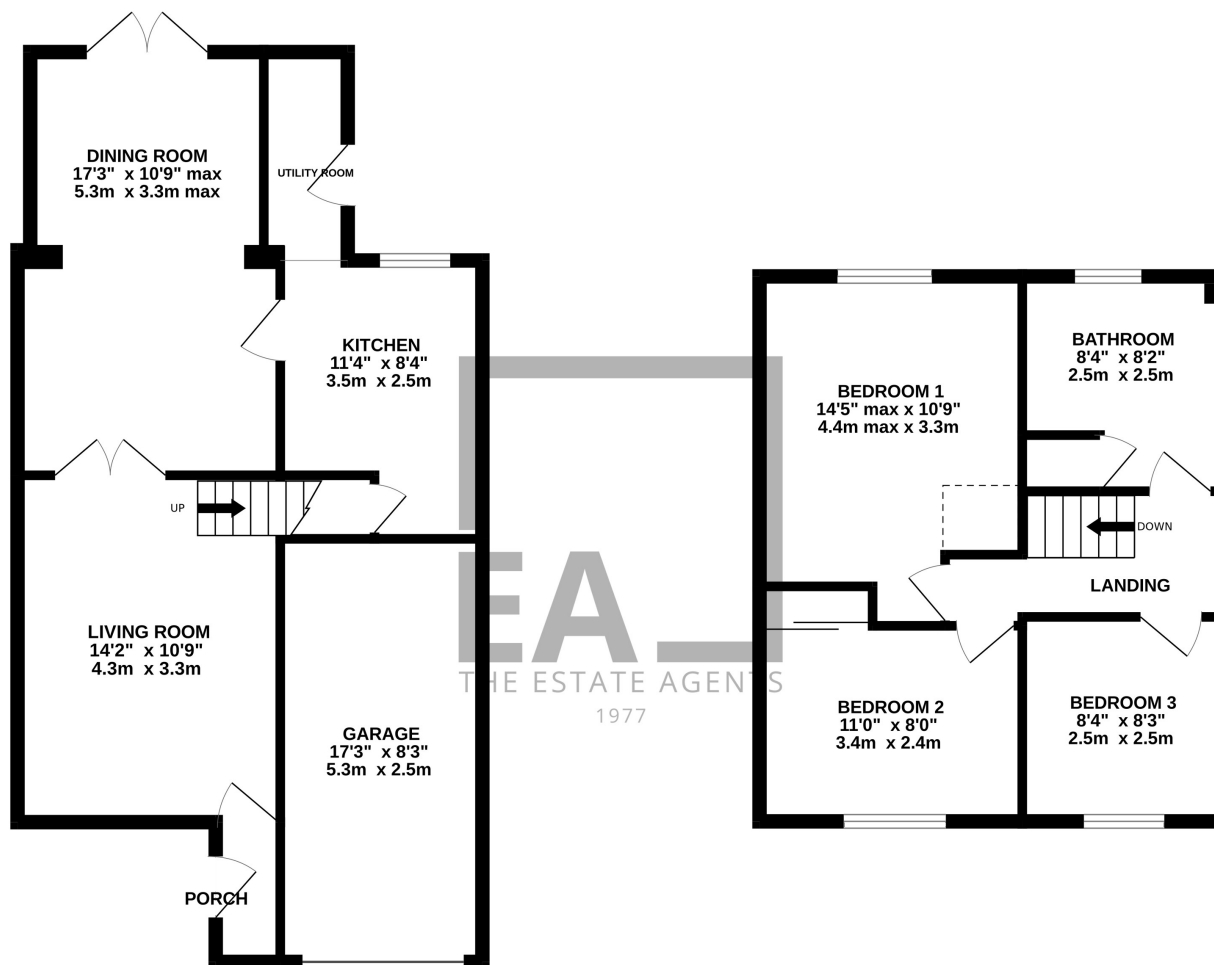

TOTAL FLOOR AREA : 1028 sq.ft. (95.5 sq.m.) approx.

Whilst every attempt has been made to ensure the accuracy of the floorplan contained here, measurements of doors, windows, rooms and any other items are approximate and no responsibility is taken for any error, omission or mis-statement. This plan is for illustrative purposes only and should be used as such by any prospective purchaser. The services, systems and appliances shown have not been tested and no guarantee as to their operability or efficiency can be given.  
Made with Metropix ©2025