



14 Elder Mead, The Street, Wallington, Baldock, Hertfordshire, SG7 6SW

Guide Price £400,000 Freehold







Step Inside

The Street



About Baldock

The Street

Via wooden front door. Two leaded windows to side aspect. Stairs and doors to:







Step Outside

The Street

Abt. 16' 6" x 13' 4" (5.03m x 4.06m) Windows to front, rear and side aspects. Parquet flooring. Original style beams. Inglenook fireplace with seating area.



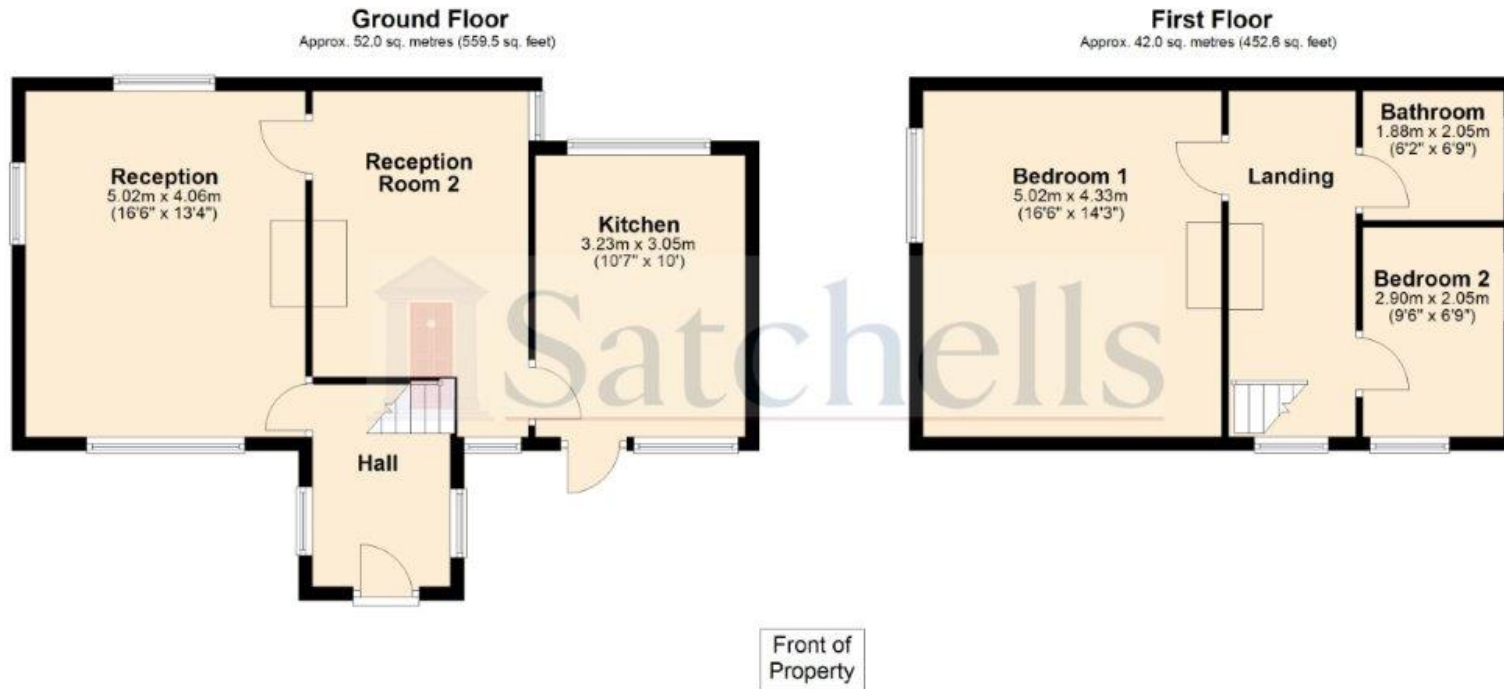

Total area: approx. 94.0 sq. metres (1012.1 sq. feet)

For illustrative purposes only - NOT TO SCALE - Measurements shown are approximate. The size and position of doors, windows, appliances and other features are approximate.
Plan produced using PlanUp.



These particulars are a guide only and do not constitute an offer or a contract. The floorplan is for general identification purposes only and not to scale. All measurements and areas quoted are approximate and should not be relied upon if ordering furniture, white goods or carpets. Satchells have not tested any appliances or carried out any surveys, and buyers are advised to make their own satisfactory enquires into the state and condition of the property, utility services and tenure. Some or all images may have been enhanced using Photoshop or similar and the contents shown may not be included in the sale. You are advised to confirm the availability of the property on the day of your viewing. Under current Anti Money Laundering regulations buyers will also be required to provide proof of ID and also proof of funding.



Satchells
8, High Street, Baldock, Hertfordshire, SG7 6AR
Tel: 01462 892041
E: baldock@satchells.co.uk www.satchells.com

