

Truuli



Streatham Vale, London, SW16 5SP

£600,000 Freehold

- Heavily extended to the rear
- Large shed in garden with electric
- Ground floor shower room and first floor shower room
- Close to Streatham common station
- Well maintained family home
- Large modern fitted kitchen
- Guide price £600,000 - £650,000

Southbridge Place, Surrey, CR0 4HA

Tel: 0330 043 0002

Email: save@truuli.co.uk Web: www.truuli.co.uk

Streatham Vale, London, SW16 5SP

£600,000 Freehold

*** Guide price £600,000 - £650,000 *** This spacious and well-maintained 1930s end-of-terrace house offers a perfect balance of practicality and comfort.

The ground floor features a bright, open-plan through reception room, ideal for both relaxing and entertaining, along with a generous kitchen breakfast room that's perfect for family meals. Completing the ground floor is a convenient utility area and a modern shower room.

Upstairs, you'll find three generously sized bedrooms and a well-presented family bathroom.

Streatham Vale

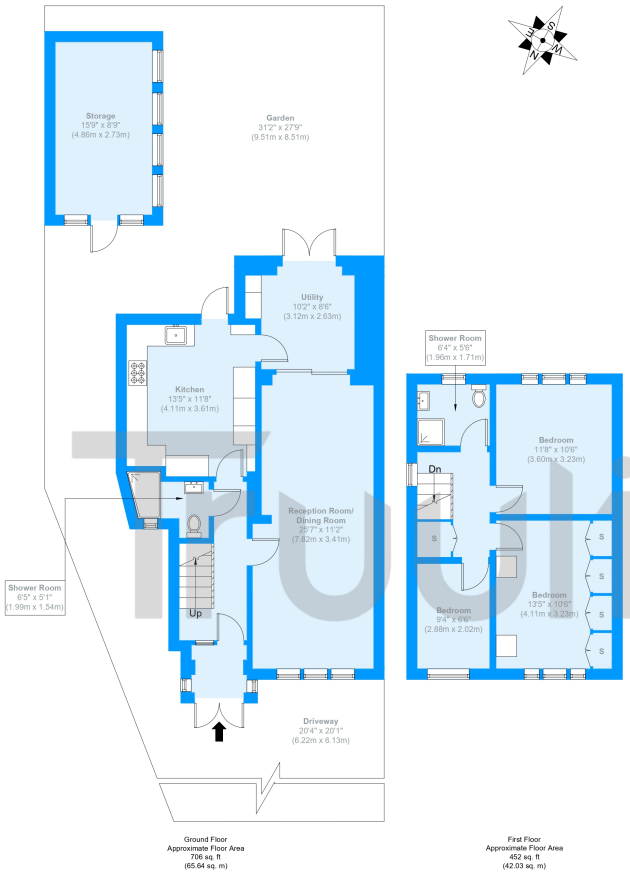

Approximate Gross Internal Area = 107.67 sq m / 1159 sq ft

Storage = 13.10 sq m / 141 sq ft

Total = 120.77 sq m / 1299 sq ft

The Floor plan is not to scale and measurements and areas shown are approximate and therefore should be used for illustrative purposes only. The plan has been prepared in accordance with the RICS code of Measuring Practice and whilst we have confidence in the information produced it must not be relied on. Maximum lengths and widths are represented on the floor plan. If there is any aspect of particular importance, you should carry out or commission your own inspection of the property.
Copyright © BleuPlan

| Energy Efficiency Rating | | |
|---------------------------------------------|-------------------------|-----------|
| | Current | Potential |
| Very energy efficient - lower running costs | | |
| (92+) | | |
| A | | |
| (81-91) | | |
| B | | |
| (69-80) | | |
| C | | |
| (55-68) | | |
| D | | |
| (39-54) | | |
| E | | |
| (21-38) | | |
| F | | |
| (1-20) | | |
| G | | |
| Not energy efficient - higher running costs | | |
| | 60 | 84 |
| England, Scotland & Wales | EU Directive 2002/91/EC | |

